

3.2 EPIC® D A - V I N C I H - B

Gehäuse / Hood / Capot

Solide Bauform und ein umfangreiches Programm an passenden Einsätzen sind die markanten Merkmale dieses Gehäuses. Diese Bauform lässt sich aus dem Industriestandard nicht mehr wegdenken. Die Gehäuse der H-B Serie gibt es in sechs verschiedenen Gehäusegrößen.

The striking characteristics of these mount bases are a sturdy construction and a comprehensive range of corresponding inserts. This style is used in all industrial applications. The H-B series housings are available in six different sizes.

Une forme de construction solide et un programme important d'inserts adéquats sont les caractéristiques marquantes de ce boîtier. Cette forme de construction est devenue indispensable au standard industriel. Les boîtiers de la série H-B sont disponibles en six tailles différentes.

3



3.2 EPIC® D A - V I N C I H - B

Gehäuse / Hood / Capot

Technische Daten:

Vorschriften: DIN 43652

Schutzart: IP 65

Werkstoff: H-B 6 – 48: Aluminiumlegierung, pulverbeschichtet

Technical Data

Specifications: DIN 43652

Protection class: IP 65

Material: H-B 6 – 48: aluminium alloy, powder coated

Caractéristiques techniques

Règlements: DIN 43652

Degré de protection: IP 65

Matière: H-B 6 – 48: Alliage aluminium, recouvert par pulvérisation

3.2 EPIC® D A - V I N C I H - B

Gehäuse / Hood / Capot



PG

M

EPIC® Standardgehäuse

Aluminiumlegierung, pulverbeschichtet (grau), Bügel und Bolzen aus verzinktem Stahl

Aluminium alloy, powder coated (grey), locking levers and bolts made of zinc plated steel

Alliage aluminium, recouvert par pulvérisation (grise), leviers et ergots acier recouvert par zinc

Für den industriellen Einsatz in anspruchsvoller Umgebung.
For industrial applications in demanding environments.

Pour une exploitation industrielle dans un environnement exigeant.

Entsprechend DIN EN 50262; auch in metrischer Ausführung mit M20-, M25-, M32- und M40-Gewinde.

According to DIN EN 50262; also available with metric thread M20, M25, M32 and M40.

Selon DIN EN 50262; maintenant aussi disponible avec pas métrique M20, M25, M32 et M40.



PG

M

EPIC® EP: (Environmental Protected/für erhöhte Umwelтанforderungen)

Aluminiumlegierung, pulverbeschichtet (schwarz), Bügel und Bolzen aus Edelstahl

Aluminium alloy, powder coated (black), locking levers and bolts made of stainless steel

Alliage aluminium, recouvert par pulvérisation (noir), leviers et ergots acier inox

Für den industriellen Einsatz in stark beanspruchter Umgebung mit aggressiver Atmosphäre.

For industrial applications in extremely demanding environments with aggressive atmospheres.

Pour l'exploitation industrielle dans un environnement très sollicité à atmosphère agressive.

Entsprechend DIN EN 50262; auch in metrischer Ausführung mit M20-, M25-, M32 und M40-Gewinde.

According to DIN EN 50262; now also available with metric thread M20, M25, M32 and M40.

Selon DIN EN 50262; maintenant aussi disponible avec pas métrique M20, M25, M32 et M40.

**Auf Anfrage
On request
sur demande**

3.2 EPIC® D A - V I N C I H - B

Gehäuse / Hood / Capot

VERGLEICH DER KLEMMBEREICHE FÜR EINSCHNITTDICHTUNGEN PG (DIN 46320) ZU METRISCH Comparison of the thread dimensions for split seals PG thread (DIN 46320)/ metric thread Comparaison de la dimension du filetage pour joints multiples pas PG (DIN 46320)/pas métrique

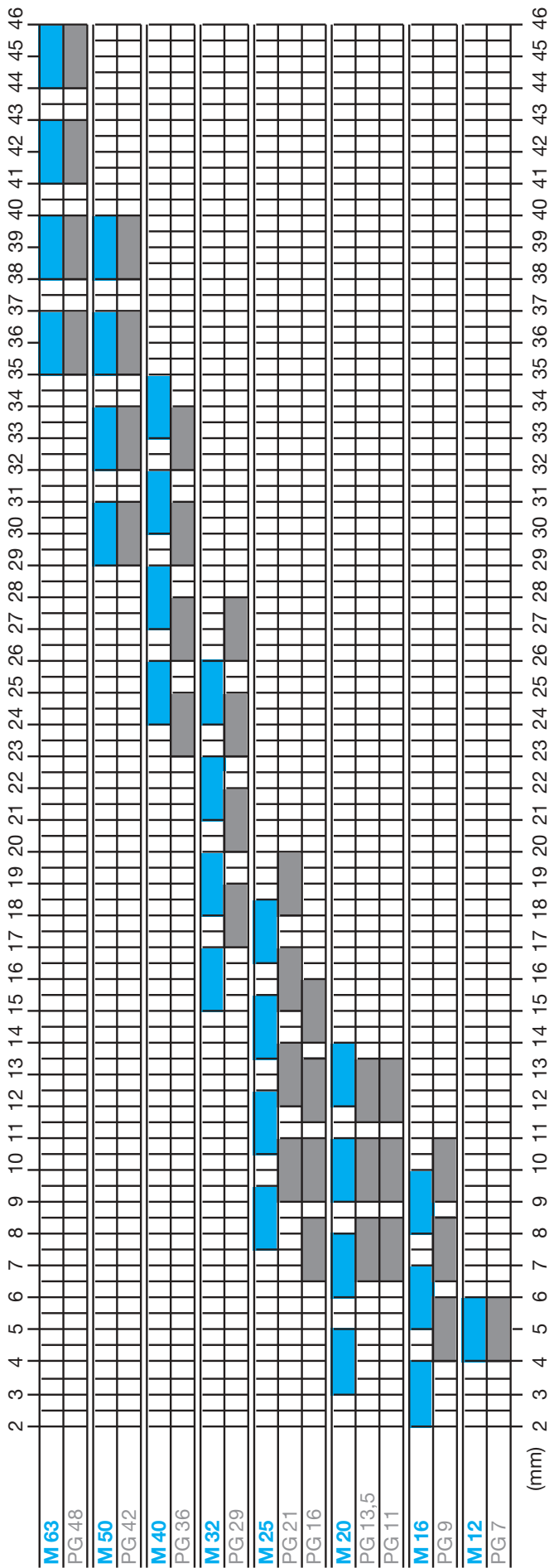

3.2 EPIC® D A - V I N C I H - B

Gehäuse / Hood / Capot



PG



M

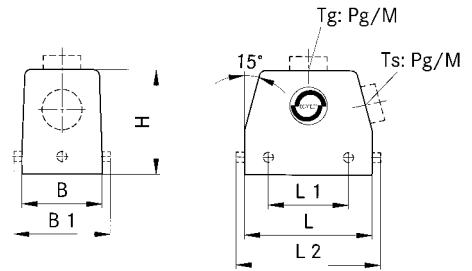

EPIC® H-B Gehäuse: Tüllengehäuse (Kabeleingang gerade, Bolzen für Längsbügel)

EPIC® H-B housings: hood (top entry, bolts for single locking lever)

Boîtiers EPIC® H-B: capot (sortie verticale, ergots pour simple levier)

H-B 6

| Artikel part article | Art.Nr. part No. N° art. | PG | M | ZW | L | L1 | L2 | L3 | L4 | B | B1 | B2 | B3 | B4 | B5 | H | H1 | H2 | S | d |
|----------------------------|--------------------------------|------|----|----|------|----|----|----|----|----|----|----|----|----|----|----|----|----|---|---|
| H-B 6 TG 13,5 | 10011000 | 13,5 | ● | 60 | 74,8 | | | | | 43 | | | | 45 | | 52 | | | | |
| H-B 6 TG 16 | 10021000 | 16 | ● | 60 | 74,8 | | | | | 43 | | | | 45 | | 52 | | | | |
| H-B 6 TG M20 | 19011000 | | 20 | 60 | 74,8 | | | | | 43 | | | | | | 52 | | | | |
| H-B 6 TG M25 | 19021000 | | 25 | 60 | 74,8 | | | | | 43 | | | | | | 52 | | | | |

Einsätze / Inserts / Inserts: 1.4: H-BE 6 / 1.5: H-EE 10 / 1.9: H-DD 24 / 1.10: MC 6

Deckel / Cover / Couvercle: 6.1: H-BE 6

Kabelverschraubung / Cable gland / Presse-étoupe: 5.1: Metr. & PG

H-B 10

| Artikel part article | Art.Nr. part No. N° art. | PG | M | ZW | L | L1 | L2 | L3 | L4 | B | B1 | B2 | B3 | B4 | B5 | H | H1 | H2 | S | d |
|----------------------------|--------------------------------|----|----|----|----|----|----|----|----|----|----|----|----|----|----|----|----|----|---|---|
| H-B 10 TG-RO 16 | 10040900 | 16 | ● | 73 | 90 | | | | | 43 | | | | 45 | | 52 | | | | |
| H-B 10 TG-RO 21 | 10040700 | 21 | ● | 73 | 90 | | | | | 43 | | | | 45 | | 52 | | | | |
| H-B 10 TG-RO M20 | 19040900 | | 20 | 73 | 90 | | | | | 43 | | | | 45 | | 52 | | | | |
| H-B 10 TG-RO M25 | 19040700 | | 25 | 73 | 90 | | | | | 43 | | | | 45 | | 52 | | | | |

Einsätze / Inserts / Inserts: 1.4: H-BE 10 / 1.5: H-EE 18 / 1.7: H-BVE 3 / 1.9: H-DD 42 / 1.10: MC 10

Kabelverschraubung / Cable gland / Presse-étoupe: 5.1: Metr. & PG



PG



M

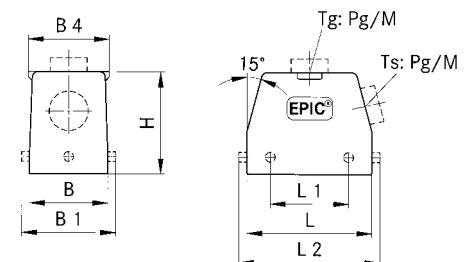

H-B 16

| Artikel part article | Art.Nr. part No. N° art. | PG | M | ZW | L | L1 | L2 | L3 | L4 | B | B1 | B2 | B3 | B4 | B5 | H | H1 | H2 | S | d |
|----------------------------|--------------------------------|----|----|------|-----|----|----|----|----|----|----|----|----|----|----|----|----|----|---|---|
| H-B 16 TG-RO 21 | 10080900 | 21 | ● | 93,3 | 110 | | | | | 43 | | | | | | 61 | | | | |
| H-B 16 TG-RO M25 | 19080900 | | 25 | 93,3 | 110 | | | | | 43 | | | | | | 61 | | | | |

Einsätze / Inserts / Inserts: 1.4: H-BE 16 / 1.5: H-EE 32 / 1.6: H-BS 6 / 1.7: H-BVE 6 / 1.8: H-D 40 / 1.9: H-DD 72 / 1.10: MC 16

Kabelverschraubung / Cable gland / Presse-étoupe: 5.1: Metr. & PG

3.2 EPIC® D A - V I N C I H - B

Gehäuse / Hood / Capot



PG



M

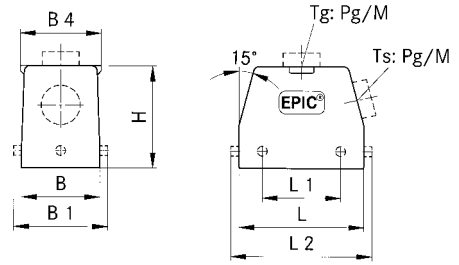

EPIC® H-B Gehäuse: Tüllengehäuse (Kabeleingang gerade, Bolzen für Längsbügel)

EPIC® H-B housings: hood (top entry, bolts for single locking lever)

Boîtiers EPIC® H-B: capot (sortie verticale, ergots pour simple levier)

H-B 24

| Artikel part article | Art.Nr. part No. N° art. | PG | M | ZW | L | L1 | L2 | L3 | L4 | B | B1 | B2 | B3 | B4 | B5 | H | H1 | H2 | S | d |
|----------------------------|--------------------------------|----|----|----|-----|-----|----|----|----|----|----|----|----|----|----|----|----|----|---|---|
| H-B 24 TG-RO 21 | 10121900 | 21 | | ● | 120 | 137 | | | | 43 | | | | 45 | | 61 | | | | |
| H-B 24 TG-RO 29 | 10111900 | 29 | | ● | | | | | | | | | | | | | | | | |
| H-B 24 TG-RO M25 | 19121900 | | 25 | | 120 | 137 | | | | 43 | | | | 45 | | 61 | | | | |
| H-B 24 TG-RO M32 | 19111900 | | 32 | | | | | | | | | | | | | | | | | |

Einsätze / Inserts / Inserts: 1.4: H-BE 48 / 1.5: H-EE 46 / 1.7: H-BVE 10 / 1.8: H-D 64 / 1.9: H-DD 108 / 1.10: MC 24

Kabelverschraubung / Cable gland / Presse-étoupe: 5.1: Metr. & PG

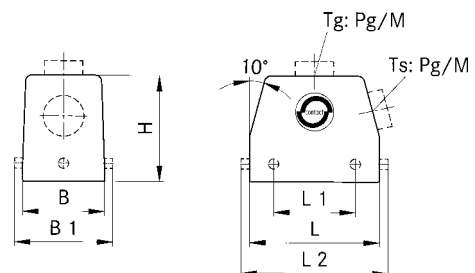

H-B 48

| Artikel part article | Art.Nr. part No. N° art. | PG | M | ZW | L | L1 | L2 | L3 | L4 | B | B1 | B2 | B3 | B4 | B5 | H | H1 | H2 | S | d |
|----------------------------|--------------------------------|----|----|----|-----|-----|----|----|----|----|----|----|----|----|----|-----|----|----|---|---|
| H-B 48 TG 29 | 10155000 | 29 | | ● | | | | | | | | | | | | | | | | |
| H-B 48 TG 36 | 10156000 | 36 | | ● | 132 | 152 | | | | 90 | | | | 45 | | 105 | | | | |
| H-B 48 TG 36 | 10156200 | 36 | | | | | | | | | | | | | | | | | | |
| H-B 48 TG 42 | 10157000 | 42 | | | | | | | | | | | | | | | | | | |
| H-B 48 TG M32 | 19155000 | | 32 | | | | | | | | | | | | | | | | | |
| H-B 48 TG M40 | 19156000 | | 40 | | 132 | 152 | | | | 90 | | | | 45 | | 105 | | | | |
| H-B 48 TG M50 | 19157000 | | 50 | | | | | | | | | | | | | | | | | |

Einsätze / Inserts / Inserts: 1.4: H-BE 48 / 1.5: H-EE 92 / 1.7: 2 x H-BVE 10 / 1.8: H-D 128 / 1.9: H-DD 216 / 1.10: 2 x MC 24

Kabelverschraubung / Cable gland / Presse-étoupe: 5.1: Metr. & PG

3.2 EPIC® D A - V I N C I H - B

Gehäuse / Hood / Capot



PG



M

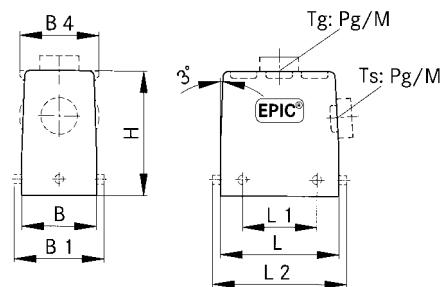

EPIC® H-B Gehäuse: Tüllengehäuse (Kabeleingang gerade, Bolzen für Längsbügel, hohe Bauform)

EPIC® H-B housings: hood (top entry, bolts for single locking lever, high version)

Boîtiers EPIC® H-B: capot (sortie verticale, ergots pour simple levier, version haute)

H-B 6

| Artikel part article | Art.Nr. part No. N° art. | PG | M | ZW | L | L1 | L2 | L3 | L4 | B | B1 | B2 | B3 | B4 | B5 | H | H1 | H2 | S | d |
|----------------------------|--------------------------------|----|----|----|----|----|------|----|----|----|----|----|----|----|----|----|----|----|---|---|
| H-B 6 TGH 21 | 70020200 | 21 | | ● | 60 | | 74,8 | | | 43 | | | | 45 | | 72 | | | | |
| H-B 6 TGH 29 | 70020400 | 29 | | ● | | | | | | | | | | | | | | | | |
| H-B 6 TGH M25 | 79020200 | | 25 | | 60 | | 74,8 | | | 43 | | | | | | 72 | | | | |
| H-B 6 TGH M32 | 79020400 | | 32 | | | | | | | | | | | | | | | | | |

Einsätze / Inserts / Inserts: 1.4: H-BE 6 / 1.5: H-EE 10 / 1.9: H-DD 24 / 1.10: MC 6

Deckel / Cover / Couvercle: 6.1: H-B 6

Kabelverschraubung / Cable gland / Presse-étoupe: 5.1: Metr. & PG

H-B 10

| Artikel part article | Art.Nr. part No. N° art. | PG | M | ZW | L | L1 | L2 | L3 | L4 | B | B1 | B2 | B3 | B4 | B5 | H | H1 | H2 | S | d |
|----------------------------|--------------------------------|----|----|----|----|----|----|----|----|----|----|----|----|----|----|----|----|----|---|---|
| H-B 10 TGH-RO 21 | 70044200 | 21 | | ● | 73 | | 90 | | | 43 | | | | 45 | | 72 | | | | |
| H-B 10 TGH-RO 29 | 70044400 | 29 | | ● | | | | | | | | | | | | | | | | |
| H-B 10 TGH-RO M25 | 79044200 | | 25 | | 73 | | 90 | | | 43 | | | | 45 | | 72 | | | | |
| H-B 10 TGH-RO M32 | 79044400 | | 32 | | | | | | | | | | | | | | | | | |

Einsätze / Inserts / Inserts: 1.4: H-BE 10 / 1.5: H-EE 18 / 1.7: H-BVE 3 / 1.9: H-DD 42 / 1.10: MC 10

Kabelverschraubung / Cable gland / Presse-étoupe: 5.1: Metr. & PG

3.2 EPIC® D A - V I N C I H - B

Gehäuse / Hood / Capot



PG



M

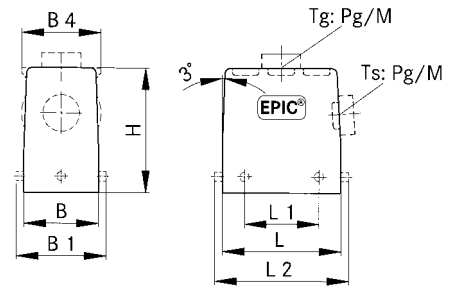

EPIC® H-B Gehäuse: Tüllengehäuse (Kabeleingang gerade, Bolzen für Längsbügel, hohe Bauform)

EPIC® H-B housings: hood (top entry, bolts for single locking lever, high version)

Boîtiers EPIC® H-B: capot (sortie verticale, ergots pour simple levier, version haute)

H-B 16

| Artikel part article | Art.Nr. part No. N° art. | PG | M | ZW | L | L1 | L2 | L3 | L4 | B | B1 | B2 | B3 | B4 | B5 | H | H1 | H2 | S | d |
|----------------------------|--------------------------------|----|----|----|------|----|-----|----|----|----|----|----|----|----|----|----|----|----|---|---|
| H-B 16 TGH-RO 21 | 70094200 | 21 | | ● | 93,3 | | 110 | | | 43 | | | | 45 | | 76 | | | | |
| H-B 16 TGH-RO 29 | 70094400 | 29 | | ● | | | | | | | | | | | | | | | | |
| H-B 16 TGH-RO M25 | 79094200 | | 25 | | | | | | | | | | | | | | | | | |
| H-B 16 TGH-RO M32 | 79094400 | | 32 | | 93,3 | | 110 | | | 43 | | | | 45 | | 76 | | | | |
| H-B 16 TGH-RO M40 | 79094600 | | 40 | | | | | | | | | | | | | | | | | |

Einsätze / Inserts / Inserts: 1.4: H-BE 16 / 1.5: H-EE 32 / 1.6: H-BS 6 / 1.7: H-BVE 6 / 1.8: H-D 40 / 1.9: H-DD 72 / 1.10: MC 16
Kabelverschraubung / Cable gland / Presse-étoupe: 5.1: Metr. & PG

H-B 24

| Artikel part article | Art.Nr. part No. N° art. | PG | M | ZW | L | L1 | L2 | L3 | L4 | B | B1 | B2 | B3 | B4 | B5 | H | H1 | H2 | S | d |
|----------------------------|--------------------------------|----|----|----|-----|----|-----|----|----|----|----|----|----|----|----|----|----|----|---|---|
| H-B 24 TGH-RO 21 | 70144400 | 21 | | ● | 120 | | 137 | | | 43 | | | | 45 | | 76 | | | | |
| H-B 24 TGH-RO 29 | 70144600 | 29 | | ● | | | | | | | | | | | | | | | | |
| H-B 24 TGH-RO M25 | 79144400 | | 25 | | | | | | | | | | | | | | | | | |
| H-B 24 TGH-RO M32 | 79144600 | | 32 | | 120 | | 137 | | | 43 | | | | 45 | | 76 | | | | |
| H-B 24 TGH-RO M40 | 79144800 | | 40 | | | | | | | | | | | | | | | | | |

Einsätze / Inserts / Inserts: 1.4: H-BE 24 / 1.5: H-EE 46 / 1.7: H-BVE 10 / 1.8: H-D 64 / 1.9: H-DD 108 / 1.10: MC 24
Kabelverschraubung / Cable gland / Presse-étoupe: 5.1: Metr. & PG

3.2 EPIC® D A - V I N C I H - B

Gehäuse / Hood / Capot



PG / M

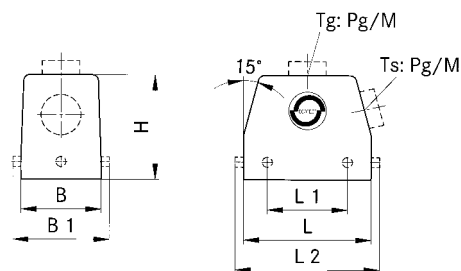

EPIC® H-B Gehäuse: Tüllengehäuse (Kabeleingang seitlich, Bolzen für Längsbügel)

EPIC® H-B housings: hood (side entry, bolts for single locking lever)

Boîtiers EPIC® H-B: capot (sortie latérale, ergots pour simple levier)

H-B 6

| Artikel part article | Art.Nr. part No. N° art. | PG | M | ZW | L | L1 | L2 | L3 | L4 | B | B1 | B2 | B3 | B4 | B5 | H | H1 | H2 | S | d |
|----------------------------|--------------------------------|------|----|----|----|----|------|----|----|----|----|----|----|----|----|----|----|----|---|---|
| H-B 6 TS 13,5 | 10012000 | 13,5 | | ● | 60 | | 74,8 | | | 43 | | | | | | 52 | | | | |
| H-B 6 TS 16 | 10022000 | 16 | | ● | | | | | | | | | | | | | | | | |
| H-B 6 TS M20 | 19012000 | | 20 | ● | 60 | | 74,8 | | | 43 | | | | | | 52 | | | | |
| H-B 6 TS M25 | 19022000 | | 25 | ● | | | | | | | | | | | | | | | | |

Einsätze / Inserts / Inserts: 1.4: H-BE 6 / 1.5: H-EE 10 / 1.9: H-DD 24 / 1.10: MC 6

Deckel / Cover / Couvercle: 6.1: H-B 6

Kabelverschraubung / Cable gland / Presse-étoupe: 5.1: Metr. & PG

H-B 10

| Artikel part article | Art.Nr. part No. N° art. | PG | M | ZW | L | L1 | L2 | L3 | L4 | B | B1 | B2 | B3 | B4 | B5 | H | H1 | H2 | S | d |
|----------------------------|--------------------------------|----|----|----|----|----|----|----|----|----|----|----|----|----|----|----|----|----|---|---|
| H-B 10 TS-RO 16 | 10042900 | 16 | | ● | 73 | | 90 | | | 43 | | | | | | 52 | | | | |
| H-B 10 TS-RO 21 | 10042800 | 21 | | ● | | | | | | | | | | | | | | | | |
| H-B 10 TS-RO M20 | 19042900 | | 20 | ● | 73 | | 90 | | | 43 | | | | | | 52 | | | | |
| H-B 10 TS-RO M25 | 19042800 | | 25 | ● | | | | | | | | | | | | | | | | |

Einsätze / Inserts / Inserts: 1.4: H-BE 10 / 1.5: H-EE 18 / 1.7: H-BVE 3 / 1.9: H-DD 42 / 1.10: MC 10

Kabelverschraubung / Cable gland / Presse-étoupe: 5.1: Metr. & PG



PG / M

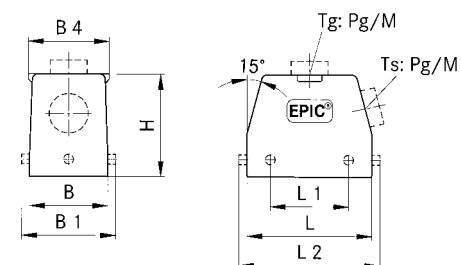

H-B 16

| Artikel part article | Art.Nr. part No. N° art. | PG | M | ZW | L | L1 | L2 | L3 | L4 | B | B1 | B2 | B3 | B4 | B5 | H | H1 | H2 | S | d |
|----------------------------|--------------------------------|----|----|----|------|----|-----|----|----|----|----|----|----|----|----|----|----|----|---|---|
| H-B 16 TS-RO 21 | 10082900 | 21 | | ● | 93,3 | | 110 | | | 43 | | | | 45 | | 61 | | | | |
| H-B 16 TS-RO 29 | 10092900 | 29 | | ● | | | | | | | | | | | | | | | | |
| H-B 16 TS-RO M25 | 19082900 | | 25 | ● | 93,3 | | 110 | | | 43 | | | | 45 | | 61 | | | | |
| H-B 16 TS-RO M32 | 19092900 | | 32 | ● | | | | | | | | | | | | | | | | |

Einsätze / Inserts / Inserts: 1.4: H-BE 16 / 1.5: H-EE 32 / 1.6: H-BS 6 / 1.7: H-BVE 6 / 1.8: H-D 40 / 1.9: H-DD 72 / 1.10: MC 16

Kabelverschraubung / Cable gland / Presse-étoupe: 5.1: Metr. & PG

3.2 EPIC® D A - V I N C I H - B

Gehäuse / Hood / Capot



PG / M

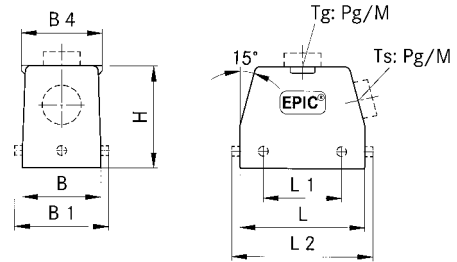

EPIC® H-B Gehäuse: Tüllengehäuse (Kabeleingang seitlich, Bolzen für Längsbügel)

EPIC® H-B housings: hood (side entry, bolts for single locking lever)

Boîtiers EPIC® H-B: capot (sortie latérale, ergots pour simple levier)

H-B 24

| Artikel part article | Art.Nr. part No. N° art. | PG | M | ZW | L | L1 | L2 | L3 | L4 | B | B1 | B2 | B3 | B4 | B5 | H | H1 | H2 | S | d |
|----------------------------|--------------------------------|----|----|----|-----|----|-----|----|----|----|----|----|----|----|----|----|----|----|---|---|
| H-B 24 TS-RO 21 | 10113900 | 21 | | ● | 120 | | 137 | | | 43 | | | | 45 | | 61 | | | | |
| H-B 24 TS-RO 29 | 10123900 | 29 | | ● | | | | | | | | | | | | | | | | |
| H-B 24 TS-RO M25 | 19113900 | | 25 | ● | 120 | | 137 | | | 43 | | | | 45 | | 61 | | | | |
| H-B 24 TS-RO M32 | 19123900 | | 32 | ● | | | | | | | | | | | | | | | | |

Einsätze / Inserts / Inserts: 1.4: H-BE 24 / 1.5: H-EE 46 / 1.7: H-BVE 10 / 1.8: H-D 64 / 1.9: H-DD 108 / 1.10: MC 24

Kabelverschraubung / Cable gland / Presse-étoupe: 5.1: Metr. & PG



PG



M

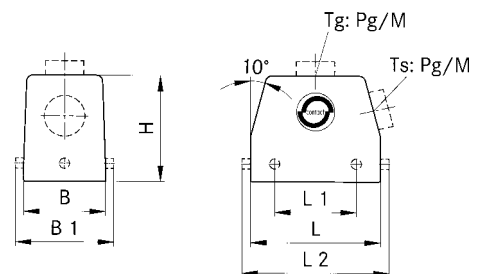

EPIC® H-B Gehäuse: Tüllengehäuse (Kabeleingang seitlich, Bolzen für Längsbügel)

EPIC® H-B housings: hood (side entry, bolts for single locking lever)

Boîtiers EPIC® H-B: capot (sortie latérale, ergots pour simple levier)

H-B 48

| Artikel part article | Art.Nr. part No. N° art. | PG | M | ZW | L | L1 | L2 | L3 | L4 | B | B1 | B2 | B3 | B4 | B5 | H | H1 | H2 | S | d |
|----------------------------|--------------------------------|----|----|----|-----|----|-----|----|----|----|----|----|----|----|----|-----|----|----|---|---|
| H-B 48 TS 29 | 10158000 | 29 | | ● | | | | | | | | | | | | | | | | |
| H-B 48 TS 36 | 10159000 | 36 | | ● | 132 | | 152 | | | 90 | | | | | | 105 | | | | |
| H-B 48 TS 36 | 10159200 | 36 | | | | | | | | | | | | | | | | | | |
| H-B 48 TS 42 | 10160000 | 42 | | ● | | | | | | | | | | | | | | | | |
| H-B 48 TS M32 | 19158000 | | 32 | | | | | | | | | | | | | | | | | |
| H-B 48 TS M40 | 19159000 | | 40 | | 132 | | 152 | | | 90 | | | | | | 105 | | | | |
| H-B 48 TS M50 | 19160000 | | 50 | | | | | | | | | | | | | | | | | |

Einsätze / Inserts / Inserts: 1.4: H-BE 48 / 1.5: H-EE 92 / 1.7: 2 x H-BVE 10 / 1.8: H-D 128 / 1.9: H-DD 216 / 1.10: 2 x MC 24

Kabelverschraubung / Cable gland / Presse-étoupe: 5.1: Metr. & PG

3.2 EPIC® D A - V I N C I H - B

Gehäuse / Hood / Capot



PG



M

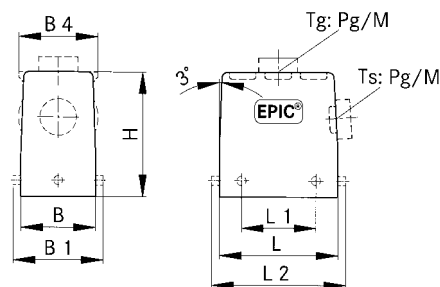

EPIC® H-B Gehäuse: Tüllengehäuse (Kabeleingang seitlich, Bolzen für Längsbügel, hohe Bauform)
EPIC® H-B housings: hood (side entry, bolts for single locking lever, high version)
Boîtiers EPIC® H-B: capot (sortie latérale, ergots pour simple levier, version haute)

H-B 6

| Artikel part article | Art.Nr. part No. N° art. | PG | M | ZW | L | L1 | L2 | L3 | L4 | B | B1 | B2 | B3 | B4 | B5 | H | H1 | H2 | S | d |
|----------------------------|--------------------------------|----|----|----|----|----|------|----|----|----|----|----|----|----|----|----|----|----|---|---|
| H-B 6 TSH 21 | 70022200 | 21 | | ● | 60 | | 74,8 | | | 43 | | | | 45 | | 72 | | | | |
| H-B 6 TSH 29 | 70022400 | 29 | | ● | | | | | | | | | | | | | | | | |
| H-B 6 TSH M25 | 79022200 | | 25 | | 60 | | 74,8 | | | 43 | | | | 45 | | 72 | | | | |
| H-B 6 TSH M32 | 79022400 | | 32 | | | | | | | | | | | | | | | | | |

Einsätze / Inserts / Inserts: 1.4: H-BE 6 / 1.5: H-EE 10 / 1.9: H-DD 24 / 1.10: MC 6

Deckel / Cover / Couvercle: 6.1: H-B 6

Kabelverschraubung / Cable gland / Presse-étoupe: 5.1: Metr. & PG

H-B 10

| Artikel part article | Art.Nr. part No. N° art. | PG | M | ZW | L | L1 | L2 | L3 | L4 | B | B1 | B2 | B3 | B4 | B5 | H | H1 | H2 | S | d |
|----------------------------|--------------------------------|----|----|----|----|----|----|----|----|----|----|----|----|----|----|----|----|----|---|---|
| H-B 10 TSH-RO 21 | 70054200 | 21 | | ● | 73 | | 90 | | | 43 | | | | 45 | | 72 | | | | |
| H-B 10 TSH-RO 29 | 70054400 | 29 | | ● | | | | | | | | | | | | | | | | |
| H-B 10 TSH-RO M25 | 79054200 | | 25 | | 73 | | 90 | | | 43 | | | | 45 | | 72 | | | | |
| H-B 10 TSH-RO M32 | 79054400 | | 32 | | | | | | | | | | | | | | | | | |

Einsätze / Inserts / Inserts: 1.4: H-BE 10 / 1.5: H-EE 10 / 1.7: H-BVE 3 / 1.9: H-DD 42 / 1.10: MC 10

Kabelverschraubung / Cable gland / Presse-étoupe: 5.1: Metr. & PG

H-B 16

| Artikel part article | Art.Nr. part No. N° art. | PG | M | ZW | L | L1 | L2 | L3 | L4 | B | B1 | B2 | B3 | B4 | B5 | H | H1 | H2 | S | d |
|----------------------------|--------------------------------|----|----|----|------|----|-----|----|----|----|----|----|----|----|----|----|----|----|---|---|
| H-B 16 TSH-RO 21 | 70104200 | 21 | | ● | 93,3 | | 110 | | | 43 | | | | 45 | | 76 | | | | |
| H-B 16 TSH-RO 29 | 70104400 | 29 | | ● | | | | | | | | | | | | | | | | |
| H-B 16 TSH-RO M25 | 79104200 | | 25 | | | | | | | | | | | | | | | | | |
| H-B 16 TSH-RO M32 | 79104400 | | 32 | | 93,3 | | 110 | | | 43 | | | | 45 | | 76 | | | | |
| H-B 16 TSH-RO M40 | 79104800 | | 40 | | | | | | | | | | | | | | | | | |

Einsätze / Inserts / Inserts: 1.4: H-BE 16 / 1.5: H-EE 32 / 1.6: H-BS 6 / 1.7: H-BVE 6 / 1.8: H-D 40 / 1.9: H-DD 72 / 1.10: MC 16

Kabelverschraubung / Cable gland / Presse-étoupe: 5.1: Metr. & PG

H-B 24

| Artikel part article | Art.Nr. part No. N° art. | PG | M | ZW | L | L1 | L2 | L3 | L4 | B | B1 | B2 | B3 | B4 | B5 | H | H1 | H2 | S | d |
|----------------------------|--------------------------------|----|----|----|-----|----|-----|----|----|----|----|----|----|----|----|----|----|----|---|---|
| H-B 24 TSH-RO 21 | 70154400 | 21 | | ● | 120 | | 137 | | | 43 | | | | 45 | | 76 | | | | |
| H-B 24 TSH-RO 29 | 70154600 | 29 | | ● | | | | | | | | | | | | | | | | |
| H-B 24 TSH-RO M25 | 79154400 | | 25 | | | | | | | | | | | | | | | | | |
| H-B 24 TSH-RO M32 | 79154600 | | 32 | | 120 | | 137 | | | 43 | | | | 45 | | 76 | | | | |
| H-B 24 TSH-RO M40 | 79154800 | | 40 | | | | | | | | | | | | | | | | | |

Einsätze / Inserts / Inserts: 1.4: H-BE 24 / 1.5: H-EE 46 / 1.7: H-BVE 10 / 1.8: H-D 64 / 1.9: H-DD 108 / 1.10: MC 24

Kabelverschraubung / Cable gland / Presse-étoupe: 5.1: Metr. & PG

3.2 EPIC® D A - V I N C I H - B

Gehäuse / Hood / Capot



PG



M

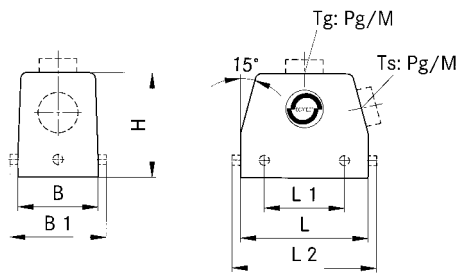

EPIC® H-B Gehäuse: Tüllengehäuse (Kabeleingang gerade, Bolzen für Querbügel)

EPIC® H-B housings: hood (top entry, bolts for double locking lever)

Boîtiers EPIC® H-B: capot (sortie verticale, ergots pour double levier)

H-B 10

| Artikel part article | Art.Nr. part No. N° art. | PG | M | ZW | L | L1 | L2 | L3 | L4 | B | B1 | B2 | B3 | B4 | B5 | H | H1 | H2 | S | d |
|----------------------------|--------------------------------|----|----|----|----|----|----|----|----|----|------|----|----|----|----|----|----|----|---|---|
| H-B 10 TG 16 | 10040000 | 16 | | ● | 73 | 27 | | | | 43 | 57,8 | | | 45 | | 52 | | | | |
| H-B 10 TG 21 | 10040100 | 21 | | ● | | | | | | | | | | | | | | | | |
| H-B 10 TG M20 | 19040000 | | 20 | | 73 | 27 | | | | 43 | 57,8 | | | 45 | | 52 | | | | |
| H-B 10 TG M25 | 19040100 | | 25 | | | | | | | | | | | | | | | | | |

Einsätze / Inserts / Inserts: 1.4: H-BE 10 / 1.5: H-EE 18 / 1.7: H-BVE 3 / 1.9: H-DD 42 / 1.10: MC 10

Deckel / Cover / Couvercle: 6.1: H-B 10

Kabelverschraubung / Cable gland / Presse-étoupe: 5.1: Metr. & PG



PG



M

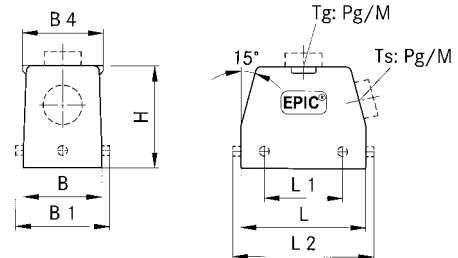

H-B 16

| Artikel part article | Art.Nr. part No. N° art. | PG | M | ZW | L | L1 | L2 | L3 | L4 | B | B1 | B2 | B3 | B4 | B5 | H | H1 | H2 | S | d |
|----------------------------|--------------------------------|----|----|----|------|------|----|----|----|----|------|----|----|----|----|----|----|----|---|---|
| H-B 16 TG 21 | 10080000 | 21 | | ● | 93,3 | 47,5 | | | | 43 | 57,8 | | | 45 | | 61 | | | | |
| H-B 16 TG 29 | 10090000 | 29 | | ● | | | | | | | | | | | | | | | | |
| H-B 16 TG M25 | 19080000 | | 25 | | 93,3 | 47,5 | | | | 43 | 57,8 | | | 45 | | 61 | | | | |
| H-B 16 TG M32 | 19090000 | | 32 | | | | | | | | | | | | | | | | | |

Einsätze / Inserts / Inserts: 1.4: H-BE 16 / 1.5: H-EE 32 / 1.6: H-BS 6 / 1.7: H-BVE 6 / 1.8: H-D 40 / 1.9: H-DD 72 / 1.10: MC 16

Deckel / Cover / Couvercle: 6.1: H-B 16

Kabelverschraubung / Cable gland / Presse-étoupe: 5.1: Metr. & PG

H-B 24

| Artikel part article | Art.Nr. part No. N° art. | PG | M | ZW | L | L1 | L2 | L3 | L4 | B | B1 | B2 | B3 | B4 | B5 | H | H1 | H2 | S | d |
|----------------------------|--------------------------------|----|----|----|-----|----|----|----|----|----|------|----|----|----|----|----|----|----|---|---|
| H-B 24 TG 21 | 10121000 | 21 | | ● | 120 | 74 | | | | 43 | 57,8 | | | 45 | | 61 | | | | |
| H-B 24 TG 29 | 10111000 | 29 | | ● | | | | | | | | | | | | | | | | |
| H-B 24 TG M25 | 19121000 | | 25 | | 120 | 74 | | | | 43 | 57,8 | | | 45 | | 61 | | | | |
| H-B 24 TG M32 | 19111000 | | 32 | | | | | | | | | | | | | | | | | |

Einsätze / Inserts / Inserts: 1.4: H-BE 24 / 1.5: H-EE 46 / 1.7: H-BVE 10 / 1.8: H-D 64 / 1.9: H-DD 108 / 1.10: MC 24

Deckel / Cover / Couvercle: 6.1: H-B 24

Kabelverschraubung / Cable gland / Presse-étoupe: 5.1: Metr. & PG

3.2 EPIC® D A - V I N C I H - B

Gehäuse / Hood / Capot



PG



M

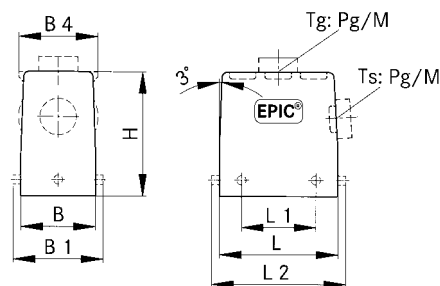

EPIC® H-B Gehäuse: Tüllengehäuse (Kabeleingang gerade, Bolzen für Querbügel, hohe Bauform)
EPIC® H-B housings: hood (top entry, bolts for double locking lever, high version)
Boîtiers EPIC® H-B: capot (sortie verticale, ergots pour double levier, version haute)

H-B 10

| Artikel part article | Art.Nr. part No. N° art. | PG | M | ZW | L | L1 | L2 | L3 | L4 | B | B1 | B2 | B3 | B4 | B5 | H | H1 | H2 | S | d |
|----------------------------|--------------------------------|----|----|----|----|----|----|----|----|----|------|----|----|----|----|----|----|----|---|---|
| H-B 10 TGH 21 | 70050400 | 21 | | ● | 73 | 27 | | | | 43 | 57,8 | | | 45 | | 72 | | | | |
| H-B 10 TGH 29 | 70050600 | 29 | | ● | | | | | | | | | | | | | | | | |
| H-B 10 TGH M25 | 79050400 | | 25 | | 73 | 27 | | | | 43 | 57,8 | | | 45 | | 72 | | | | |
| H-B 10 TGH M32 | 79050600 | | 32 | | | | | | | | | | | | | | | | | |

Einsätze / Inserts / Inserts: 1.4: H-BE 10 / 1.5: H-EE 18 / 1.7: H-BVE 3 / 1.9: H-DD 42 / 1.10: MC 10

Deckel / Cover / Couvercle: 6.1: H-B 10

Kabelverschraubung / Cable gland / Presse-étoupe: 5.1: Metr. & PG

H-B 16

| Artikel part article | Art.Nr. part No. N° art. | PG | M | ZW | L | L1 | L2 | L3 | L4 | B | B1 | B2 | B3 | B4 | B5 | H | H1 | H2 | S | d |
|----------------------------|--------------------------------|----|----|----|------|------|----|----|----|----|------|----|----|----|----|----|----|----|---|---|
| H-B 16 TGH 21 | 70100200 | 21 | | ● | 93,3 | 47,5 | | | | 43 | 57,8 | | | 45 | | 76 | | | | |
| H-B 16 TGH 29 | 70100400 | 29 | | ● | | | | | | | | | | | | | | | | |
| H-B 16 TGH M25 | 79100200 | | 25 | | | | | | | | | | | | | | | | | |
| H-B 16 TGH M32 | 79100400 | | 32 | | 93,3 | 47,5 | | | | 43 | 57,8 | | | 45 | | 76 | | | | |
| H-B 16 TGH M40 | 79100800 | | 40 | | | | | | | | | | | | | | | | | |

Einsätze / Inserts / Inserts: 1.4: H-BE 16 / 1.5: H-EE 32 / 1.6: H-BS 6 / 1.7: H-BVE 6 / 1.8: H-D 40 / 1.9: H-DD 72 / 1.10: MC 16

Deckel / Cover / Couvercle: 6.1: H-B 16

Kabelverschraubung / Cable gland / Presse-étoupe: 5.1: Metr. & PG

H-B 24

| Artikel part article | Art.Nr. part No. N° art. | PG | M | ZW | L | L1 | L2 | L3 | L4 | B | B1 | B2 | B3 | B4 | B5 | H | H1 | H2 | S | d |
|----------------------------|--------------------------------|----|----|----|-----|----|----|----|----|----|------|----|----|----|----|----|----|----|---|---|
| H-B 24 TGH 21 | 70150400 | 21 | | ● | 120 | 74 | | | | 43 | 57,8 | | | 45 | | 76 | | | | |
| H-B 24 TGH 29 | 70150600 | 29 | | ● | | | | | | | | | | | | | | | | |
| H-B 24 TGH M25 | 79150400 | | 25 | | | | | | | | | | | | | | | | | |
| H-B 24 TGH M32 | 79150600 | | 32 | | 120 | 74 | | | | 43 | 57,8 | | | 45 | | 76 | | | | |
| H-B 24 TGH M40 | 79150800 | | 40 | | | | | | | | | | | | | | | | | |

Einsätze / Inserts / Inserts: 1.4: H-BE 24 / 1.5: H-EE 46 / 1.7: H-BVE 10 / 1.8: H-D 64 / 1.9: H-DD 108 / 1.10: MC 24

Deckel / Cover / Couvercle: 6.1: H-B 24

Kabelverschraubung / Cable gland / Presse-étoupe: 5.1: Metr. & PG

3.2 EPIC® D A - V I N C I H - B

Gehäuse / Hood / Capot



PG



M

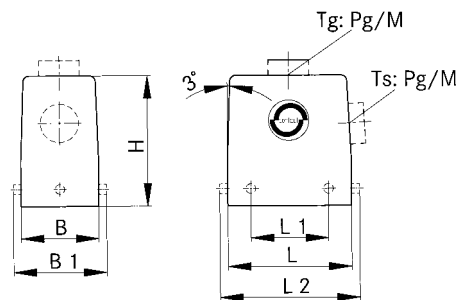

EPIC® H-B Gehäuse: Tüllengehäuse (Kabeleingang gerade, Bolzen für Querbügel)

EPIC® H-B housings: hood (top entry, bolts for double locking lever)

Boîtiers EPIC® H-B: capot (sortie verticale, ergots pour double levier)

H-B 32

| Artikel part article | Art.Nr. part No. N° art. | PG | M | ZW | L | L1 | L2 | L3 | L4 | B | B1 | B2 | B3 | B4 | B5 | H | H1 | H2 | S | d |
|----------------------------|--------------------------------|----|----|----|------|------|----|----|----|----|------|----|----|----|----|----|----|----|---|---|
| H-B 32 TG 21 | 10133000 | 21 | | ● | 93,5 | 64,5 | | | | 79 | 89,5 | | | | | 95 | | | | |
| H-B 32 TG 29 | 10134000 | 29 | | ● | | | | | | | | | | | | | | | | |
| H-B 32 TG M32 | 19134000 | | 32 | | 93,5 | 64,5 | | | | 79 | 89,5 | | | | | 95 | | | | |
| H-B 32 TG M40 | 19134400 | | 40 | | | | | | | | | | | | | | | | | |

Einsätze / Inserts / Inserts: 1.4: H-BE 32 / 1.5: H-EE 64 / 1.6: H-BS 12 / 1.8: H-D 80 / 1.9: H-DD 144 / 1.10: 2 x MC 16

Kabelverschraubung / Cable gland / Presse-étoupe: 5.1: Metr. & PG



PG



M

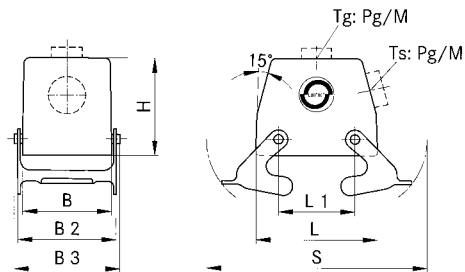

EPIC® H-B Gehäuse: Tüllengehäuse (Kabeleingang gerade, Querbügel)

EPIC® H-B housings: hood (top entry, double locking lever)

Boîtiers EPIC® H-B: capot (sortie verticale, double levier)

H-B 10

| Artikel part article | Art.Nr. part No. N° art. | PG | M | ZW | L | L1 | L2 | L3 | L4 | B | B1 | B2 | B3 | B4 | B5 | H | H1 | H2 | S | d |
|----------------------------|--------------------------------|----|----|----|----|----|----|----|----|----|------|----|----|----|----|----|----|----|---|-----|
| H-B 10 TGB 16 | 10041000 | 16 | | ● | 73 | 27 | | | | 43 | 57,8 | 53 | | | | 52 | | | | 116 |
| H-B 10 TGB M20 | 19041000 | | 20 | | 73 | 27 | | | | 43 | 57,8 | 53 | | | | 52 | | | | 116 |
| H-B 10 TGB M25 | 79055700 | | 25 | | | | | | | | | | | | | | | | | |

Einsätze / Inserts / Inserts: 1.4: H-BE 10 / 1.5: H-EE 18 / 1.7: H-BVE 3 / 1.9: H-DD 42 / 1.10: MC 10

Deckel / Cover / Couverture: 6.1: H-B 10

Kabelverschraubung / Cable gland / Presse-étoupe: 5.1: Metr. & PG

3.2 EPIC® D A - V I N C I H - B

Gehäuse / Hood / Capot



PG



M

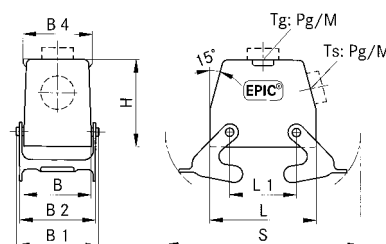

EPIC® H-B Gehäuse: Tüllengehäuse (Kabeleingang gerade, Querbügel)

EPIC® H-B housings: hood (top entry, double locking lever)

Boîtiers EPIC® H-B: capot (sortie verticale, double levier)

H-B 16

| Artikel part article | Art.Nr. part No. N° art. | PG | M | ZW | L | L1 | L2 | L3 | L4 | B | B1 | B2 | B3 | B4 | B5 | H | H1 | H2 | S | d |
|----------------------------|--------------------------------|----|----|----|------|------|----|----|----|----|------|----|----|----|----|----|----|----|---|-------|
| H-B 16 TGB 21 | 10081000 | 21 | | ● | 93,3 | 47,5 | | | | 43 | 57,8 | 53 | | | | 61 | | | | 136,5 |
| H-B 16 TGB M25 | 19081000 | | 25 | | 93,3 | 47,5 | | | | 43 | 57,8 | 53 | | | | 61 | | | | 136,5 |

Einsätze / Inserts / Inserts: 1.4: H-BE 16 / 1.5: H-EE 32 / 1.6: H-BS 6 / 1.7: H-BVE 6 / 1.8: H-D 40 / 1.9: H-DD 72 / 1.10: MC 16

Deckel / Cover / Couvercle: 6.1: H-B 16

Kabelverschraubung / Cable gland / Presse-étoupe: 5.1: Metr. & PG

H-B 24

| Artikel part article | Art.Nr. part No. N° art. | PG | M | ZW | L | L1 | L2 | L3 | L4 | B | B1 | B2 | B3 | B4 | B5 | H | H1 | H2 | S | d |
|----------------------------|--------------------------------|----|----|----|-----|----|----|----|----|----|------|----|----|----|----|----|----|----|---|-----|
| H-B 24 TGB 21 | 10122000 | 21 | | ● | 120 | 74 | | | | 43 | 57,8 | 53 | | | | 61 | | | | 163 |
| H-B 24 TGB 29 | 10112000 | 29 | | ● | | | | | | | | | | | | | | | | |
| H-B 24 TGB M25 | 19122000 | | 25 | | 120 | 74 | | | | 43 | 57,8 | 53 | | | | 61 | | | | 163 |
| H-B 24 TGB M32 | 19112000 | | 32 | | | | | | | | | | | | | | | | | |

Einsätze / Inserts / Inserts: 1.4: H-BE 24 / 1.5: H-EE 46 / 1.7: H-BVE 10 / 1.8: H-D 64 / 1.9: H-DD 108 / 1.10: MC 24

Deckel / Cover / Couvercle: 6.1: H-B 24

Kabelverschraubung / Cable gland / Presse-étoupe: 5.1: Metr. & PG

3.2 EPIC® D A - V I N C I H - B

Gehäuse / Hood / Capot



PG



M

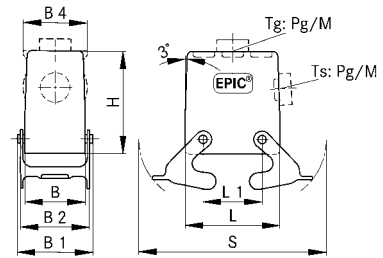

EPIC® H-B Gehäuse: Tüllengehäuse (Kabeleingang gerade, Querbügel, hohe Bauform)

EPIC® H-B housings: hood (top entry, double locking lever, high version)

Boîtiers EPIC® H-B: capot (sortie verticale, double levier, version haute)

H-B 10

| Artikel part article | Art.Nr. part No. N° art. | PG | M | ZW | L | L1 | L2 | L3 | L4 | B | B1 | B2 | B3 | B4 | B5 | H | H1 | H2 | S | d |
|----------------------------|--------------------------------|----|----|----|----|----|----|----|----|----|------|----|----|----|----|----|----|----|---|-----|
| H-B 10 TGBH 21 | 70055200 | 21 | | ● | 73 | 27 | | | | 43 | 57,8 | 53 | | | | 72 | | | | 116 |
| H-B 10 TGBH 29 | 70055400 | 29 | | ● | | | | | | | | | | | | | | | | |
| H-B 10 TGBH M25 | 79055200 | | 25 | | 73 | 27 | | | | 43 | 57,8 | 53 | | | | 72 | | | | 116 |
| H-B 10 TGBH M32 | 79055400 | | 32 | | | | | | | | | | | | | | | | | |

Einsätze / Inserts / Inserts: 1.4: H-BE 10 / 1.5: H-EE 18 / 1.7: H-BVE 3 / 1.9: H-DD 42 / 1.10: MC 10

Deckel / Cover / Couvercle: 6.1: H-B 10

Kabelverschraubung / Cable gland / Presse-étoupe: 5.1: Metr. & PG

H-B 16

| Artikel part article | Art.Nr. part No. N° art. | PG | M | ZW | L | L1 | L2 | L3 | L4 | B | B1 | B2 | B3 | B4 | B5 | H | H1 | H2 | S | d |
|----------------------------|--------------------------------|----|----|----|------|------|----|----|----|----|------|----|----|----|----|----|----|----|---|-------|
| H-B 16 TGBH 21 | 70105200 | 21 | | ● | 93,3 | 47,5 | | | | 43 | 57,8 | 53 | | | | 76 | | | | 136,5 |
| H-B 16 TGBH 29 | 70105400 | 29 | | ● | | | | | | | | | | | | | | | | |
| H-B 16 TGBH M25 | 79105200 | | 25 | | 93,3 | 47,5 | | | | 43 | 57,8 | 53 | | | | 76 | | | | 136,5 |
| H-B 16 TGBH M32 | 79105400 | | 32 | | | | | | | | | | | | | | | | | |

Einsätze / Inserts / Inserts: 1.4: H-BE 16 / 1.5: H-EE 32 / 1.6: H-BS 6 / 1.7: H-BVE 6 / 1.8: H-D 40 / 1.9: H-DD 72 / 1.10: MC 16

Deckel / Cover / Couvercle: 6.1: H-B 16

Kabelverschraubung / Cable gland / Presse-étoupe: 5.1: Metr. & PG

H-B 24

| Artikel part article | Art.Nr. part No. N° art. | PG | M | ZW | L | L1 | L2 | L3 | L4 | B | B1 | B2 | B3 | B4 | B5 | H | H1 | H2 | S | d |
|----------------------------|--------------------------------|----|----|----|-----|----|----|----|----|----|------|----|----|----|----|----|----|----|---|-----|
| H-B 24 TGBH 21 | 70155400 | 21 | | ● | 120 | 74 | | | | 43 | 57,8 | 53 | | | | 76 | | | | 163 |
| H-B 24 TGBH 29 | 70155600 | 29 | | ● | | | | | | | | | | | | | | | | |
| H-B 24 TGBH M25 | 79155400 | | 25 | | 120 | 74 | | | | 43 | 57,8 | 53 | | | | 76 | | | | 163 |
| H-B 24 TGBH M32 | 79155600 | | 32 | | | | | | | | | | | | | | | | | |

Einsätze / Inserts / Inserts: 1.4: H-BE 24 / 1.5: H-EE 46 / 1.7: H-BVE 10 / 1.8: H-D 64 / 1.9: H-DD 108 / 1.10: MC 24

Deckel / Cover / Couvercle: 6.1: H-B 24

Kabelverschraubung / Cable gland / Presse-étoupe: 5.1: Metr. & PG



3.2 EPIC® D A - V I N C I H - B

Gehäuse / Hood / Capot



PG / M

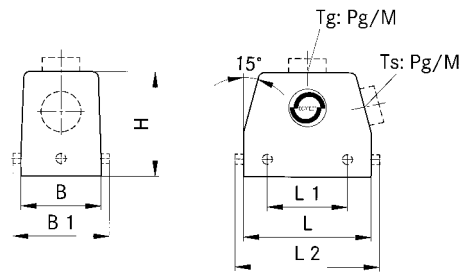

EPIC® H-B Gehäuse: Tüllengehäuse (Kabeleingang seitlich, Bolzen für Querbügel)

EPIC® H-B housings: hood (side entry, bolts for double locking lever)

Boîtiers EPIC® H-B: capot (sortie latérale, ergots pour double levier)

H-B 10

| Artikel part article | Art.Nr. part No. N° art. | PG | M | ZW | L | L1 | L2 | L3 | L4 | B | B1 | B2 | B3 | B4 | B5 | H | H1 | H2 | S | d |
|----------------------------|--------------------------------|----|----|----|----|----|----|----|----|----|------|----|----|----|----|----|----|----|---|---|
| H-B 10 TS 16 | 10042000 | 16 | | ● | 73 | 27 | | | | 43 | 57,8 | | | | | 52 | | | | |
| H-B 10 TS 21 | 10042100 | 21 | | ● | | | | | | | | | | | | | | | | |
| H-B 10 TS M20 | 19042000 | | 20 | ● | 73 | 27 | | | | 43 | 57,8 | | | | | 52 | | | | |
| H-B 10 TS M25 | 19042100 | | 25 | ● | | | | | | | | | | | | | | | | |

Einsätze / Inserts / Inserts: 1.4: H-BE 10 / 1.5: H-EE 18 / 1.7: H-BVE 3 / 1.9: H-DD 42 / 1.10: MC 10

Deckel / Cover / Couverture: 6.1: H-B 10

Kabelverschraubung / Cable gland / Presse-étoupe: 5.1: Metr. & PG



PG / M

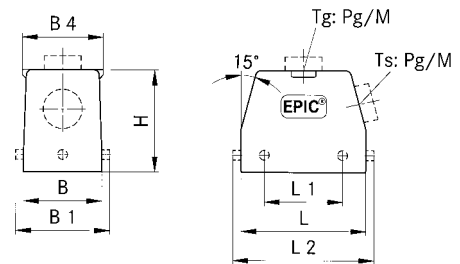

H-B 16

| Artikel part article | Art.Nr. part No. N° art. | PG | M | ZW | L | L1 | L2 | L3 | L4 | B | B1 | B2 | B3 | B4 | B5 | H | H1 | H2 | S | d |
|----------------------------|--------------------------------|----|----|----|------|------|----|----|----|----|------|----|----|----|----|----|----|----|---|---|
| H-B 16 TS 21 | 10082000 | 21 | | ● | 93,3 | 47,5 | | | | 43 | 57,8 | | | | | 61 | | | | |
| H-B 16 TS 29 | 10092000 | 29 | | ● | | | | | | | | | | | | | | | | |
| H-B 16 TS M25 | 19082000 | | 25 | ● | 93,3 | 47,5 | | | | 43 | 57,8 | | | | | 61 | | | | |
| H-B 16 TS M32 | 19092000 | | 32 | ● | | | | | | | | | | | | | | | | |

Einsätze / Inserts / Inserts: 1.4: H-BE 16 / 1.5: H-EE 32 / 1.6: H-BS 6 / 1.7: H-BVE 6 / 1.8: H-D 40 / 1.9: H-DD 72 / 1.10: MC 16

Deckel / Cover / Couverture: 6.1: H-B 16

Kabelverschraubung / Cable gland / Presse-étoupe: 5.1: Metr. & PG

H-B 24

| Artikel part article | Art.Nr. part No. N° art. | PG | M | ZW | L | L1 | L2 | L3 | L4 | B | B1 | B2 | B3 | B4 | B5 | H | H1 | H2 | S | d |
|----------------------------|--------------------------------|----|----|----|-----|----|----|----|----|----|------|----|----|----|----|----|----|----|---|---|
| H-B 24 TS 21 | 10113000 | 21 | | ● | 120 | 74 | | | | 43 | 57,8 | | | | | 61 | | | | |
| H-B 24 TS 29 | 10123000 | 29 | | ● | | | | | | | | | | | | | | | | |
| H-B 24 TS M25 | 19113000 | | 25 | ● | 120 | 74 | | | | 43 | 57,8 | | | | | 61 | | | | |
| H-B 24 TS M32 | 19123000 | | 32 | ● | | | | | | | | | | | | | | | | |

Einsätze / Inserts / Inserts: 1.4: H-BE 24 / 1.5: H-EE 46 / 1.7: H-BVE 10 / 1.8: H-D 64 / 1.9: H-DD 108 / 1.10: MC 24

Deckel / Cover / Couverture: 6.1: H-B 24

Kabelverschraubung / Cable gland / Presse-étoupe: 5.1: Metr. & PG

3.2 EPIC® D A - V I N C I H - B

Gehäuse / Hood / Capot

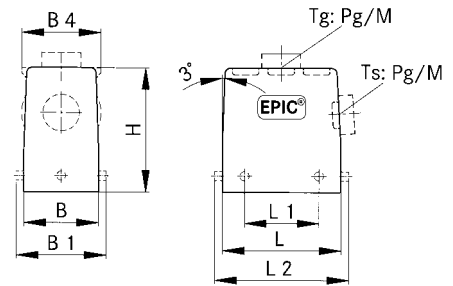

EPIC® H-B Gehäuse: Tüllengehäuse (Kabeleingang seitlich, Bolzen für Querbügel, hohe Bauform)
EPIC® H-B housings: hood (side entry, bolts for double locking lever, high version)
Boîtiers EPIC® H-B: capot (sortie latérale, ergots pour double levier, version haute)

H-B 10

| Artikel part article | Art.Nr. part No. N° art. | PG | M | ZW | L | L1 | L2 | L3 | L4 | B | B1 | B2 | B3 | B4 | B5 | H | H1 | H2 | S | d |
|----------------------------|--------------------------------|----|----|----|----|----|----|----|----|----|------|----|----|----|----|----|----|----|---|---|
| H-B 10 TSH 21 | 70052400 | 21 | | ● | 73 | 27 | | | | 43 | 57,8 | | | | | 72 | | | | |
| H-B 10 TSH 29 | 70052600 | 29 | | ● | | | | | | | | | | | | | | | | |
| H-B 10 TSH M25 | 79052400 | | 25 | | 73 | 27 | | | | 43 | 57,8 | | | | | 72 | | | | |
| H-B 10 TSH M32 | 79052600 | | 32 | | | | | | | | | | | | | | | | | |

Einsätze / Inserts / Inserts: 1.4: H-BE 10 / 1.5: H-EE 18 / 1.7: H-BVE 3 / 1.9: H-DD 42 / 1.10: MC 10

Deckel / Cover / Couvercle: 6.1: H-B 10

Kabelverschraubung / Cable gland / Presse-étoupe: 5.1: Metr. & PG

H-B 16

| Artikel part article | Art.Nr. part No. N° art. | PG | M | ZW | L | L1 | L2 | L3 | L4 | B | B1 | B2 | B3 | B4 | B5 | H | H1 | H2 | S | d |
|----------------------------|--------------------------------|----|----|----|------|------|----|----|----|----|------|----|----|----|----|----|----|----|---|---|
| H-B 16 TSH 21 | 70102200 | 21 | | ● | 93,3 | 47,5 | | | | 43 | 57,8 | | | | | 76 | | | | |
| H-B 16 TSH 29 | 70102400 | 29 | | ● | | | | | | | | | | | | | | | | |
| H-B 16 TSH M25 | 79102200 | | 25 | | | | | | | | | | | | | | | | | |
| H-B 16 TSH M32 | 79102400 | | 32 | | 93,3 | 47,5 | | | | 43 | 57,8 | | | | | 76 | | | | |
| H-B 16 TSH M40 | 79102800 | | 40 | | | | | | | | | | | | | | | | | |

Einsätze / Inserts / Inserts: 1.4: H-BE 16 / 1.5: H-EE 32 / 1.6: H-BS 6 / 1.7: H-BVE 6 / 1.8: H-D 40 / 1.9: H-DD 72 / 1.10: MC 16

Deckel / Cover / Couvercle: 6.1: H-B 16

Kabelverschraubung / Cable gland / Presse-étoupe: 5.1: Metr. & PG

H-B 24

| Artikel part article | Art.Nr. part No. N° art. | PG | M | ZW | L | L1 | L2 | L3 | L4 | B | B1 | B2 | B3 | B4 | B5 | H | H1 | H2 | S | d |
|----------------------------|--------------------------------|----|----|----|-----|----|----|----|----|----|------|----|----|----|----|----|----|----|---|---|
| H-B 24 TSH 21 | 70152400 | 21 | | ● | 120 | 74 | | | | 43 | 57,8 | | | | | 76 | | | | |
| H-B 24 TSH 29 | 70152600 | 29 | | ● | | | | | | | | | | | | | | | | |
| H-B 24 TSH M25 | 79152400 | | 25 | | | | | | | | | | | | | | | | | |
| H-B 24 TSH M32 | 79152600 | | 32 | | 120 | 74 | | | | 43 | 57,8 | | | | | 76 | | | | |
| H-B 24 TSH M40 | 79152800 | | 40 | | | | | | | | | | | | | | | | | |

Einsätze / Inserts / Inserts: 1.4: H-BE 24 / 1.5: H-EE 46 / 1.7: H-BVE 10 / 1.8: H-D 64 / 1.9: H-DD 108 / 1.10: MC 24

Deckel / Cover / Couvercle: 6.1: H-B 24

Kabelverschraubung / Cable gland / Presse-étoupe: 5.1: Metr. & PG

3.2 EPIC® D A - V I N C I H - B

Gehäuse / Hood / Capot



PG



M

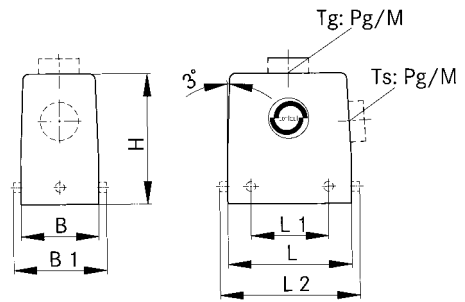

EPIC® H-B Gehäuse: Tüllengehäuse (Kabeleingang seitlich, Bolzen für Querbügel)

EPIC® H-B housings: hood (side entry, bolts for double locking lever)

Boîtiers EPIC® H-B: capot (sortie latérale, ergots pour double levier)

H-B 32

| Artikel part article | Art.Nr. part No. N° art. | PG | M | ZW | L | L1 | L2 | L3 | L4 | B | B1 | B2 | B3 | B4 | B5 | H | H1 | H2 | S | d |
|----------------------------|--------------------------------|----|----|----|------|------|----|----|----|----|------|----|----|----|----|----|----|----|---|---|
| H-B 32 TS 21 | 10135000 | 21 | | ● | | | | | | | | | | | | | | | | |
| H-B 32 TS 29 | 10136000 | 29 | | ● | 93,5 | 64,5 | | | | 79 | 89,5 | | | | | 95 | | | | |
| H-B 32 TS 29 | 10135600 | 29 | | | | | | | | | | | | | | | | | | |
| H-B 32 TS M25 | 19135000 | | 25 | | | | | | | | | | | | | | | | | |
| H-B 32 TS M32 | 19136000 | | 32 | | 93,5 | 64,5 | | | | 79 | 89,5 | | | | | 95 | | | | |
| H-B 32 TS M40 | 19136200 | | 40 | | | | | | | | | | | | | | | | | |

Einsätze / Inserts / Inserts: 1.4: H-BE 32 / 1.5: H-EE 64 / 1.6: H-BS 12 / 1.8: H-D 80 / 1.9: H-DD 144 / 1.10: 2 x MC 16

Kabelverschraubung / Cable gland / Presse-étoupe: 5.1: Metr. & PG

3.2 EPIC® D A - V I N C I H - B

Gehäuse / Hood / Capot



PG / M

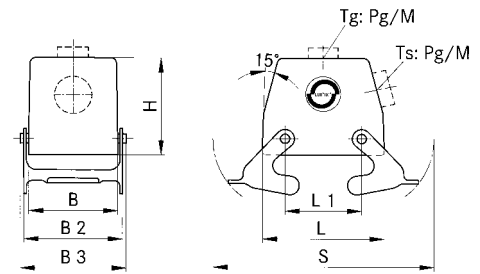

EPIC® H-B Gehäuse: Tüllengehäuse (Kabeleingang seitlich, Querbügel)

EPIC® H-B housings: hood (side entry, double locking lever)

Boîtiers EPIC® H-B: capot (sortie latérale, double levier)

H-B 10

| Artikel part article | Art.Nr. part No. N° art. | PG | M | ZW | L | L1 | L2 | L3 | L4 | B | B1 | B2 | B3 | B4 | B5 | H | H1 | H2 | S | d |
|----------------------------|--------------------------------|----|----|----|----|----|----|----|----|----|------|----|----|----|----|----|----|----|---|-----|
| H-B 10 TSB 16 | 10045000 | 16 | | ● | 73 | 27 | | | | 43 | 57,8 | 53 | | | | 52 | | | | 116 |
| H-B 10 TSB M20 | 19045000 | | 20 | ● | 73 | 27 | | | | 43 | 57,8 | 53 | | | | 52 | | | | 116 |
| H-B 10 TSB M25 | 79057700 | | 25 | ● | | | | | | | | | | | | | | | | |

Einsätze / Inserts / Inserts: 1.4: H-BE 10 / 1.5: H-EE 18 / 1.7: H-BVE 3 / 1.9: H-DD 42 / 1.10: MC 10

Deckel / Cover / Couvercle: 6.1: H-B 10

Kabelverschraubung / Cable gland / Presse-étoupe: 5.1: Metr. & PG



PG / M

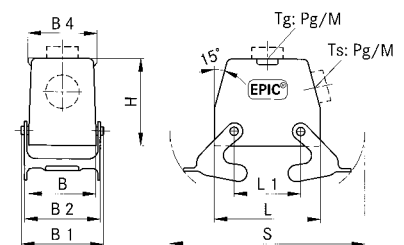

H-B 16

| Artikel part article | Art.Nr. part No. N° art. | PG | M | ZW | L | L1 | L2 | L3 | L4 | B | B1 | B2 | B3 | B4 | B5 | H | H1 | H2 | S | d |
|----------------------------|--------------------------------|----|----|----|------|------|----|----|----|----|------|----|----|----|----|----|----|----|---|-------|
| H-B 16 TSB 21 | 10083000 | 21 | | ● | 93,3 | 47,5 | | | | 43 | 57,8 | 53 | | | | 61 | | | | 136,5 |
| H-B 16 TSB M25 | 19083000 | | 25 | ● | 93,3 | 47,5 | | | | 43 | 57,8 | 53 | | | | 61 | | | | 136,5 |

Einsätze / Inserts / Inserts: 1.4: H-BE 16 / 1.5: H-EE 32 / 1.6: H-BS 6 / 1.7: H-BVE 6 / 1.8: H-D 40 / 1.9: H-DD 72 / 1.10: MC 16

Deckel / Cover / Couvercle: 6.1: H-B 16

Kabelverschraubung / Cable gland / Presse-étoupe: 5.1: Metr. & PG

H-B 24

| Artikel part article | Art.Nr. part No. N° art. | PG | M | ZW | L | L1 | L2 | L3 | L4 | B | B1 | B2 | B3 | B4 | B5 | H | H1 | H2 | S | d |
|----------------------------|--------------------------------|----|----|----|-----|----|----|----|----|----|------|----|----|----|----|----|----|----|---|-----|
| H-B 24 TSB 21 | 10114000 | 21 | | ● | 120 | 74 | | | | 43 | 57,8 | 53 | | | | 61 | | | | 163 |
| H-B 24 TSB 29 | 10124000 | 29 | | ● | | | | | | | | | | | | | | | | |
| H-B 24 TSB M25 | 19114000 | | 25 | ● | 120 | 74 | | | | 43 | 57,8 | 53 | | | | 61 | | | | 163 |
| H-B 24 TSB M32 | 19124000 | | 32 | ● | | | | | | | | | | | | | | | | |

Einsätze / Inserts / Inserts: 1.4: H-BE 24 / 1.5: H-EE 46 / 1.7: H-BVE 10 / 1.8: H-D 64 / 1.9: H-DD 108 / 1.10: MC 24

Deckel / Cover / Couvercle: 6.1: H-B 24

Kabelverschraubung / Cable gland / Presse-étoupe: 5.1: Metr. & PG

3.2 EPIC® D A - V I N C I H - B

Gehäuse / Hood / Capot

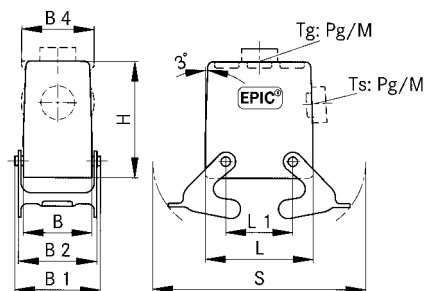

EPIC® H-B Gehäuse: Tüllengehäuse (Kabeleingang seitlich, Querbügel, hohe Bauform)

EPIC® H-B housings: hood (side entry, double locking lever, high version)

Boîtiers EPIC® H-B: capot (sortie latérale, double levier, version haute)

H-B 10

| Artikel part article | Art.Nr. part No. N° art. | PG | M | ZW | L | L1 | L2 | L3 | L4 | B | B1 | B2 | B3 | B4 | B5 | H | H1 | H2 | S | d |
|----------------------------|--------------------------------|----|----|----|----|----|----|----|----|----|------|----|----|----|----|----|----|----|---|-----|
| H-B 10 TSBH 21 | 70057200 | 21 | | ● | 73 | 27 | | | | 43 | 57,8 | 53 | | | | 72 | | | | 116 |
| H-B 10 TSBH 29 | 70057400 | 29 | | ● | | | | | | | | | | | | | | | | |
| H-B 10 TSBH M25 | 79057200 | | 25 | | 73 | 27 | | | | 43 | 57,8 | 53 | | | | 72 | | | | 116 |
| H-B 10 TSBH M32 | 79057400 | | 32 | | | | | | | | | | | | | | | | | |

Einsätze / Inserts / Inserts: 1.4: H-BE 10 / 1.5: H-EE 18 / 1.7: H-BVE 3 / 1.9: H-DD 42 / 1.10: MC 10

Deckel / Cover / Couvercle: 6.1: H-B 10

Kabelverschraubung / Cable gland / Presse-étoupe: 5.1: Metr. & PG

H-B 16

| Artikel part article | Art.Nr. part No. N° art. | PG | M | ZW | L | L1 | L2 | L3 | L4 | B | B1 | B2 | B3 | B4 | B5 | H | H1 | H2 | S | d |
|----------------------------|--------------------------------|----|----|----|------|------|----|----|----|----|------|----|----|----|----|----|----|----|---|-------|
| H-B 16 TSBH 21 | 70107200 | 21 | | ● | 93,3 | 47,5 | | | | 43 | 57,8 | 53 | | | | 76 | | | | 136,5 |
| H-B 16 TSBH 29 | 70107400 | 29 | | ● | | | | | | | | | | | | | | | | |
| H-B 16 TSBH M25 | 79107200 | | 25 | | 93,3 | 47,5 | | | | 43 | 57,8 | 53 | | | | 76 | | | | 136,5 |
| H-B 16 TSBH M32 | 79107400 | | 32 | | | | | | | | | | | | | | | | | |

Einsätze / Inserts / Inserts: 1.4: H-BE 16 / 1.5: H-EE 32 / 1.6: H-BS 6 / 1.7: H-BVE 6 / 1.8: H-D 40 / 1.9: H-DD 72 / 1.10: MC 16

Deckel / Cover / Couvercle: 6.1: H-B 16

Kabelverschraubung / Cable gland / Presse-étoupe: 5.1: Metr. & PG

H-B 24

| Artikel part article | Art.Nr. part No. N° art. | PG | M | ZW | L | L1 | L2 | L3 | L4 | B | B1 | B2 | B3 | B4 | B5 | H | H1 | H2 | S | d |
|----------------------------|--------------------------------|----|----|----|-----|----|----|----|----|----|------|----|----|----|----|----|----|----|---|-----|
| H-B 24 TSBH 21 | 70157400 | 21 | | ● | 120 | 74 | | | | 43 | 57,8 | 53 | | | | 76 | | | | 163 |
| H-B 24 TSBH 29 | 70157600 | 29 | | ● | | | | | | | | | | | | | | | | |
| H-B 24 TSBH M25 | 79157400 | | 25 | | 120 | 74 | | | | 43 | 57,8 | 53 | | | | 76 | | | | 163 |
| H-B 24 TSBH M32 | 79157600 | | 32 | | | | | | | | | | | | | | | | | |

Einsätze / Inserts / Inserts: 1.4: H-BE 24 / 1.5: H-EE 46 / 1.7: H-BVE 10 / 1.8: H-D 64 / 1.9: H-DD 108 / 1.10: MC 24

Deckel / Cover / Couvercle: 6.1: H-B 24

Kabelverschraubung / Cable gland / Presse-étoupe: 5.1: Metr. & PG



3.2 EPIC® D A - V I N C I H - B

Anbaugehäuse / Panel mount base / Embase encastrée

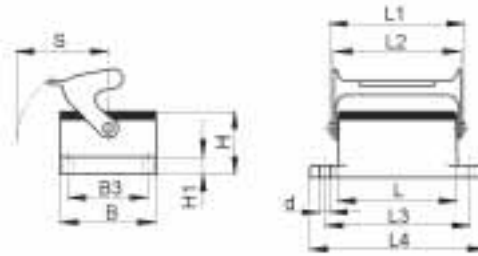

EPIC® H-B Gehäuse: Anbaugehäuse (Längsbügel)
EPIC® H-B housings: panel mount base (single locking lever)
Boîtiers EPIC® H-B: embase encastrée (simple levier)

H-B 6

| Artikel part article | Art.Nr. part No. N° art. | PG | L | L1 | L2 | L3 | L4 | B | B1 | B2 | B3 | B4 | B5 | H | H1 | H2 | S | d |
|----------------------------|--------------------------------|----|----|------|----|----|----|----|----|----|----|----|----|------|----|----|----|-----|
| H-B 6 AG-LB | 10003000 | | 60 | 74,8 | 70 | 70 | 80 | 43 | | | 32 | | | 27,8 | 4 | | 44 | 4,3 |

Einsätze / Inserts / Inserts: 1.4: H-BE 6 / 1.5: H-EE 10 / 1.9: H-DD 24 / 1.10: MC 6 / 1.11: TB H-BE 6
 Deckel / Cover / Couvercle: 6.1: H-B 6

H-B 10

| Artikel part article | Art.Nr. part No. N° art. | PG | L | L1 | L2 | L3 | L4 | B | B1 | B2 | B3 | B4 | B5 | H | H1 | H2 | S | d |
|----------------------------|--------------------------------|----|----|----|------|----|----|----|----|----|----|----|----|------|----|----|----|-----|
| H-B 10 AG-LB | 10032900 | | 73 | 91 | 88,5 | 83 | 93 | 43 | | | 32 | | | 27,8 | 4 | | 50 | 4,3 |

Einsätze / Inserts / Inserts: 1.4: H-BE 10 / 1.5: H-EE 18 / 1.7: H-BVE 3 / 1.9: H-DD 42 / 1.10: MC 10 / 1.11: TB H-BE 10

H-B 16

| Artikel part article | Art.Nr. part No. N° art. | PG | L | L1 | L2 | L3 | L4 | B | B1 | B2 | B3 | B4 | B5 | H | H1 | H2 | S | d |
|----------------------------|--------------------------------|----|------|-----|-------|-----|-----|----|----|----|----|----|----|------|----|----|----|-----|
| H-B 16 AG-LB | 10072900 | | 93,3 | 111 | 109,5 | 103 | 113 | 43 | | | 32 | | | 27,8 | 4 | | 50 | 4,3 |

Einsätze / Inserts / Inserts: 1.4: H-BE 16 / 1.5: H-EE 32 / 1.6: H-BS 6 / 1.7: H-BVE 6 / 1.8: H-D 40 / 1.9: H-DD 72 / 1.10: MC 16 / 1.11: TB H-BE 16

H-B 24

| Artikel part article | Art.Nr. part No. N° art. | PG | L | L1 | L2 | L3 | L4 | B | B1 | B2 | B3 | B4 | B5 | H | H1 | H2 | S | d |
|----------------------------|--------------------------------|----|-----|-----|-------|-----|-----|----|----|----|----|----|----|------|----|----|----|-----|
| H-B 24 AG-LB | 10102900 | | 120 | 138 | 136,5 | 130 | 140 | 43 | | | 32 | | | 27,8 | 4 | | 50 | 4,3 |

Einsätze / Inserts / Inserts: 1.4: H-BE 24 / 1.5: H-EE 46 / 1.7: H-BVE 10 / 1.8: H-D 64 / 1.9: H-DD 108 / 1.10: MC 24 / 1.11: TB H-BE 24

H-B 48

| Artikel part article | Art.Nr. part No. N° art. | PG | L | L1 | L2 | L3 | L4 | B | B1 | B2 | B3 | B4 | B5 | H | H1 | H2 | S | d |
|----------------------------|--------------------------------|----|-----|-----|-------|-----|-----|----|----|----|----|----|----|------|----|----|-----|---|
| H-B 48 AG-LB | 10161000 | | 132 | 152 | 139,5 | 148 | 165 | 90 | | | 70 | | | 39,5 | 10 | | 105 | 7 |

Einsätze / Inserts / Inserts: 1.4: H-BE 48 / 1.5: H-EE 92 / 1.7: 2 x H-BVE 10 / 1.8: H-D 128 / 1.9: H-DD 216 / 1.10: 2 x MC 24 / 1.11: 2 x TB H-BE 24 & 2 x TB H-D 64

3.2 EPIC® D A - V I N C I H - B

Anbaugehäuse / Panel mount base / Embase encastrée

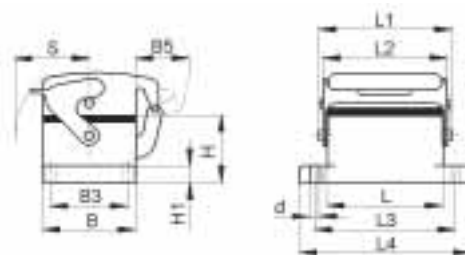

EPIC® H-B Gehäuse: Anbaugehäuse (Schutzdeckel, Längsbügel)

EPIC® H-B housings: panel mount base (cover, single locking lever)

Boîtiers EPIC® H-B: embase encastrée (couvercle, simple levier)

H-B 6

| Artikel part article | Art.Nr. part No. N° art. | PG | L | L1 | L2 | L3 | L4 | B | B1 | B2 | B3 | B4 | B5 | H | H1 | H2 | S | d |
|----------------------------|--------------------------------|----|----|------|----|----|----|----|----|----|----|----|----|------|----|----|----|-----|
| H-B 6 AD-LB | 10004000 | | 60 | 74,8 | 70 | 70 | 80 | 43 | | | 32 | | 25 | 27,8 | 4 | | 44 | 4,3 |

Einsätze / Inserts / Inserts: 1.4: H-BE 6 / 1.5: H-EE 10 / 1.9: H-DD 24 / 1.10: MC 6 / 1.11: TB H-BE 6

H-B 10

| Artikel part article | Art.Nr. part No. N° art. | PG | L | L1 | L2 | L3 | L4 | B | B1 | B2 | B3 | B4 | B5 | H | H1 | H2 | S | d |
|----------------------------|--------------------------------|----|----|----|------|----|----|----|----|----|----|----|----|------|----|----|----|-----|
| H-B 10 AD-LB | 10033900 | | 73 | 91 | 88,5 | 83 | 93 | 43 | | | 32 | | 25 | 27,8 | 4 | | 50 | 4,3 |

Einsätze / Inserts / Inserts: 1.4: H-BE 10 / 1.5: H-EE 18 / 1.7: H-BVE 3 / 1.9: H-DD 42 / 1.10: MC 10 / 1.11: TB H-BE 10

H-B 16

| Artikel part article | Art.Nr. part No. N° art. | PG | L | L1 | L2 | L3 | L4 | B | B1 | B2 | B3 | B4 | B5 | H | H1 | H2 | S | d |
|----------------------------|--------------------------------|----|------|-----|-------|-----|-----|----|----|----|----|----|----|------|----|----|----|-----|
| H-B 16 AD-LB | 10073900 | | 93,3 | 111 | 109,5 | 103 | 113 | 43 | | | 32 | | 25 | 27,8 | 4 | | 50 | 4,3 |

Einsätze / Inserts / Inserts: 1.4: H-BE 16 / 1.5: H-EE 32 / 1.6: H-BS 6 / 1.7: H-BVE 6 / 1.8: H-D 40 / 1.9: H-DD 72 / 1.10: MC 16 / 1.11: TB H-BE 16

H-B 24

| Artikel part article | Art.Nr. part No. N° art. | PG | L | L1 | L2 | L3 | L4 | B | B1 | B2 | B3 | B4 | B5 | H | H1 | H2 | S | d |
|----------------------------|--------------------------------|----|-----|-----|-------|-----|-----|----|----|----|----|----|----|------|----|----|----|-----|
| H-B 24 AD-LB | 10103900 | | 120 | 138 | 136,5 | 130 | 140 | 43 | | | 32 | | 25 | 27,8 | 4 | | 50 | 4,3 |

Einsätze / Inserts / Inserts: 1.4: H-BE 24 / 1.5: H-EE 46 / 1.7: H-BVE 10 / 1.8: H-D 64 / 1.9: H-DD 108 / 1.10: MC 24 / 1.11: TB H-BE 24

H-B 48

| Artikel part article | Art.Nr. part No. N° art. | PG | L | L1 | L2 | L3 | L4 | B | B1 | B2 | B3 | B4 | B5 | H | H1 | H2 | S | d |
|----------------------------|--------------------------------|----|-----|-----|-------|-----|-----|----|----|----|----|----|----|------|----|----|-----|---|
| H-B 48 AD-LB | 10152000 | | 132 | 152 | 139,5 | 148 | 165 | 90 | | | 70 | | 30 | 39,5 | 10 | | 105 | 7 |

Einsätze / Inserts / Inserts: 1.4: H-BE 48 / 1.5: H-EE 92 / 1.7: 2 x H-BVE 10 / 1.8: H-D 128 / 1.9: H-DD 216 / 1.10: 2 x MC 24 / 1.11: 2 x TB H-BE 24 & 2 x TB H-D 64

3

3.2 EPIC® D A - V I N C I H - B

Anbaugehäuse / Panel mount base / Embase encastrée

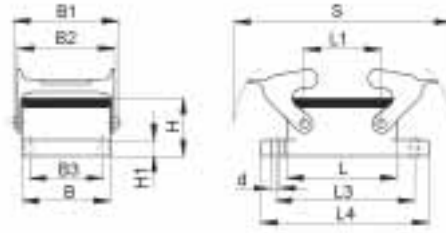

EPIC® H-B Gehäuse: Anbaugehäuse (Querbügel)
EPIC® H-B housings: panel mount base (double locking lever)
Boîtiers EPIC® H-B: embase encastrée (double levier)

H-B 10

| Artikel part article | Art.Nr. part No. N° art. | PG | L | L1 | L2 | L3 | L4 | B | B1 | B2 | B3 | B4 | B5 | H | H1 | H2 | S | d |
|----------------------------|--------------------------------|----|----|----|----|----|----|----|------|----|----|----|----|------|----|----|-----|-----|
| H-B 10 AG | 10032000 | | 73 | 27 | | 83 | 93 | 43 | 57,8 | 53 | 32 | | | 27,8 | 4 | | 116 | 4,3 |

Einsätze / Inserts / Inserts: 1.4: H-BE 10 / 1.5: H-EE 18 / 1.7: H-BVE 3 / 1.9: H-DD 42 / 1.10: MC 10 / 1.11: TB H-BE 10
 Deckel / Cover / Couvercle: 6.1: H-B 10

H-B 16

| Artikel part article | Art.Nr. part No. N° art. | PG | L | L1 | L2 | L3 | L4 | B | B1 | B2 | B3 | B4 | B5 | H | H1 | H2 | S | d |
|----------------------------|--------------------------------|----|------|------|----|-----|-----|----|------|----|----|----|----|------|----|----|-------|-----|
| H-B 16 AG | 10072000 | | 93,3 | 47,5 | | 103 | 113 | 43 | 57,8 | 53 | 32 | | | 27,8 | 4 | | 136,5 | 4,3 |

Einsätze / Inserts / Inserts: 1.4: H-BE 16 / 1.5: H-EE 32 / 1.6: H-BS 6 / 1.7: H-BVE 6 / 1.8: H-D 40 / 1.9: H-DD 72 / 1.10: MC 16 /
 1.11: TB H-BE 16
 Deckel / Cover / Couvercle: 6.1: H-B 16

H-B 24

| Artikel part article | Art.Nr. part No. N° art. | PG | L | L1 | L2 | L3 | L4 | B | B1 | B2 | B3 | B4 | B5 | H | H1 | H2 | S | d |
|----------------------------|--------------------------------|----|-----|----|----|-----|-----|----|------|----|----|----|----|------|----|----|-----|-----|
| H-B 24 AG | 10102000 | | 120 | 74 | | 130 | 140 | 43 | 57,8 | 53 | 32 | | | 27,8 | 4 | | 163 | 4,3 |

Einsätze / Inserts / Inserts: 1.4: H-BE 24 / 1.5: H-EE 46 / 1.7: H-BVE 10 / 1.8: H-D 64 / 1.9: H-DD 108 / 1.10: MC 24 /
 1.11: TB H-BE 24
 Deckel / Cover / Couvercle: 6.1: H-B 24

H-B 32

| Artikel part article | Art.Nr. part No. N° art. | Art.Nr.: EP part No.: EP N° art.: EP | PG | L | L1 | L2 | L3 | L4 | B | B1 | B2 | B3 | B4 | B5 | H | H1 | H2 | S | d |
|----------------------------|--------------------------------|--|----|------|------|----|-----|-----|----|------|------|----|----|----|------|----|----|-------|-----|
| H-B 32 AG | 10132000 | | | 93,5 | 64,5 | | 110 | 124 | 79 | 93,8 | 87,8 | 65 | | | 30,3 | 5 | | 136,5 | 5,5 |

Einsätze / Inserts / Inserts: 1.4: H-BE 32 / 1.5: H-EE 64 / 1.6: H-BS 12 / 1.8: H-D 80 / 1.9: H-DD 144 / 1.10: 2 x MC 24 /
 1.11: 2 x TB H-BE 16 & 2 x TB H-D 40

3.2 EPIC® D A - V I N C I H - B

Anbaugehäuse / Panel mount base / Embase encastrée

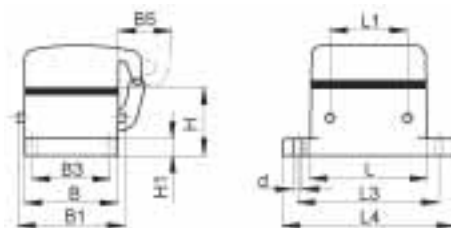

EPIC® H-B Gehäuse: Anbaugehäuse (Schutzdeckel, Bolzen für Querbügel)

EPIC® H-B housings: panel mount base (cover, bolts for double locking lever)

Boîtiers EPIC® H-B: embase encastrée (couvercle, ergots pour double levier)

H-B 10

| Artikel part article | Art.Nr. part No. N° art. | PG | L | L1 | L2 | L3 | L4 | B | B1 | B2 | B3 | B4 | B5 | H | H1 | H2 | S | d |
|----------------------------|--------------------------------|----|----|----|----|----|----|----|------|----|----|----|----|------|----|----|---|-----|
| H-B 10 AD-BO | 10033000 | | 73 | 27 | | 83 | 93 | 43 | 57,8 | | 32 | | 25 | 27,8 | 4 | | | 4,3 |

Einsätze / Inserts / Inserts: 1.4: H-BE 10 / 1.5: H-EE 18 / 1.7: H-BVE 3 / 1.9: H-DD 42 / 1.10: MC 10 / 1.11: TB H-BE 10

H-B 16

| Artikel part article | Art.Nr. part No. N° art. | PG | L | L1 | L2 | L3 | L4 | B | B1 | B2 | B3 | B4 | B5 | H | H1 | H2 | S | d |
|----------------------------|--------------------------------|----|------|------|----|-----|-----|----|------|----|----|----|----|------|----|----|---|-----|
| H-B 16 AD-BO | 10073000 | | 93,3 | 47,5 | | 103 | 113 | 43 | 57,8 | | 32 | | 25 | 27,8 | 4 | | | 4,3 |

Einsätze / Inserts / Inserts: 1.4: H-BE 16 / 1.5: H-EE 32 / 1.6: H-BS 6 / 1.7: H-BVE 6 / 1.8: H-D 40 / 1.9: H-DD 72 / 1.10: MC 16 / 1.11: TB H-BE 16

H-B 24

| Artikel part article | Art.Nr. part No. N° art. | PG | L | L1 | L2 | L3 | L4 | B | B1 | B2 | B3 | B4 | B5 | H | H1 | H2 | S | d |
|----------------------------|--------------------------------|----|-----|----|----|-----|-----|----|------|----|----|----|----|------|----|----|---|-----|
| H-B 24 AD-BO | 10103000 | | 120 | 74 | | 130 | 140 | 43 | 57,8 | | 32 | | 25 | 27,8 | 4 | | | 4,3 |

Einsätze / Inserts / Inserts: 1.4: H-BE 24 / 1.5: H-EE 46 / 1.7: H-BVE 10 / 1.8: H-D 64 / 1.9: H-DD 108 / 1.10: MC 24 / 1.11: TB H-BE 24

3.2 EPIC® D A - V I N C I H - B

Sockelgehäuse / Surface mount base / Embase en saillie



PG / M

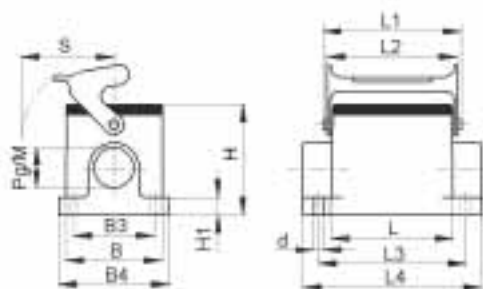

EPIC® H-B Gehäuse: Sockelgehäuse (2 Kabeleingänge, Längsbügel)
EPIC® H-B housings: surface mount base (2 cable entries, single locking lever)
Boîtiers EPIC® H-B: embase en saillie (2 entrées de câble, simple levier)

H-B 6

| Artikel part article | Art.Nr. part No. N° art. | PG | M | L | L1 | L2 | L3 | L4 | B | B1 | B2 | B3 | B4 | B5 | H | H1 | H2 | S | d |
|----------------------------|--------------------------------|----|----|----|------|----|----|----|----|----|----|----|----|----|----|-----|----|----|-----|
| H-B 6 SGRL 16 | 10006000 | 16 | | 60 | 74,8 | 70 | 70 | 84 | 43 | | | 40 | 52 | | 57 | 4,5 | | 44 | 5,5 |
| H-B 6 SGRL M20 | 19006000 | | 20 | 60 | 74,8 | 70 | 70 | 84 | 43 | | | 40 | 52 | | 57 | 4,5 | | 44 | 5,5 |
| H-B 6 SGRL M25 | 79006600 | | 25 | | | | | | | | | | | | | | | | |

Einsätze / Inserts / Inserts: 1.4: H-BE 6 / 1.5: H-EE 10 / 1.9: H-DD 24 / 1.10: MC 6

Deckel / Cover / Couvercle: 6.1: H-B 6

Kabelverschraubung / Cable gland / Presse-étoupe: 5.1: Metr. & PG

H-B 10

| Artikel part article | Art.Nr. part No. N° art. | PG | M | L | L1 | L2 | L3 | L4 | B | B1 | B2 | B3 | B4 | B5 | H | H1 | H2 | S | d |
|----------------------------|--------------------------------|----|----|----|----|------|----|----|----|----|----|----|----|----|----|-----|----|----|-----|
| H-B 10 SGRL-LB 16 | 10035900 | 16 | | 73 | 91 | 88,5 | 82 | 94 | 43 | | | 40 | 52 | | 57 | 4,5 | | 50 | 5,5 |
| H-B 10 SGRL-LB M20 | 19035900 | | 20 | 73 | 91 | 88,5 | 82 | 94 | 43 | | | 40 | 52 | | 57 | 4,5 | | 50 | 5,5 |
| H-B 10 SGRL-LB M25 | 79061600 | | 25 | | | | | | | | | | | | | | | | |

Einsätze / Inserts / Inserts: 1.4: H-BE 10 / 1.5: H-EE 18 / 1.7: H-BVE 3 / 1.9: H-DD 42 / 1.10: MC 10

Kabelverschraubung / Cable gland / Presse-étoupe: 5.1: Metr. & PG

H-B 16

| Artikel part article | Art.Nr. part No. N° art. | PG | M | L | L1 | L2 | L3 | L4 | B | B1 | B2 | B3 | B4 | B5 | H | H1 | H2 | S | d |
|----------------------------|--------------------------------|----|----|----|-----|-------|-----|-----|----|----|----|----|----|----|----|-----|----|----|-----|
| H-B 16 SGRL-LB 21 | 10075900 | 21 | | 93 | 111 | 109,5 | 105 | 117 | 43 | | | 45 | 57 | | 64 | 4,5 | | 50 | 5,5 |
| H-B 16 SGRL-LB M25 | 19075900 | | 25 | 93 | 111 | 109,5 | 105 | 117 | 43 | | | 45 | 57 | | 64 | 4,5 | | 50 | 5,5 |

Einsätze / Inserts / Inserts: 1.4: H-BE 16 / 1.5: H-EE 32 / 1.6: H-BS 6 / 1.7: H-BVE 6 / 1.8: H-D 40 / 1.9: H-DD 72 / 1.10: MC 16

Kabelverschraubung / Cable gland / Presse-étoupe: 5.1: Metr. & PG

3.2 EPIC® D A - V I N C I H - B

Sockelgehäuse / Surface mount base / Embase en saillie



PG / M

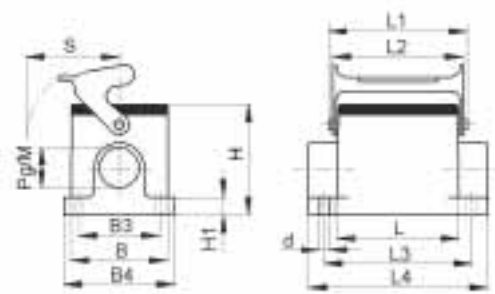

EPIC® H-B Gehäuse: Sockelgehäuse (2 Kabeleingänge, Längsbügel)

EPIC® H-B housings: surface mount base (2 cable entries, single locking lever)

Boîtiers EPIC® H-B: embase en saillie (2 entrées de câble, simple levier)

H-B 24

| Artikel part article | Art.Nr. part No. N° art. | PG | M | L | L1 | L2 | L3 | L4 | B | B1 | B2 | B3 | B4 | B5 | H | H1 | H2 | S | d |
|----------------------------|--------------------------------|----|----|-----|-----|-------|-----|-----|----|----|----|----|----|----|----|-----|----|----|-----|
| H-B 24 SGRL-LB 21 | 10105900 | | 21 | 120 | 138 | 136,5 | 132 | 144 | 43 | | | 45 | 57 | | 64 | 4,5 | | 50 | 5,5 |
| H-B 24 SGRL-LB M25 | 19105900 | | 25 | 120 | 138 | 136,5 | 132 | 144 | 43 | | | 45 | 57 | | 64 | 4,5 | | 50 | 5,5 |

Einsätze / Inserts / Inserts: 1.4: H-BE 24 / 1.5: H-EE 46 / 1.7: H-BVE 10 / 1.8: H-D 64 / 1.9: H-DD 108 / 1.10: MC 24
Kabelverschraubung / Cable gland / Presse-étoupe: 5.1: Metr. & PG

H-B 48

| Artikel part article | Art.Nr. part No. N° art. | PG | M | L | L1 | L2 | L3 | L4 | B | B1 | B2 | B3 | B4 | B5 | H | H1 | H2 | S | d |
|----------------------------|--------------------------------|----|----|---|-----|-----|-------|-----|-----|----|----|-----|-----|----|-----|----|----|-----|-----|
| H-B 48 SGRL 29 | 10166000 | | 29 | | 132 | 152 | 139,5 | 111 | 132 | 90 | | 106 | 120 | | 100 | 12 | | 105 | 6,5 |
| H-B 48 SGRL 36 | 10166100 | | 36 | | 132 | 152 | 139,5 | 111 | 132 | 90 | | 106 | 120 | | 100 | 12 | | 105 | 6,5 |
| H-B 48 SGRL M32 | 19166000 | | 32 | | 132 | 152 | 139,5 | 111 | 132 | 90 | | 106 | 120 | | 100 | 12 | | 105 | 6,5 |
| H-B 48 SGRL M40 | 19166100 | | 40 | | 132 | 152 | 139,5 | 111 | 132 | 90 | | 106 | 120 | | 100 | 12 | | 105 | 6,5 |

Einsätze / Inserts / Inserts: 1.4: H-BE 48 / 1.5: H-EE 92 / 1.7: 2 x H-BVE 10 / 1.8: H-D 128 / 1.9: H-DD 216 / 1.10: 2 x MC 24
Kabelverschraubung / Cable gland / Presse-étoupe: 5.1: Metr. & PG

3.2 EPIC® D A - V I N C I H - B

Sockelgehäuse / Surface mount base / Embase en saillie



PG / M

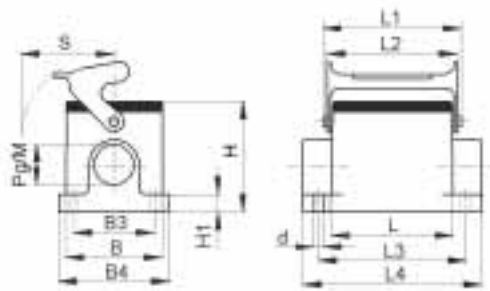

EPIC® H-B Gehäuse: Sockelgehäuse (2 Kabeleingänge, Längsbügel, hohe Bauform)

EPIC® H-B housings: surface mount base (2 cable entries, single locking lever, high version)

Boîtiers EPIC® H-B: embase en saillie (2 entrées de câble, simple levier, version haute)

H-B 6

| Artikel part article | Art.Nr. part No. N° art. | PG | M | L | L1 | L2 | L3 | L4 | B | B1 | B2 | B3 | B4 | B5 | H | H1 | H2 | S | d |
|----------------------------|--------------------------------|----|----|----|------|----|----|----|----|----|----|----|----|----|----|----|----|----|-----|
| H-B 6 SGR LH 21 | 70006200 | 21 | | 60 | 74,8 | 70 | 70 | 84 | 43 | | | 45 | 58 | | 74 | 6 | | 44 | 5,5 |
| H-B 6 SGR LH 29 | 70006400 | 29 | | | | | | | | | | | | | | | | | |
| H-B 6 SGR LH M25 | 79006200 | | 25 | 60 | 74,8 | 70 | 70 | 84 | 43 | | | 45 | 58 | | 74 | 6 | | 44 | 5,5 |
| H-B 6 SGR LH M32 | 79006400 | | 32 | | | | | | | | | | | | | | | | |

Einsätze / Inserts / Inserts: 1.4: H-BE 6 / 1.5: H-EE 10 / 1.9: H-DD 24 / 1.10: MC 6

Deckel / Cover / Couvercle: 6.1: H-B 6

Kabelverschraubung / Cable gland / Presse-étoupe: 5.1: Metr. & PG

H-B 10

| Artikel part article | Art.Nr. part No. N° art. | PG | M | L | L1 | L2 | L3 | L4 | B | B1 | B2 | B3 | B4 | B5 | H | H1 | H2 | S | d |
|----------------------------|--------------------------------|----|----|----|----|------|----|----|----|----|----|----|----|----|----|----|----|----|-----|
| H-B 10 SGR LH-LB 21 | 70061200 | 21 | | 73 | 91 | 88,5 | 82 | 97 | 43 | | | 45 | 58 | | 74 | 6 | | 50 | 5,5 |
| H-B 10 SGR LH-LB 29 | 70061400 | 29 | | | | | | | | | | | | | | | | | |
| H-B 10 SGR LH-LB M25 | 79061200 | | 25 | 73 | 91 | 88,5 | 82 | 97 | 43 | | | 45 | 58 | | 74 | 6 | | 50 | 5,5 |
| H-B 10 SGR LH-LB M32 | 79061400 | | 32 | | | | | | | | | | | | | | | | |

Einsätze / Inserts / Inserts: 1.4: H-BE 10 / 1.5: H-EE 18 / 1.7: H-BVE 3 / 1.9: H-DD 42 / 1.10: MC 10

Kabelverschraubung / Cable gland / Presse-étoupe: 5.1: Metr. & PG

3.2 EPIC® D A - V I N C I H - B

Sockelgehäuse / Surface mount base / Embase en saillie



PG / M

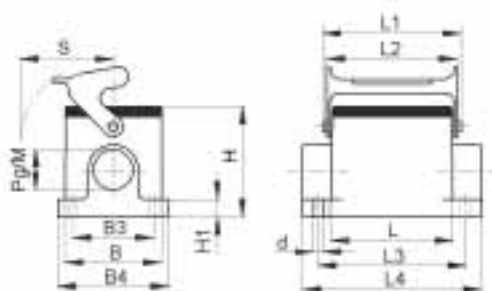

EPIC® H-B Gehäuse: Sockelgehäuse (2 Kabeleingänge, Längsbügel, hohe Bauform)

EPIC® H-B housings: surface mount base (2 cable entries, single locking lever, high version)

Boîtiers EPIC® H-B: embase en saillie (2 entrées de câble, simple levier, version haute)

H-B 16

| Artikel part article | Art.Nr. part No. N° art. | PG | M | L | L1 | L2 | L3 | L4 | B | B1 | B2 | B3 | B4 | B5 | H | H1 | H2 | S | d |
|----------------------------|--------------------------------|----|----|------|-----|-------|-----|-----|----|----|----|----|----|----|----|----|----|----|-----|
| H-B 16 SGRLH-LB 21 | 70111200 | 21 | | 93,3 | 111 | 109,5 | 105 | 117 | 43 | | | 45 | 58 | | 84 | 6 | | 50 | 5,5 |
| H-B 16 SGRLH-LB 29 | 70111400 | 29 | | | | | | | | | | | | | | | | | |
| H-B 16 SGRLH-LB M25 | 79111200 | | 25 | 93,3 | 111 | 109,5 | 105 | 117 | 43 | | | 45 | 58 | | 84 | 6 | | 50 | 5,5 |
| H-B 16 SGRLH-LB M32 | 79111400 | | 32 | | | | | | | | | | | | | | | | |

Einsätze / Inserts / Inserts: 1.4: H-BE 16 / 1.5: H-EE 32 / 1.6: H-BS 6 / 1.7: H-BVE 6 / 1.8: H-D 40 / 1.9: H-DD 72 / 1.10: MC 16
Kabelverschraubung / Cable gland / Presse-étoupe: 5.1: Metr. & PG

H-B 24

| Artikel part article | Art.Nr. part No. N° art. | PG | M | L | L1 | L2 | L3 | L4 | B | B1 | B2 | B3 | B4 | B5 | H | H1 | H2 | S | d |
|----------------------------|--------------------------------|----|----|-----|-----|-------|-----|-----|----|----|----|----|----|----|----|----|----|----|-----|
| H-B 24 SGRLH-LB 21 | 70161200 | 21 | | 120 | 138 | 136,5 | 132 | 144 | 43 | | | 45 | 58 | | 84 | 6 | | 50 | 5,5 |
| H-B 24 SGRLH-LB 29 | 70161400 | 29 | | | | | | | | | | | | | | | | | |
| H-B 24 SGRLH-LB M25 | 79161200 | | 25 | 120 | 138 | 136,5 | 132 | 144 | 43 | | | 45 | 58 | | 84 | 6 | | 50 | 5,5 |
| H-B 24 SGRLH-LB M32 | 79161400 | | 32 | | | | | | | | | | | | | | | | |

Einsätze / Inserts / Inserts: 1.4: H-BE 24 / 1.5: H-EE 46 / 1.7: H-BVE 10 / 1.8: H-D 64 / 1.9: H-DD 108 / 1.10: MC 24
Kabelverschraubung / Cable gland / Presse-étoupe: 5.1: Metr. & PG

3.2 EPIC® D A - V I N C I H - B

Sockelgehäuse / Surface mount base / Embase en saillie



PG / M

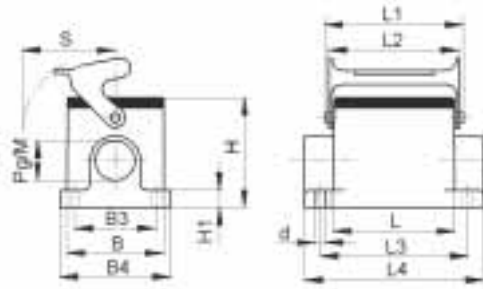

EPIC® H-B Gehäuse: Sockelgehäuse (1 Kabeleingang, Längsbügel)

EPIC® H-B housings: surface mount base (1 cable entry, single locking lever)

Boîtiers EPIC® H-B: embase en saillie (1 entrée de câble, simple levier)

H-B 6

| Artikel part article | Art.Nr. part No. N° art. | PG | M | L | L1 | L2 | L3 | L4 | B | B1 | B2 | B3 | B4 | B5 | H | H1 | H2 | S | d |
|----------------------------|--------------------------------|----|----|----|------|----|----|----|----|----|----|----|----|----|----|-----|----|----|-----|
| H-B 6 SGR 16 | 10005000 | 16 | | 60 | 74,8 | 70 | 70 | 84 | 43 | | | 40 | 52 | | 57 | 4,5 | | 44 | 5,5 |
| H-B 6 SGR M20 | 19005000 | | 20 | 60 | 74,8 | 70 | 70 | 84 | 43 | | | 40 | 52 | | 57 | 4,5 | | 44 | 5,5 |
| H-B 6 SGR M25 | 79005600 | | 25 | | | | | | | | | | | | | | | | |

Einsätze / Inserts / Inserts: 1.4: H-BE 6 / 1.5: H-EE 10 / 1.9: H-DD 24 / 1.10: MC 6

Deckel / Cover / Couvercle: 6.1: H-B 6

Kabelverschraubung / Cable gland / Presse-étoupe: 5.1: Metr. & PG

H-B 10

| Artikel part article | Art.Nr. part No. N° art. | PG | M | L | L1 | L2 | L3 | L4 | B | B1 | B2 | B3 | B4 | B5 | H | H1 | H2 | S | d |
|----------------------------|--------------------------------|----|----|----|----|------|----|----|----|----|----|----|----|----|----|-----|----|----|-----|
| H-B 10 SGR-LB 16 | 10034900 | 16 | | 73 | 91 | 88,5 | 82 | 94 | 43 | | | 40 | 52 | | 57 | 4,5 | | 50 | 5,5 |
| H-B 10 SGR-LB 21 | 10034700 | 21 | | | | | | | | | | | | | | | | | |
| H-B 10 SGR-LB M20 | 19034900 | | 20 | 73 | 91 | 88,5 | 82 | 94 | 43 | | | 40 | 52 | | 57 | 4,5 | | 50 | 5,5 |
| H-B 10 SGR-LB M25 | 19034700 | | 25 | | | | | | | | | | | | | | | | |

Einsätze / Inserts / Inserts: 1.4: H-BE 10 / 1.5: H-EE 18 / 1.7: H-BVE 3 / 1.9: H-DD 42 / 1.10: MC 10

Kabelverschraubung / Cable gland / Presse-étoupe: 5.1: Metr. & PG

H-B 16

| Artikel part article | Art.Nr. part No. N° art. | PG | M | L | L1 | L2 | L3 | L4 | B | B1 | B2 | B3 | B4 | B5 | H | H1 | H2 | S | d |
|----------------------------|--------------------------------|----|----|----|-----|-------|-----|-----|----|----|----|----|----|----|----|-----|----|----|-----|
| H-B 16 SGR-LB 21 | 10074900 | 21 | | 93 | 111 | 109,5 | 105 | 117 | 43 | | | 45 | 57 | | 64 | 4,5 | | 50 | 5,5 |
| H-B 16 SGR-LB M25 | 19074900 | | 25 | 93 | 111 | 109,5 | 105 | 117 | 43 | | | 45 | 57 | | 64 | 4,5 | | 50 | 5,5 |

Einsätze / Inserts / Inserts: 1.4: H-BE 16 / 1.5: H-EE 32 / 1.6: H-BS 6 / 1.7: H-BVE 6 / 1.8: H-D 40 / 1.9: H-DD 72 / 1.10: MC 16

Kabelverschraubung / Cable gland / Presse-étoupe: 5.1: Metr. & PG

3.2 EPIC® D A - V I N C I H - B

Sockelgehäuse / Surface mount base / Embase en saillie



PG / M

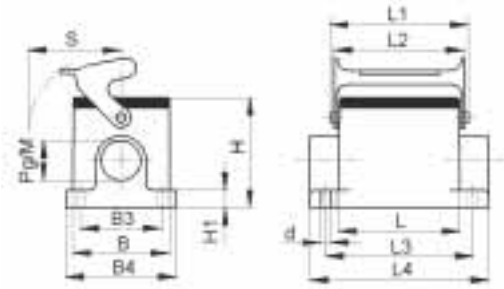

EPIC® H-B Gehäuse: Sockelgehäuse (1 Kabeleingang, Längsbügel)

EPIC® H-B housings: surface mount base (1 cable entry, single locking lever)

Boîtiers EPIC® H-B: embase en saillie (1 entrée de câble, simple levier)

H-B 24

| Artikel part article | Art.Nr. part No. N° art. | PG | M | L | L1 | L2 | L3 | L4 | B | B1 | B2 | B3 | B4 | B5 | H | H1 | H2 | S | d |
|----------------------------|--------------------------------|----|----|-----|-----|-------|-----|-----|----|----|----|----|----|----|----|-----|----|----|-----|
| H-B 24 SGR-LB 21 | 10104900 | 21 | | 120 | 138 | 136,5 | 132 | 144 | 43 | | | 45 | 57 | | 64 | 4,5 | | 50 | 5,5 |
| H-B 24 SGR-LB M25 | 19104900 | | 25 | 120 | 138 | 136,5 | 132 | 144 | 43 | | | 45 | 57 | | 64 | 4,5 | | 50 | 5,5 |

Einsätze / Inserts / Inserts: 1.4: H-BE 24 / 1.5: H-EE 46 / 1.7: H-BVE 10 / 1.8: H-D 64 / 1.9: H-DD 108 / 1.10: MC 24
Kabelverschraubung / Cable gland / Presse-étoupe: 5.1: Metr. & PG

H-B 48

| Artikel part article | Art.Nr. part No. N° art. | PG | M | L | L1 | L2 | L3 | L4 | B | B1 | B2 | B3 | B4 | B5 | H | H1 | H2 | S | d |
|----------------------------|--------------------------------|----|----|---|-----|-----|-------|-----|-----|----|----|-----|-----|----|-----|----|----|-----|-----|
| H-B 48 SGR 29 | 10165000 | 29 | | | 132 | 152 | 139,5 | 111 | 132 | 90 | | 106 | 120 | | 100 | 12 | | 105 | 6,5 |
| H-B 48 SGR 36 | 10165100 | 36 | | | | | | | | | | | | | | | | | |
| H-B 48 SGR M32 | 19165000 | | 32 | | 132 | 152 | 139,5 | 111 | 132 | 90 | | 106 | 120 | | 100 | 12 | | 105 | 6,5 |
| H-B 48 SGR M40 | 19165100 | | 40 | | | | | | | | | | | | | | | | |

Einsätze / Inserts / Inserts: 1.4: H-BE 48 / 1.5: H-EE 92 / 1.7: 2 x H-BVE 10 / 1.8: H-D 128 / 1.9: H-DD 216 / 1.10: 2 x MC 24
Kabelverschraubung / Cable gland / Presse-étoupe: 5.1: Metr. & PG

3.2 EPIC® D A - V I N C I H - B

Sockelgehäuse / Surface mount base / Embase en saillie



PG / M

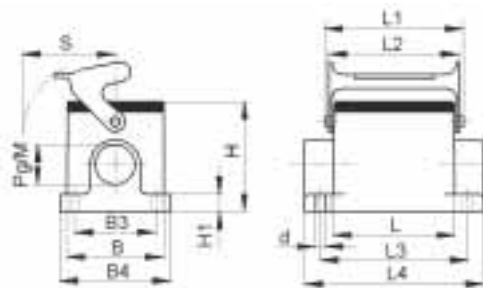

EPIC® H-B Gehäuse: Sockelgehäuse (1 Kabeleingang, Längsbügel, hohe Bauform)

EPIC® H-B housings: surface mount base (1 cable entry, single locking lever, high version)

Boîtiers EPIC® H-B: embase en saillie (1 entrée de câble, simple levier, version haute)

H-B 6

| Artikel part article | Art.Nr. part No. N° art. | PG | M | L | L1 | L2 | L3 | L4 | B | B1 | B2 | B3 | B4 | B5 | H | H1 | H2 | S | d | |
|----------------------------|--------------------------------|----|----|----|------|----|----|----|----|----|----|----|----|----|----|----|----|----|-----|--|
| H-B 6 SGRH-LB 21 | 70005200 | 21 | | 60 | 74,8 | 70 | 70 | 84 | 43 | | | 45 | 58 | | 74 | 6 | | 44 | 5,5 | |
| H-B 6 SGRH-LB 29 | 70005400 | 29 | | | | | | | | | | | | | | | | | | |
| H-B 6 SGRH-LB M25 | 79005200 | | 25 | 60 | 74,8 | 70 | 70 | 84 | 43 | | | 45 | 58 | | 74 | 6 | | 44 | 5,5 | |
| H-B 6 SGRH-LB M32 | 79005400 | | 32 | | | | | | | | | | | | | | | | | |

Einsätze / Inserts / Inserts: 1.4: H-BE 6 / 1.5: H-EE 10 / 1.9: H-DD 24 / 1.10: MC 6

Deckel / Cover / Couvercle: 6.1: H-B 6

Kabelverschraubung / Cable gland / Presse-étoupe: 5.1: Metr. & PG

H-B 10

| Artikel part article | Art.Nr. part No. N° art. | PG | M | L | L1 | L2 | L3 | L4 | B | B1 | B2 | B3 | B4 | B5 | H | H1 | H2 | S | d | |
|----------------------------|--------------------------------|----|----|----|----|------|----|----|----|----|----|----|----|----|----|----|----|----|-----|--|
| H-B 10 SGRH-LB 21 | 70060200 | 21 | | 73 | 91 | 88,5 | 82 | 97 | 43 | | | 45 | 58 | | 74 | 6 | | 50 | 5,5 | |
| H-B 10 SGRH-LB 29 | 70060400 | 29 | | | | | | | | | | | | | | | | | | |
| H-B 10 SGRH-LB M25 | 79060200 | | 25 | 73 | 91 | 88,5 | 82 | 97 | 43 | | | 45 | 58 | | 74 | 6 | | 50 | 5,5 | |
| H-B 10 SGRH-LB M32 | 79060400 | | 32 | | | | | | | | | | | | | | | | | |

Einsätze / Inserts / Inserts: 1.4: H-BE 10 / 1.5: H-EE 18 / 1.7: H-BVE 3 / 1.9: H-DD 42 / 1.10: MC 10

Kabelverschraubung / Cable gland / Presse-étoupe: 5.1: Metr. & PG

3.2 EPIC® D A - V I N C I H - B

Sockelgehäuse / Surface mount base / Embase en saillie



PG / M

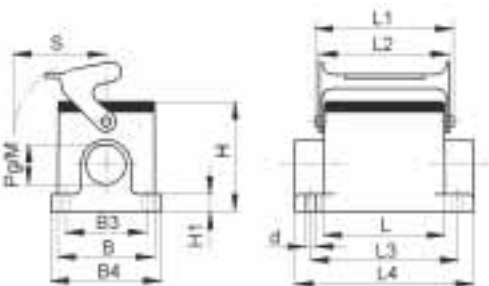

EPIC® H-B Gehäuse: Sockelgehäuse (1 Kabeleingang, Längsbügel, hohe Bauform)

EPIC® H-B housings: surface mount base (1 cable entry, single locking lever, high version)

Boîtiers EPIC® H-B: embase en saillie (1 entrée de câble, simple levier, version haute)

H-B 16

| Artikel part article | Art.Nr. part No. N° art. | PG | M | L | L1 | L2 | L3 | L4 | B | B1 | B2 | B3 | B4 | B5 | H | H1 | H2 | S | d |
|----------------------------|--------------------------------|----|----|------|-----|-------|-----|-----|----|----|----|----|----|----|----|----|----|----|-----|
| H-B 16 SGRH-LB 21 | 70110200 | 21 | | 93,3 | 111 | 109,5 | 105 | 117 | 43 | | | 45 | 58 | | 84 | 6 | | 50 | 5,5 |
| H-B 16 SGRH-LB 29 | 70110400 | 29 | | | | | | | | | | | | | | | | | |
| H-B 16 SGRH-LB M25 | 79110200 | | 25 | 93,3 | 111 | 109,5 | 105 | 117 | 43 | | | 45 | 58 | | 84 | 6 | | 50 | 5,5 |
| H-B 16 SGRH-LB M32 | 79110400 | | 32 | | | | | | | | | | | | | | | | |

Einsätze / Inserts / Inserts: 1.4: H-BE 16 / 1.5: H-EE 32 / 1.6: H-BS 6 / 1.7: H-BVE 6 / 1.8: H-D 40 / 1.9: H-DD 72 / 1.10: MC 16
Kabelverschraubung / Cable gland / Presse-étoupe: 5.1: Metr. & PG

H-B 24

| Artikel part article | Art.Nr. part No. N° art. | PG | M | L | L1 | L2 | L3 | L4 | B | B1 | B2 | B3 | B4 | B5 | H | H1 | H2 | S | d |
|----------------------------|--------------------------------|----|----|-----|-----|-------|-----|-----|----|----|----|----|----|----|----|----|----|----|-----|
| H-B 24 SGRH-LB 21 | 70160200 | 21 | | 120 | 138 | 136,5 | 132 | 144 | 43 | | | 45 | 58 | | 84 | 6 | | 50 | 5,5 |
| H-B 24 SGRH-LB 29 | 70160400 | 29 | | | | | | | | | | | | | | | | | |
| H-B 24 SGRH-LB M25 | 79160200 | | 25 | 120 | 138 | 136,5 | 132 | 144 | 43 | | | 45 | 58 | | 84 | 6 | | 50 | 5,5 |
| H-B 24 SGRH-LB M32 | 79160400 | | 32 | | | | | | | | | | | | | | | | |

Einsätze / Inserts / Inserts: 1.4: H-BE 24 / 1.5: H-EE 46 / 1.7: H-BVE 10 / 1.8: H-D 64 / 1.9: H-DD 108 / 1.10: MC 24
Kabelverschraubung / Cable gland / Presse-étoupe: 5.1: Metr. & PG

3.2 EPIC® D A - V I N C I H - B

Sockelgehäuse / Surface mount base / Embase en saillie



PG / M

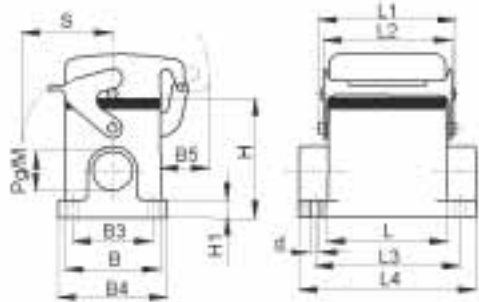

EPIC® H-B Gehäuse: Sockelgehäuse (Schutzdeckel, 2 Kabeleingänge, Längsbügel)

EPIC® H-B housings: surface mount base (cover, 2 cable entries, single locking lever)

Boîtiers EPIC® H-B: embase en saillie (couvercle, 2 entrées de câble, simple levier)

H-B 6

| Artikel part article | Art.Nr. part No. N° art. | PG | M | L | L1 | L2 | L3 | L4 | B | B1 | B2 | B3 | B4 | B5 | H | H1 | H2 | S | d |
|----------------------------|--------------------------------|----|----|----|------|----|----|----|----|----|----|----|----|----|----|-----|----|----|-----|
| H-B 6 SDRL-LB 16 | 10009000 | 16 | | 60 | 74,8 | 70 | 70 | 84 | 43 | | | 40 | 52 | 25 | 57 | 4,5 | | 44 | 5,5 |
| H-B 6 SDRL-LB M20 | 19009000 | | 20 | 60 | 74,8 | 70 | 70 | 84 | 43 | | | 40 | 52 | 25 | 57 | 4,5 | | 44 | 5,5 |
| H-B 6 SDRL-LB M25 | 79016600 | | 25 | | | | | | | | | | | | | | | | |

Einsätze / Inserts / Inserts: 1.4: H-BE 6 / 1.5: H-EE 10 / 1.9: H-DD 24 / 1.10: MC 6
Kabelverschraubung / Cable gland / Presse-étoupe: 5.1: Metr. & PG

H-B 10

| Artikel part article | Art.Nr. part No. N° art. | PG | M | L | L1 | L2 | L3 | L4 | B | B1 | B2 | B3 | B4 | B5 | H | H1 | H2 | S | d |
|----------------------------|--------------------------------|----|----|----|----|------|----|----|----|----|----|----|----|----|----|-----|----|----|-----|
| H-B 10 SDRL-LB 16 | 10038900 | 16 | | 73 | 91 | 88,5 | 82 | 94 | 43 | | | 40 | 52 | 25 | 57 | 4,5 | | 50 | 5,5 |
| H-B 10 SDRL-LB M20 | 19038900 | | 20 | 73 | 91 | 88,5 | 82 | 94 | 43 | | | 40 | 52 | 25 | 57 | 4,5 | | 50 | 5,5 |
| H-B 10 SDRL-LB M25 | 79065600 | | 25 | 73 | 91 | 88,5 | 82 | 94 | 43 | | | 40 | 52 | 25 | 57 | 4,5 | | 50 | 5,5 |

Einsätze / Inserts / Inserts: 1.4: H-BE 10 / 1.5: H-EE 18 / 1.7: H-BVE 3 / 1.9: H-DD 42 / 1.10: MC 10
Kabelverschraubung / Cable gland / Presse-étoupe: 5.1: Metr. & PG

H-B 16

| Artikel part article | Art.Nr. part No. N° art. | PG | M | L | L1 | L2 | L3 | L4 | B | B1 | B2 | B3 | B4 | B5 | H | H1 | H2 | S | d |
|----------------------------|--------------------------------|----|----|----|-----|-------|-----|-----|----|----|----|----|----|----|----|-----|----|----|-----|
| H-B 16 SDRL-LB 21 | 10078900 | 21 | | 93 | 111 | 109,5 | 105 | 117 | 43 | | | 45 | 57 | 25 | 64 | 4,5 | | 50 | 5,5 |
| H-B 16 SDRL-LB M25 | 19078900 | | 25 | 93 | 111 | 109,5 | 105 | 117 | 43 | | | 45 | 57 | 25 | 64 | 4,5 | | 50 | 5,5 |

Einsätze / Inserts / Inserts: 1.4: H-BE 16 / 1.5: H-EE 32 / 1.6: H-BS 6 / 1.7: H-BVE 6 / 1.8: H-D 40 / 1.9: H-DD 72 / 1.10: MC 16
Kabelverschraubung / Cable gland / Presse-étoupe: 5.1: Metr. & PG

3.2 EPIC® D A - V I N C I H - B

Sockelgehäuse / Surface mount base / Embase en saillie



PG / M

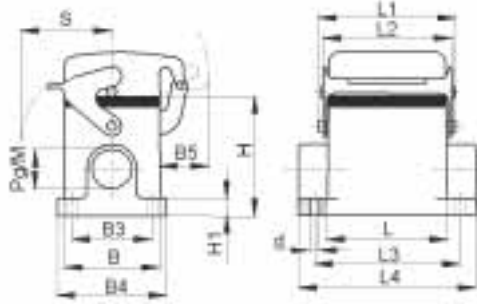

EPIC® H-B Gehäuse: Sockelgehäuse (Schutzdeckel, 2 Kabeleingänge, Längsbügel)

EPIC® H-B housings: surface mount base (cover, 2 cable entries, single locking lever)

Boîtiers EPIC® H-B: embase en saillie (couverture, 2 entrées de câble, simple levier)

H-B 24

| Artikel part article | Art.Nr. part No. N° art. | PG | M | L | L1 | L2 | L3 | L4 | B | B1 | B2 | B3 | B4 | B5 | H | H1 | H2 | S | d |
|----------------------------|--------------------------------|----|----|-----|-----|-------|-----|-----|----|----|----|----|----|----|----|-----|----|----|-----|
| H-B 24 SDRL-LB 21 | 10109900 | | 21 | 120 | 138 | 136,5 | 132 | 144 | 43 | | | 45 | 57 | 25 | 64 | 4,5 | | 50 | 5,5 |
| H-B 24 SDRL-LB M25 | 19109900 | | 25 | 120 | 138 | 136,5 | 132 | 144 | 43 | | | 45 | 57 | 25 | 64 | 4,5 | | 50 | 5,5 |

Einsätze / Inserts / Inserts: 1.4: H-BE 24 / 1.5: H-EE 46 / 1.7: H-BVE 10 / 1.8: H-D 64 / 1.9: H-DD 108 / 1.10: MC 24

Kabelverschraubung / Cable gland / Presse-étoupe: 5.1: Metr. & PG

H-B 48

| Artikel part article | Art.Nr. part No. N° art. | PG | M | L | L1 | L2 | L3 | L4 | B | B1 | B2 | B3 | B4 | B5 | H | H1 | H2 | S | d |
|----------------------------|--------------------------------|----|----|---|-----|-----|-------|-----|-----|----|----|-----|-----|----|-----|----|----|-----|-----|
| H-B 48 SDRL 29 | 10168000 | | 29 | | 132 | 152 | 139,5 | 111 | 132 | 90 | | 106 | 120 | 30 | 100 | 12 | | 105 | 6,5 |
| H-B 48 SDRL 36 | 10168100 | | 36 | | 132 | 152 | 139,5 | 111 | 132 | 90 | | 106 | 120 | 30 | 100 | 12 | | 105 | 6,5 |
| H-B 48 SDRL M32 | 19168000 | | 32 | | 132 | 152 | 139,5 | 111 | 132 | 90 | | 106 | 120 | 30 | 100 | 12 | | 105 | 6,5 |
| H-B 48 SDRL M40 | 19168100 | | 40 | | 132 | 152 | 139,5 | 111 | 132 | 90 | | 106 | 120 | 30 | 100 | 12 | | 105 | 6,5 |

Einsätze / Inserts / Inserts: 1.4: H-BE 48 / 1.5: H-EE 92 / 1.7: 2 x H-BVE 10 / 1.8: H-D 128 / 1.9: H-DD 216 / 1.10: 2 x MC 24

Kabelverschraubung / Cable gland / Presse-étoupe: 5.1: Metr. & PG

3.2 EPIC® D A - V I N C I H - B

Sockelgehäuse / Surface mount base / Embase en saillie



PG / M

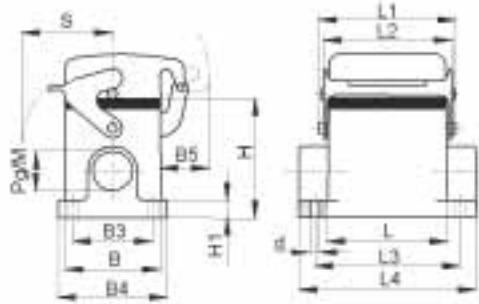

EPIC® H-B Gehäuse: Sockelgehäuse (Schutzdeckel, 2 Kabeleingänge, Längsbügel, hohe Bauform)

EPIC® H-B housings: surface mount base (cover, 2 cable entries, single locking lever, high version)

Boîtiers EPIC® H-B: embase en saillie (couvercle, 2 entrées de câble, simple levier, version haute)

H-B 6

| Artikel part article | Art.Nr. part No. N° art. | PG | M | L | L1 | L2 | L3 | L4 | B | B1 | B2 | B3 | B4 | B5 | H | H1 | H2 | S | d |
|----------------------------|--------------------------------|----|----|----|------|----|----|----|----|----|----|----|----|----|----|----|----|----|-----|
| H-B 6 SDRHL-LB 21 | 70016200 | 21 | | 60 | 74,8 | 70 | 70 | 84 | 43 | | | 45 | 58 | 25 | 74 | 6 | | 44 | 5,5 |
| H-B 6 SDRHL-LB 29 | 70016400 | 29 | | | | | | | | | | | | | | | | | |
| H-B 6 SDRHL-LB M25 | 79016200 | | 25 | 60 | 74,8 | 70 | 70 | 84 | 43 | | | 45 | 58 | 25 | 74 | 6 | | 44 | 5,5 |
| H-B 6 SDRHL-LB M32 | 79016400 | | 32 | | | | | | | | | | | | | | | | |

Einsätze / Inserts / Inserts: 1.4: H-BE 6 / 1.5: H-EE 10 / 1.9: H-DD 24 / 1.10: MC 6

Kabelverschraubung / Cable gland / Presse-étoupe: 5.1: Metr. & PG

H-B 10

| Artikel part article | Art.Nr. part No. N° art. | PG | M | L | L1 | L2 | L3 | L4 | B | B1 | B2 | B3 | B4 | B5 | H | H1 | H2 | S | d |
|----------------------------|--------------------------------|----|----|----|----|------|----|----|----|----|----|----|----|----|----|----|----|----|-----|
| H-B 10 SDRHL-LB 21 | 70065200 | 21 | | 73 | 91 | 88,5 | 82 | 97 | 43 | | | 45 | 58 | 25 | 74 | 6 | | 50 | 5,5 |
| H-B 10 SDRHL-LB 29 | 70065400 | 29 | | | | | | | | | | | | | | | | | |
| H-B 10 SDRHL-LB M25 | 79065200 | | 25 | 73 | 91 | 88,5 | 82 | 97 | 43 | | | 45 | 58 | 25 | 74 | 6 | | 50 | 5,5 |
| H-B 10 SDRHL-LB M32 | 79065400 | | 32 | | | | | | | | | | | | | | | | |

Einsätze / Inserts / Inserts: 1.4: H-BE 10 / 1.5: H-EE 18 / 1.7: H-BVE 3 / 1.9: H-DD 42 / 1.10: MC 10

Kabelverschraubung / Cable gland / Presse-étoupe: 5.1: Metr. & PG

3.2 EPIC® D A - V I N C I H - B

Sockelgehäuse / Surface mount base / Embase en saillie



PG / M

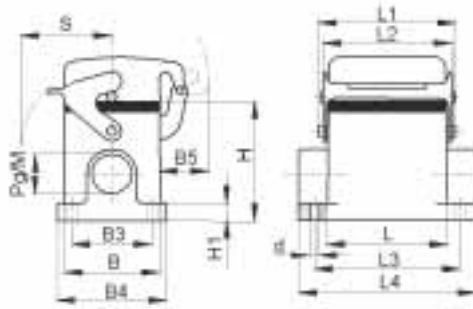

EPIC® H-B Gehäuse: Sockelgehäuse (Schutzdeckel, 2 Kabeleingänge, Längsbügel, hohe Bauform)

EPIC® H-B housings: surface mount base (cover, 2 cable entries, single locking lever, high version)

Boîtiers EPIC® H-B: embase en saillie (couverture, 2 entrées de câble, simple levier, version haute)

H-B 16

| Artikel part article | Art.Nr. part No. N° art. | PG | M | L | L1 | L2 | L3 | L4 | B | B1 | B2 | B3 | B4 | B5 | H | H1 | H2 | S | d |
|----------------------------|--------------------------------|----|----|------|-----|-------|-----|-----|----|----|----|----|----|----|----|----|----|----|-----|
| H-B 16 SDRLH-LB 21 | 70115200 | 21 | | 93,3 | 111 | 109,5 | 105 | 117 | 43 | | | 45 | 58 | 25 | 84 | 6 | | 50 | 5,5 |
| H-B 16 SDRLH-LB 29 | 70115400 | 29 | | | | | | | | | | | | | | | | | |
| H-B 16 SDRLH-LB M25 | 79115200 | | 25 | 93,3 | 111 | 109,5 | 105 | 117 | 43 | | | 45 | 58 | 25 | 84 | 6 | | 50 | 5,5 |
| H-B 16 SDRLH-LB M32 | 79115400 | | 32 | | | | | | | | | | | | | | | | |

Einsätze / Inserts / Inserts: 1.4: H-BE 16 / 1.5: H-EE 32 / 1.6: H-BS 6 / 1.7: H-BVE 6 / 1.8: H-D 40 / 1.9: H-DD 72 / 1.10: MC 16
Kabelverschraubung / Cable gland / Presse-étoupe: 5.1: Metr. & PG

H-B 24

| Artikel part article | Art.Nr. part No. N° art. | PG | M | L | L1 | L2 | L3 | L4 | B | B1 | B2 | B3 | B4 | B5 | H | H1 | H2 | S | d |
|----------------------------|--------------------------------|----|----|-----|-----|-------|-----|-----|----|----|----|----|----|----|----|----|----|----|-----|
| H-B 24 SDRLH-LB 21 | 70165200 | 21 | | 120 | 138 | 136,5 | 132 | 144 | 43 | | | 45 | 58 | 25 | 84 | 6 | | 50 | 5,5 |
| H-B 24 SDRLH-LB 29 | 70165400 | 29 | | | | | | | | | | | | | | | | | |
| H-B 24 SDRLH-LB M25 | 79165200 | | 25 | 120 | 138 | 136,5 | 132 | 144 | 43 | | | 45 | 58 | 25 | 84 | 6 | | 50 | 5,5 |
| H-B 24 SDRLH-LB M32 | 79165400 | | 32 | | | | | | | | | | | | | | | | |

Einsätze / Inserts / Inserts: 1.4: H-BE 24 / 1.5: H-EE 46 / 1.7: H-BVE 10 / 1.8: H-D 64 / 1.9: H-DD 108 / 1.10: MC 24
Kabelverschraubung / Cable gland / Presse-étoupe: 5.1: Metr. & PG

3.2 EPIC® D A - V I N C I H - B

Sockelgehäuse / Surface mount base / Embase en saillie



PG / M

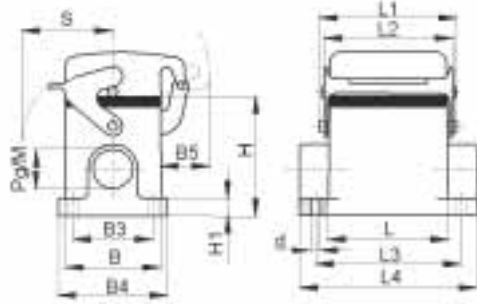

EPIC® H-B Gehäuse: Sockelgehäuse (Schutzdeckel, 1 Kabeleingang, Längsbügel)

EPIC® H-B housings: surface mount base (cover, 1 cable entry, single locking lever)

Boîtiers EPIC® H-B: embase en saillie (couvercle, 1 entrée de câble, simple levier)

H-B 6

| Artikel part article | Art.Nr. part No. N° art. | PG | M | L | L1 | L2 | L3 | L4 | B | B1 | B2 | B3 | B4 | B5 | H | H1 | H2 | S | d |
|----------------------------|--------------------------------|----|----|----|------|----|----|----|----|----|----|----|----|----|----|-----|----|----|-----|
| H-B 6 SDR 16 | 10007000 | 16 | | 60 | 74,8 | 70 | 70 | 84 | 43 | | | 40 | 52 | 25 | 57 | 4,5 | | 44 | 5,5 |
| H-B 6 SDR M20 | 19007000 | | 20 | 60 | 74,8 | 70 | 70 | 84 | 43 | | | 40 | 52 | 25 | 57 | 4,5 | | 44 | 5,5 |
| H-B 6 SDR M25 | 79015600 | | 25 | | | | | | | | | | | | | | | | |

Einsätze / Inserts / Inserts: 1.4: H-BE 6 / 1.5: H-EE 10 / 1.9: H-DD 24 / 1.10: MC 6
Kabelverschraubung / Cable gland / Presse-étoupe: 5.1: Metr. & PG

H-B 10

| Artikel part article | Art.Nr. part No. N° art. | PG | M | L | L1 | L2 | L3 | L4 | B | B1 | B2 | B3 | B4 | B5 | H | H1 | H2 | S | d |
|----------------------------|--------------------------------|----|----|----|----|------|----|----|----|----|----|----|----|----|----|-----|----|----|-----|
| H-B 10 SDR-LB 16 | 10036900 | 16 | | 73 | 91 | 88,5 | 82 | 94 | 43 | | | 40 | 52 | 25 | 57 | 4,5 | | 50 | 5,5 |
| H-B 10 SDR-LB M20 | 19036900 | | 20 | 73 | 91 | 88,5 | 82 | 94 | 43 | | | 40 | 52 | 25 | 57 | 4,5 | | 50 | 5,5 |
| H-B 10 SDR-LB M25 | 79064600 | | 25 | | | | | | | | | | | | | | | | |

Einsätze / Inserts / Inserts: 1.4: H-BE 10 / 1.5: H-EE 18 / 1.7: H-BVE 3 / 1.9: H-DD 42 / 1.10: MC 10
Kabelverschraubung / Cable gland / Presse-étoupe: 5.1: Metr. & PG

H-B 16

| Artikel part article | Art.Nr. part No. N° art. | PG | M | L | L1 | L2 | L3 | L4 | B | B1 | B2 | B3 | B4 | B5 | H | H1 | H2 | S | d |
|----------------------------|--------------------------------|----|----|----|-----|-------|-----|-----|----|----|----|----|----|----|----|-----|----|----|-----|
| H-B 16 SDR-LB 21 | 10076900 | 21 | | 93 | 111 | 109,5 | 105 | 117 | 43 | | | 45 | 57 | 25 | 64 | 4,5 | | 50 | 5,5 |
| H-B 16 SDR-LB M25 | 19076900 | | 25 | 93 | 111 | 109,5 | 105 | 117 | 43 | | | 45 | 57 | 25 | 64 | 4,5 | | 50 | 5,5 |

Einsätze / Inserts / Inserts: 1.4: H-BE 16 / 1.5: H-EE 32 / 1.6: H-BS 6 / 1.7: H-BVE 6 / 1.8: H-D 40 / 1.9: H-DD 72 / 1.10: MC 16
Kabelverschraubung / Cable gland / Presse-étoupe: 5.1: Metr. & PG

3.2 EPIC® D A - V I N C I H - B

Sockelgehäuse / Surface mount base / Embase en saillie



PG / M

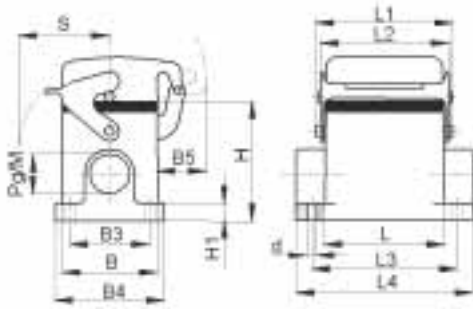

EPIC® H-B Gehäuse: Sockelgehäuse (Schutzdeckel, 1 Kabeleingang, Längsbügel)

EPIC® H-B housings: surface mount base (cover, 1 cable entry, single locking lever)

Boîtiers EPIC® H-B: embase en saillie (couverture, 1 entrée de câble, simple levier)

H-B 24

| Artikel part article | Art.Nr. part No. N° art. | PG | M | L | L1 | L2 | L3 | L4 | B | B1 | B2 | B3 | B4 | B5 | H | H1 | H2 | S | d |
|----------------------------|--------------------------------|----|----|-----|-----|-------|-----|-----|----|----|----|----|----|----|----|-----|----|----|-----|
| H-B 24 SDR-LB 21 | 10107900 | | 21 | 120 | 138 | 136,5 | 132 | 144 | 43 | | | 45 | 57 | 25 | 64 | 4,5 | | 50 | 5,5 |
| H-B 24 SDR-LB M25 | 19107900 | | 25 | 120 | 138 | 136,5 | 132 | 144 | 43 | | | 45 | 57 | 25 | 64 | 4,5 | | 50 | 5,5 |

Einsätze / Inserts / Inserts: 1.4: H-BE 24 / 1.5: H-EE 46 / 1.7: H-BVE 10 / 1.8: H-D 64 / 1.9: H-DD 108 / 1.10: MC 24
Kabelverschraubung / Cable gland / Presse-étoupe: 5.1: Metr. & PG

H-B 48

| Artikel part article | Art.Nr. part No. N° art. | PG | M | L | L1 | L2 | L3 | L4 | B | B1 | B2 | B3 | B4 | B5 | H | H1 | H2 | S | d |
|----------------------------|--------------------------------|----|----|---|-----|-----|-------|-----|-----|----|----|-----|-----|----|-----|----|----|-----|-----|
| H-B 48 SDR 29 | 10167000 | | 29 | | 132 | 152 | 139,5 | 111 | 132 | 90 | | 106 | 120 | 30 | 100 | 12 | | 105 | 6,5 |
| H-B 48 SDR 36 | 10167100 | | 36 | | 132 | 152 | 139,5 | 111 | 132 | 90 | | 106 | 120 | 30 | 100 | 12 | | 105 | 6,5 |
| H-B 48 SDR M32 | 19167000 | | 32 | | 132 | 152 | 139,5 | 111 | 132 | 90 | | 106 | 120 | 30 | 100 | 12 | | 105 | 6,5 |
| H-B 48 SDR M 40 | 19167100 | | 40 | | 132 | 152 | 139,5 | 111 | 132 | 90 | | 106 | 120 | 30 | 100 | 12 | | 105 | 6,5 |

Einsätze / Inserts / Inserts: 1.4: H-BE 48 / 1.5: H-EE 92 / 1.7: 2 x H-BVE 10 / 1.8: H-D 128 / 1.9: H-DD 216 / 1.10: 2 x MC 24
Kabelverschraubung / Cable gland / Presse-étoupe: 5.1: Metr. & PG

3.2 EPIC® D A - V I N C I H - B

Sockelgehäuse / Surface mount base / Embase en saillie



PG / M

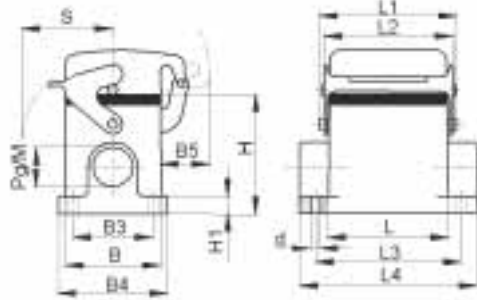

EPIC® H-B Gehäuse: Sockelgehäuse (Schutzdeckel, 1 Kabeleingang, Längsbügel, hohe Bauform)

EPIC® H-B housings: surface mount base (cover, 1 cable entry, single locking lever, high version)

Boîtiers EPIC® H-B: embase en saillie (couvercle, 1 entrée de câble, simple levier, version haute)

H-B 6

| Artikel part article | Art.Nr. part No. N° art. | PG | M | L | L1 | L2 | L3 | L4 | B | B1 | B2 | B3 | B4 | B5 | H | H1 | H2 | S | d |
|----------------------------|--------------------------------|----|----|----|------|----|----|----|----|----|----|----|----|----|----|----|----|----|-----|
| H-B 6 SDRH 21 | 70015200 | 21 | | 60 | 74,8 | 70 | 70 | 84 | 43 | | | 45 | 58 | 25 | 74 | 6 | | 44 | 5,5 |
| H-B 6 SDRH 29 | 70015400 | 29 | | | | | | | | | | | | | | | | | |
| H-B 6 SDRH M25 | 79015200 | | 25 | 60 | 74,8 | 70 | 70 | 84 | 43 | | | 45 | 58 | 25 | 74 | 6 | | 44 | 5,5 |
| H-B 6 SDRH M32 | 79015400 | | 32 | | | | | | | | | | | | | | | | |

Einsätze / Inserts / Inserts: 1.4: H-BE 6 / 1.5: H-EE 10 / 1.9: H-DD 24 / 1.10: MC 6

Kabelverschraubung / Cable gland / Presse-étoupe: 5.1: Metr. & PG

H-B 10

| Artikel part article | Art.Nr. part No. N° art. | PG | M | L | L1 | L2 | L3 | L4 | B | B1 | B2 | B3 | B4 | B5 | H | H1 | H2 | S | d |
|----------------------------|--------------------------------|----|----|----|----|------|----|----|----|----|----|----|----|----|----|----|----|----|-----|
| H-B 10 SDRH-LB 21 | 70064200 | 21 | | 73 | 91 | 88,5 | 82 | 97 | 43 | | | 45 | 58 | 25 | 74 | 6 | | 50 | 5,5 |
| H-B 10 SDRH-LB 29 | 70064400 | 29 | | | | | | | | | | | | | | | | | |
| H-B 10 SDRH-LB M25 | 79064200 | | 25 | 73 | 91 | 88,5 | 82 | 97 | 43 | | | 45 | 58 | 25 | 74 | 6 | | 50 | 5,5 |
| H-B 10 SDRH-LB M32 | 79064400 | | 32 | | | | | | | | | | | | | | | | |

Einsätze / Inserts / Inserts: 1.4: H-BE 10 / 1.5: H-EE 18 / 1.7: H-BVE 3 / 1.9: H-DD 42 / 1.10: MC 10

Kabelverschraubung / Cable gland / Presse-étoupe: 5.1: Metr. & PG

3.2 EPIC® D A - V I N C I H - B

Sockelgehäuse / Surface mount base / Embase en saillie



PG / M

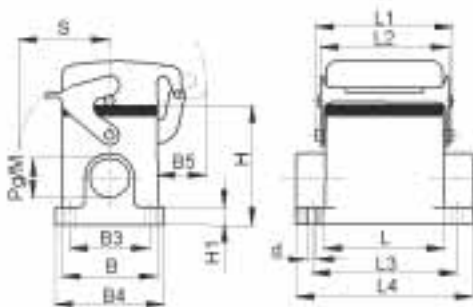

EPIC® H-B Gehäuse: Sockelgehäuse (Schutzdeckel, 1 Kabeleingang, Längsbügel, hohe Bauform)

EPIC® H-B housings: surface mount base (cover, 1 cable entry, single locking lever, high version)

Boîtiers EPIC® H-B: embase en saillie (couverture, 1 entrée de câble, simple levier, version haute)

H-B 16

| Artikel part article | Art.Nr. part No. N° art. | PG | M | L | L1 | L2 | L3 | L4 | B | B1 | B2 | B3 | B4 | B5 | H | H1 | H2 | S | d |
|----------------------------|--------------------------------|----|----|------|-----|-------|-----|-----|----|----|----|----|----|----|----|----|----|----|-----|
| H-B 16 SDRH-LB 21 | 70114200 | 21 | | 93,3 | 111 | 109,5 | 105 | 117 | 43 | | | 45 | 58 | 25 | 84 | 6 | | 50 | 5,5 |
| H-B 16 SDRH-LB 29 | 70114400 | 29 | | | | | | | | | | | | | | | | | |
| H-B 16 SDRH-LB M25 | 79114200 | | 25 | 93,3 | 111 | 109,5 | 105 | 117 | 43 | | | 45 | 58 | 25 | 84 | 6 | | 50 | 5,5 |
| H-B 16 SDRH-LB M32 | 79114400 | | 32 | | | | | | | | | | | | | | | | |

Einsätze / Inserts / Inserts: 1.4: H-BE 16 / 1.5: H-EE 32 / 1.6: H-BS 6 / 1.7: H-BVE 6 / 1.8: H-D 40 / 1.9: H-DD 72 / 1.10: MC 16
Kabelverschraubung / Cable gland / Presse-étoupe: 5.1: Metr. & PG

H-B 24

| Artikel part article | Art.Nr. part No. N° art. | PG | M | L | L1 | L2 | L3 | L4 | B | B1 | B2 | B3 | B4 | B5 | H | H1 | H2 | S | d |
|----------------------------|--------------------------------|----|----|-----|-----|-------|-----|-----|----|----|----|----|----|----|----|----|----|----|-----|
| H-B 24 SDRH-LB 21 | 70164200 | 21 | | 120 | 138 | 136,5 | 132 | 144 | 43 | | | 45 | 58 | 25 | 84 | 6 | | 50 | 5,5 |
| H-B 24 SDRH-LB 29 | 70164400 | 29 | | | | | | | | | | | | | | | | | |
| H-B 24 SDRH-LB M25 | 79164200 | | 25 | 120 | 138 | 136,5 | 132 | 144 | 43 | | | 45 | 58 | 25 | 84 | 6 | | 50 | 5,5 |
| H-B 24 SDRH-LB M32 | 79164400 | | 32 | | | | | | | | | | | | | | | | |

Einsätze / Inserts / Inserts: 1.4: H-BE 24 / 1.5: H-EE 46 / 1.7: H-BVE 10 / 1.8: H-D 64 / 1.9: H-DD 108 / 1.10: MC 24
Kabelverschraubung / Cable gland / Presse-étoupe: 5.1: Metr. & PG

3

3.2 EPIC® D A - V I N C I H - B

Sockelgehäuse / Surface mount base / Embase en saillie

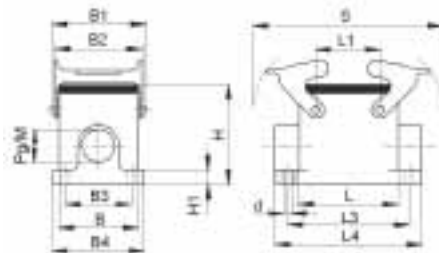

PG / M

EPIC® H-B Gehäuse: Sockelgehäuse (2 Kabeleingänge, Querbügel)
EPIC® H-B housings: surface mount base (2 cable entries, double locking lever)
Boîtiers EPIC® H-B: embase en saillie (2 entrées de câble, double levier)

H-B 10

| Artikel part article | Art.Nr. part No. N° art. | PG | M | L | L1 | L2 | L3 | L4 | B | B1 | B2 | B3 | B4 | B5 | H | H1 | H2 | S | d |
|----------------------------|--------------------------------|----|----|----|----|----|----|----|----|------|----|----|----|----|----|-----|----|-----|-----|
| H-B 10 SGRL 16 | 10035000 | 16 | | 73 | 27 | | 82 | 94 | 43 | 57,8 | 53 | 40 | 52 | | 57 | 4,5 | | 116 | 5,5 |
| H-B 10 SGRL M20 | 19035000 | | 20 | 73 | 27 | | 82 | 94 | 43 | 57,8 | 53 | 40 | 52 | | 57 | 4,5 | | 116 | 5,5 |
| H-B 10 SGRL M25 | 19035100 | | 25 | | | | | | | | | | | | | | | | |

Einsätze / Inserts / Inserts: 1.4: H-BE 10 / 1.5: H-EE 18 / 1.7: H-BVE 3 / 1.9: H-DD 42 / 1.10: MC 10

Deckel / Cover / Couvercle: 6.1: H-B 10

Kabelverschraubung / Cable gland / Presse-étoupe: 5.1: Metr. & PG

H-B 16

| Artikel part article | Art.Nr. part No. N° art. | PG | M | L | L1 | L2 | L3 | L4 | B | B1 | B2 | B3 | B4 | B5 | H | H1 | H2 | S | d |
|----------------------------|--------------------------------|----|----|----|------|----|-----|-----|----|------|----|----|----|----|----|-----|----|-------|-----|
| H-B 16 SGRL 21 | 10075000 | 21 | | 93 | 47,5 | | 105 | 117 | 43 | 57,8 | 53 | 45 | 57 | | 64 | 4,5 | | 136,5 | 5,5 |
| H-B 16 SGRL M25 | 19075000 | | 25 | 93 | 47,5 | | 105 | 117 | 43 | 57,8 | 53 | 45 | 57 | | 64 | 4,5 | | 136,5 | 5,5 |

Einsätze / Inserts / Inserts: 1.4: H-BE 16 / 1.5: H-EE 32 / 1.6: H-BS 6 / 1.7: H-BVE 6 / 1.8: H-D 40 / 1.9: H-DD 72 / 1.10: MC 16

Deckel / Cover / Couvercle: 6.1: H-B 16

Kabelverschraubung / Cable gland / Presse-étoupe: 5.1: Metr. & PG

H-B 24

| Artikel part article | Art.Nr. part No. N° art. | PG | M | L | L1 | L2 | L3 | L4 | B | B1 | B2 | B3 | B4 | B5 | H | H1 | H2 | S | d |
|----------------------------|--------------------------------|----|----|-----|----|----|-----|-----|----|------|----|----|----|----|----|-----|----|-----|-----|
| H-B 24 SGRL 21 | 10105000 | 21 | | 120 | 74 | | 132 | 144 | 43 | 57,8 | 53 | 45 | 57 | | 64 | 4,5 | | 163 | 5,5 |
| H-B 24 SGRL M25 | 19105000 | | 25 | 120 | 74 | | 132 | 144 | 43 | 57,8 | 53 | 45 | 57 | | 64 | 4,5 | | 163 | 5,5 |

Einsätze / Inserts / Inserts: 1.4: H-BE 24 / 1.5: H-EE 46 / 1.7: H-BVE 10 / 1.8: H-D 64 / 1.9: H-DD 108 / 1.10: MC 24

Kabelverschraubung / Cable gland / Presse-étoupe: 5.1: Metr. & PG

H-B 32

| Artikel part article | Art.Nr. part No. N° art. | PG | M | L | L1 | L2 | L3 | L4 | B | B1 | B2 | B3 | B4 | B5 | H | H1 | H2 | S | d |
|----------------------------|--------------------------------|----|----|------|------|----|-----|-------|----|------|------|----|----|----|----|----|----|-------|-----|
| H-B 32 SGRL 29 | 10138000 | 29 | | | | | | | | | | | | | | | | | |
| H-B 32 SGRL M32 | 19138000 | | 32 | 93,5 | 64,5 | | 112 | 124,5 | 79 | 93,8 | 87,8 | 67 | 81 | | 72 | 5 | | 136,5 | 5,5 |
| H-B 32 SGRL M40 | 19145400 | | 40 | | | | | | | | | | | | | | | | |

Einsätze / Inserts / Inserts: 1.4: H-BE 32 / 1.5: H-EE 64 / 1.6: H-BS 12 / 1.8: H-D 80 / 1.9: H-DD 144 / 1.10: 2 x MC 16

Kabelverschraubung / Cable gland / Presse-étoupe: 5.1: Metr. & PG

3.2 EPIC® D A - V I N C I H - B

Sockelgehäuse / Surface mount base / Embase en saillie

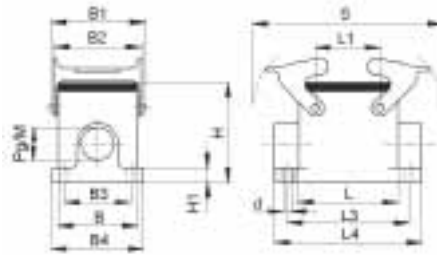

PG / M

EPIC® H-B Gehäuse: Sockelgehäuse (2 Kabeleingänge, Querbügel, hohe Bauform)

EPIC® H-B housings: surface mount base (2 cable entries, double locking lever, high version)

Boîtiers EPIC® H-B: embase en saillie (2 entrées de câble, double levier, version haute)

H-B 10

| Artikel part article | Art.Nr. part No. N° art. | PG | M | L | L1 | L2 | L3 | L4 | B | B1 | B2 | B3 | B4 | B5 | H | H1 | H2 | S | d |
|----------------------------|--------------------------------|----|----|----|----|----|----|----|----|------|----|----|----|----|----|----|----|-----|-----|
| H-B 10 SGRLH 21 | 70036200 | 21 | | 73 | 27 | | 82 | 97 | 43 | 57,8 | 53 | 45 | 58 | | 74 | 6 | | 116 | 5,5 |
| H-B 10 SGRLH 29 | 70036400 | 29 | | | | | | | | | | | | | | | | | |
| H-B 10 SGRLH M25 | 79036200 | | 25 | 73 | 27 | | 82 | 97 | 43 | 57,8 | 53 | 45 | 58 | | 74 | 6 | | 116 | 5,5 |
| H-B 10 SGRLH M32 | 79036400 | | 32 | | | | | | | | | | | | | | | | |

Einsätze / Inserts / Inserts: 1.4: H-BE 10 / 1.5: H-EE 18 / 1.7: H-BVE 3 / 1.9: H-DD 42 / 1.10: MC 10

Deckel / Cover / Couvercle: 6.1: H-B 10

Kabelverschraubung / Cable gland / Presse-étoupe: 5.1: Metr. & PG

H-B 16

| Artikel part article | Art.Nr. part No. N° art. | PG | M | L | L1 | L2 | L3 | L4 | B | B1 | B2 | B3 | B4 | B5 | H | H1 | H2 | S | d |
|----------------------------|--------------------------------|----|----|------|------|----|-----|-----|----|------|----|----|----|----|----|----|----|-------|-----|
| H-B 16 SGRLH 21 | 70086200 | 21 | | 93,3 | 47,5 | | 105 | 117 | 43 | 57,8 | 53 | 45 | 58 | | 84 | 6 | | 136,5 | 5,5 |
| H-B 16 SGRLH 29 | 70086400 | 29 | | | | | | | | | | | | | | | | | |
| H-B 16 SGRLH M25 | 79086200 | | 25 | 93,3 | 47,5 | | 105 | 117 | 43 | 57,8 | 53 | 45 | 58 | | 84 | 6 | | 136,5 | 5,5 |
| H-B 16 SGRLH M32 | 79086400 | | 32 | | | | | | | | | | | | | | | | |

Einsätze / Inserts / Inserts: 1.4: H-BE 16 / 1.5: H-EE 32 / 1.6: H-BS 6 / 1.7: H-BVE 6 / 1.8: H-D 40 / 1.9: H-DD 72 / 1.10: MC 16

Deckel / Cover / Couvercle: 6.1: H-B 16

Kabelverschraubung / Cable gland / Presse-étoupe: 5.1: Metr. & PG

H-B 24

| Artikel part article | Art.Nr. part No. N° art. | PG | M | L | L1 | L2 | L3 | L4 | B | B1 | B2 | B3 | B4 | B5 | H | H1 | H2 | S | d |
|----------------------------|--------------------------------|----|----|-----|----|----|-----|-----|----|------|----|----|----|----|----|----|----|-----|-----|
| H-B 24 SGRLH 21 | 70136200 | 21 | | 120 | 74 | | 132 | 144 | 43 | 57,8 | 53 | 45 | 58 | | 84 | 6 | | 163 | 5,5 |
| H-B 24 SGRLH 29 | 70136400 | 29 | | | | | | | | | | | | | | | | | |
| H-B 24 SGRLH M25 | 79136200 | | 25 | 120 | 74 | | 132 | 144 | 43 | 57,8 | 53 | 45 | 58 | | 84 | 6 | | 163 | 5,5 |
| H-B 24 SGRLH M32 | 79136400 | | 32 | | | | | | | | | | | | | | | | |

Einsätze / Inserts / Inserts: 1.4: H-BE 24 / 1.5: H-EE 46 / 1.7: H-BVE 10 / 1.8: H-D 64 / 1.9: H-DD 108 / 1.10: MC 24

Deckel / Cover / Couvercle: 6.1: H-B 24

Kabelverschraubung / Cable gland / Presse-étoupe: 5.1: Metr. & PG

3.2 EPIC® D A - V I N C I H - B

Sockelgehäuse / Surface mount base / Embase en saillie

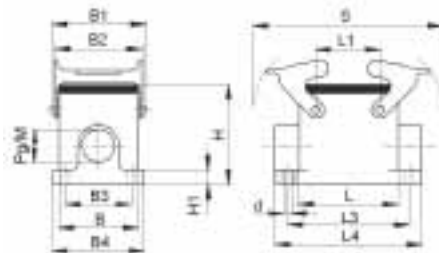

PG / M

EPIC® H-B Gehäuse: Sockelgehäuse (1 Kabeleingang, Querbügel)
EPIC® H-B housings: surface mount base (1 cable entry, double locking lever)
Boîtiers EPIC® H-B: embase en saillie (1 entrée de câble, double levier)

H-B 10

| Artikel part article | Art.Nr. part No. N° art. | PG | M | L | L1 | L2 | L3 | L4 | B | B1 | B2 | B3 | B4 | B5 | H | H1 | H2 | S | d |
|----------------------------|--------------------------------|----|----|----|----|----|----|----|----|------|----|----|----|----|----|-----|----|-----|-----|
| H-B 10 SGR 16 | 10034000 | 16 | | 73 | 27 | | 82 | 94 | 43 | 57,8 | 53 | 40 | 52 | | 57 | 4,5 | | 116 | 5,5 |
| H-B 10 SGR M20 | 19034000 | | 20 | 73 | 27 | | 82 | 94 | 43 | 57,8 | 53 | 40 | 52 | | 57 | 4,5 | | 116 | 5,5 |
| H-B 10 SGR M25 | 19034100 | | 25 | | | | | | | | | | | | | | | | |

Einsätze / Inserts / Inserts: 1.4: H-BE 10 / 1.5: H-EE 18 / 1.7: H-BVE 3 / 1.9: H-DD 42 / 1.10: MC 10

Deckel / Cover / Couvercle: 6.1: H-B 10

Kabelverschraubung / Cable gland / Presse-étoupe: 5.1: Metr. & PG

H-B 16

| Artikel part article | Art.Nr. part No. N° art. | PG | M | L | L1 | L2 | L3 | L4 | B | B1 | B2 | B3 | B4 | B5 | H | H1 | H2 | S | d |
|----------------------------|--------------------------------|----|----|----|------|----|-----|-----|----|------|----|----|----|----|----|-----|----|-------|-----|
| H-B 16 SGR 21 | 10074000 | 21 | | 93 | 47,5 | | 105 | 117 | 43 | 57,8 | 53 | 45 | 57 | | 64 | 4,5 | | 136,5 | 5,5 |
| H-B 16 SGR M25 | 19074000 | | 25 | 93 | 47,5 | | 105 | 117 | 43 | 57,8 | 53 | 45 | 57 | | 64 | 4,5 | | 136,5 | 5,5 |

Einsätze / Inserts / Inserts: 1.4: H-BE 16 / 1.5: H-EE 32 / 1.6: H-BS 6 / 1.7: H-BVE 6 / 1.8: H-D 40 / 1.9: H-DD 72 / 1.10: MC 16

Deckel / Cover / Couvercle: 6.1: H-B 16

Kabelverschraubung / Cable gland / Presse-étoupe: 5.1: Metr. & PG

H-B 24

| Artikel part article | Art.Nr. part No. N° art. | PG | M | L | L1 | L2 | L3 | L4 | B | B1 | B2 | B3 | B4 | B5 | H | H1 | H2 | S | d |
|----------------------------|--------------------------------|----|----|-----|----|----|-----|-----|----|------|----|----|----|----|----|-----|----|-----|-----|
| H-B 24 SGR 21 | 10104000 | 21 | | 120 | 74 | | 132 | 144 | 43 | 57,8 | 53 | 45 | 57 | | 64 | 4,5 | | 163 | 5,5 |
| H-B 24 SGR M25 | 19104000 | | 25 | 120 | 74 | | 132 | 144 | 43 | 57,8 | 53 | 45 | 57 | | 64 | 4,5 | | 163 | 5,5 |

Einsätze / Inserts / Inserts: 1.4: H-BE 24 / 1.5: H-EE 46 / 1.7: H-BVE 10 / 1.8: H-D 64 / 1.9: H-DD 108 / 1.10: MC 24

Deckel / Cover / Couvercle: 6.1: H-B 24

Kabelverschraubung / Cable gland / Presse-étoupe: 5.1: Metr. & PG

H-B 32

| Artikel part article | Art.Nr. part No. N° art. | PG | M | L | L1 | L2 | L3 | L4 | B | B1 | B2 | B3 | B4 | B5 | H | H1 | H2 | S | d |
|----------------------------|--------------------------------|----|----|------|------|----|-----|-------|----|------|------|----|----|----|----|----|----|-------|-----|
| H-B 32 SGR 29 | 10137000 | 29 | | | | | | | | | | | | | | | | | |
| H-B 32 SGR M32 | 19137000 | | 32 | 93,5 | 64,5 | | 112 | 124,5 | 79 | 93,8 | 87,8 | 67 | 81 | | 72 | 5 | | 136,5 | 5,5 |
| H-B 32 SGR M40 | 19146400 | | 40 | | | | | | | | | | | | | | | | |

Einsätze / Inserts / Inserts: 1.4: H-BE 32 / 1.5: H-EE 64 / 1.6: H-BS 12 / 1.8: H-D 80 / 1.9: H-DD 144 / 1.10: 2 x MC 16

Kabelverschraubung / Cable gland / Presse-étoupe: 5.1: Metr. & PG

3.2 EPIC® D A - V I N C I H - B

Sockelgehäuse / Surface mount base / Embase en saillie

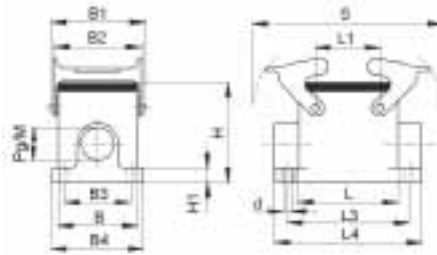

PG / M

EPIC® H-B Gehäuse: Sockelgehäuse (1 Kabeleingang, Querbügel, hohe Bauform)

EPIC® H-B housings: surface mount base (1 cable entry, double locking lever, high version)

Boîtiers EPIC® H-B: embase en saillie (1 entrée de câble, double levier, version haute)

H-B 10

| Artikel part article | Art.Nr. part No. N° art. | PG | M | L | L1 | L2 | L3 | L4 | B | B1 | B2 | B3 | B4 | B5 | H | H1 | H2 | S | d |
|----------------------------|--------------------------------|----|----|----|----|----|----|----|----|------|----|----|----|----|----|----|----|-----|-----|
| H-B 10 SGRH 21 | 70035200 | 21 | | 73 | 27 | | 82 | 97 | 43 | 57,8 | 53 | 45 | 58 | | 74 | 6 | | 116 | 5,5 |
| H-B 10 SGRH 29 | 70035400 | 29 | | | | | | | | | | | | | | | | | |
| H-B 10 SGRH M25 | 79035200 | | 25 | 73 | 27 | | 82 | 97 | 43 | 57,8 | 53 | 45 | 58 | | 74 | 6 | | 116 | 5,5 |
| H-B 10 SGRH M32 | 79035400 | | 32 | | | | | | | | | | | | | | | | |

Einsätze / Inserts / Inserts: 1.4: H-BE 10 / 1.5: H-EE 18 / 1.7: H-BVE 3 / 1.9: H-DD 42 / 1.10: MC 10

Deckel / Cover / Couvercle: 6.1: H-B 10

Kabelverschraubung / Cable gland / Presse-étoupe: 5.1: Metr. & PG

H-B 16

| Artikel part article | Art.Nr. part No. N° art. | PG | M | L | L1 | L2 | L3 | L4 | B | B1 | B2 | B3 | B4 | B5 | H | H1 | H2 | S | d |
|----------------------------|--------------------------------|----|----|------|------|----|-----|-----|----|------|----|----|----|----|----|----|----|-------|-----|
| H-B 16 SGRH 21 | 70085200 | 21 | | 93,3 | 47,5 | | 105 | 117 | 43 | 57,8 | 53 | 45 | 58 | | 84 | 6 | | 136,5 | 5,5 |
| H-B 16 SGRH 29 | 70085400 | 29 | | | | | | | | | | | | | | | | | |
| H-B 16 SGRH M25 | 79085200 | | 25 | 93,3 | 47,5 | | 105 | 117 | 43 | 57,8 | 53 | 45 | 58 | | 84 | 6 | | 136,5 | 5,5 |
| H-B 16 SGRHM32 | 79085400 | | 32 | | | | | | | | | | | | | | | | |

Einsätze / Inserts / Inserts: 1.4: H-BE 16 / 1.5: H-EE 32 / 1.6: H-BS 6 / 1.7: H-BVE 6 / 1.8: H-D 40 / 1.9: H-DD 72 / 1.10: MC 16

Deckel / Cover / Couvercle: 6.1: H-B 16

Kabelverschraubung / Cable gland / Presse-étoupe: 5.1: Metr. & PG

H-B 24

| Artikel part article | Art.Nr. part No. N° art. | PG | M | L | L1 | L2 | L3 | L4 | B | B1 | B2 | B3 | B4 | B5 | H | H1 | H2 | S | d |
|----------------------------|--------------------------------|----|----|-----|----|----|-----|-----|----|------|----|----|----|----|----|----|----|-----|-----|
| H-B 24 SGRH 21 | 70135200 | 21 | | 120 | 74 | | 132 | 144 | 43 | 57,8 | 53 | 45 | 58 | | 84 | 6 | | 163 | 5,5 |
| H-B 24 SGRH 29 | 70135400 | 29 | | | | | | | | | | | | | | | | | |
| H-B 24 SGRH M25 | 79135200 | | 25 | 120 | 74 | | 132 | 144 | 43 | 57,8 | 53 | 45 | 58 | | 84 | 6 | | 163 | 5,5 |
| H-B 24 SGRH M32 | 79135400 | | 32 | | | | | | | | | | | | | | | | |

Einsätze / Inserts / Inserts: 1.4: H-BE 24 / 1.5: H-EE 46 / 1.7: H-BVE 10 / 1.8: H-D 64 / 1.9: H-DD 108 / 1.10: MC 24

Deckel / Cover / Couvercle: 6.1: H-B 24

Kabelverschraubung / Cable gland / Presse-étoupe: 5.1: Metr. & PG

3.2 EPIC® D A - V I N C I H - B

Sockelgehäuse / Surface mount base / Embase en saillie

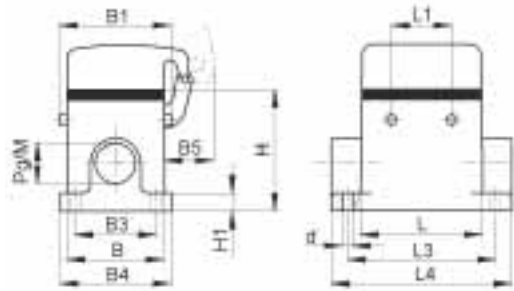

PG / M

EPIC® H-B Gehäuse: Sockelgehäuse (Schutzdeckel, 2 Kabeleingänge, Bolzen für Querbügel)
EPIC® H-B housings: surface mount base (cover, 2 cable entries, bolts for double locking lever)
Boîtiers EPIC® H-B: embase en saillie (couvercle, 2 entrées de câble, ergots pour double levier)

H-B 10

| Artikel part article | Art.Nr. part No. N° art. | PG | M | L | L1 | L2 | L3 | L4 | B | B1 | B2 | B3 | B4 | B5 | H | H1 | H2 | S | d |
|----------------------------|--------------------------------|----|----|----|----|----|----|----|----|------|----|----|----|----|----|-----|----|---|-----|
| H-B 10 SDRL-BO 16 | 10038000 | 16 | | 73 | 27 | | 82 | 94 | 43 | 57,8 | | 40 | 52 | 25 | 57 | 4,5 | | | 5,5 |
| H-B 10 SDRL-BO M20 | 19038000 | | 20 | 73 | 27 | | 82 | 94 | 43 | 57,8 | | 40 | 52 | 25 | 57 | 4,5 | | | 5,5 |
| H-B 10 SDRL-BO M25 | 79046600 | | 25 | | | | | | | | | | | | | | | | |

Einsätze / Inserts / Inserts: 1.4: H-BE 10 / 1.5: H-EE 18 / 1.7: H-BVE 3 / 1.9: H-DD 42 / 1.10: MC 10
 Kabelverschraubung / Cable gland / Presse-étoupe: 5.1: Metr. & PG

H-B 16

| Artikel part article | Art.Nr. part No. N° art. | PG | M | L | L1 | L2 | L3 | L4 | B | B1 | B2 | B3 | B4 | B5 | H | H1 | H2 | S | d |
|----------------------------|--------------------------------|----|----|----|------|----|-----|-----|----|------|----|----|----|----|----|-----|----|---|-----|
| H-B 16 SDRL-BO 21 | 70096000 | 21 | | 93 | 47,5 | | 105 | 117 | 43 | 57,8 | | 45 | 57 | 25 | 64 | 4,5 | | | 5,5 |
| H-B 16 SDRL-BO M25 | 79096000 | | 25 | 93 | 47,5 | | 105 | 117 | 43 | 57,8 | | 45 | 57 | 25 | 64 | 4,5 | | | 5,5 |

Einsätze / Inserts / Inserts: 1.4: H-BE 16 / 1.5: H-EE 32 / 1.6: H-BS 6 / 1.7: H-BVE 6 / 1.8: H-D 40 / 1.9: H-DD 72 / 1.10: MC 16
 Kabelverschraubung / Cable gland / Presse-étoupe: 5.1: Metr. & PG

H-B 24

| Artikel part article | Art.Nr. part No. N° art. | PG | M | L | L1 | L2 | L3 | L4 | B | B1 | B2 | B3 | B4 | B5 | H | H1 | H2 | S | d |
|----------------------------|--------------------------------|----|----|-----|----|----|-----|-----|----|------|----|----|----|----|----|-----|----|---|-----|
| H-B 24 SDRL-BO 21 | 10109000 | 21 | | 120 | 74 | | 132 | 144 | 43 | 57,8 | | 45 | 57 | 25 | 64 | 4,5 | | | 5,5 |
| H-B 24 SDRL-BO M25 | 19109000 | | 25 | 120 | 74 | | 132 | 144 | 43 | 57,8 | | 45 | 57 | 25 | 64 | 4,5 | | | 5,5 |

Einsätze / Inserts / Inserts: 1.4: H-BE 24 / 1.5: H-EE 46 / 1.7: H-BVE 10 / 1.8: H-D 64 / 1.9: H-DD 108 / 1.10: MC 24
 Kabelverschraubung / Cable gland / Presse-étoupe: 5.1: Metr. & PG

3.2 EPIC® D A - V I N C I H - B

Sockelgehäuse / Surface mount base / Embase en saillie

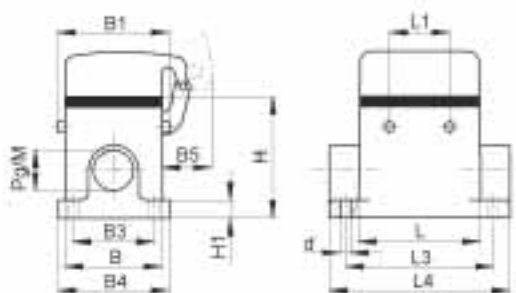

PG / M

EPIC® H-B Gehäuse: Sockelgehäuse (Schutzdeckel, 2 Kabeleingänge, Bolzen für Querbügel, hohe Bauform)

EPIC® H-B housings: surface mount base (cover, 2 cable entries, bolts for double locking lever, high version)

Boîtiers EPIC® H-B: embase en saillie (covercle, 2 entrées de câble, ergots pour double levier, version haute)

H-B 10

| Artikel part article | Art.Nr. part No. N° art. | PG | M | L | L1 | L2 | L3 | L4 | B | B1 | B2 | B3 | B4 | B5 | H | H1 | H2 | S | d |
|----------------------------|--------------------------------|----|----|----|----|----|----|----|----|------|----|----|----|----|----|----|----|---|-----|
| H-B 10 SDR LH-BO 21 | 70046200 | 21 | | 73 | 27 | | 82 | 97 | 43 | 57,8 | | 45 | 58 | 25 | 74 | 6 | | | 5,5 |
| H-B 10 SDR LH-BO 29 | 70046400 | 29 | | | | | | | | | | | | | | | | | |
| H-B 10 SDR LH-BO M25 | 79046200 | | 25 | 73 | 27 | | 82 | 97 | 43 | 57,8 | | 45 | 58 | 25 | 74 | 6 | | | 5,5 |
| H-B 10 SDR LH-BO M32 | 79046400 | | 32 | | | | | | | | | | | | | | | | |

Einsätze / Inserts / Inserts: 1.4: H-BE 10 / 1.5: H-EE 18 / 1.7: H-BVE 3 / 1.9: H-DD 42 / 1.10: MC 10

Kabelverschraubung / Cable gland / Presse-étoupe: 5.1: Metr. & PG

H-B 16

| Artikel part article | Art.Nr. part No. N° art. | PG | M | L | L1 | L2 | L3 | L4 | B | B1 | B2 | B3 | B4 | B5 | H | H1 | H2 | S | d |
|----------------------------|--------------------------------|----|----|------|------|----|-----|-----|----|------|----|----|----|----|----|----|----|---|-----|
| H-B 16 SDR LH-BO 21 | 70096200 | 21 | | 93,3 | 47,5 | | 105 | 117 | 43 | 57,8 | | 45 | 58 | 25 | 84 | 6 | | | 5,5 |
| H-B 16 SDR LH-BO 29 | 70096400 | 29 | | | | | | | | | | | | | | | | | |
| H-B 16 SDR LH-BO M25 | 79096200 | | 25 | 93,3 | 47,5 | | 105 | 117 | 43 | 57,8 | | 45 | 58 | 25 | 84 | 6 | | | 5,5 |
| H-B 16 SDR LH-BO M32 | 79096400 | | 32 | | | | | | | | | | | | | | | | |

Einsätze / Inserts / Inserts: 1.4: H-BE 16 / 1.5: H-EE 32 / 1.6: H-BS 6 / 1.7: H-BVE 6 / 1.8: H-D 40 / 1.9: H-DD 72 / 1.10: MC 16

Kabelverschraubung / Cable gland / Presse-étoupe: 5.1: Metr. & PG

H-B 24

| Artikel part article | Art.Nr. part No. N° art. | PG | M | L | L1 | L2 | L3 | L4 | B | B1 | B2 | B3 | B4 | B5 | H | H1 | H2 | S | d |
|----------------------------|--------------------------------|----|----|-----|----|----|-----|-----|----|------|----|----|----|----|----|----|----|---|-----|
| H-B 24 SDR LH-BO 21 | 70146200 | 21 | | 120 | 74 | | 132 | 144 | 43 | 57,8 | | 45 | 58 | 25 | 84 | 6 | | | 5,5 |
| H-B 24 SDR LH-BO 29 | 70146400 | 29 | | | | | | | | | | | | | | | | | |
| H-B 24 SDR LH-BO M25 | 79146200 | | 25 | 120 | 74 | | 132 | 144 | 43 | 57,8 | | 45 | 58 | 25 | 84 | 6 | | | 5,5 |
| H-B 24 SDR LH-BO M32 | 79146400 | | 32 | | | | | | | | | | | | | | | | |

Einsätze / Inserts / Inserts: 1.4: H-BE 24 / 1.5: H-EE 46 / 1.7: H-BVE 10 / 1.8: H-D 64 / 1.9: H-DD 108 / 1.10: MC 24

Kabelverschraubung / Cable gland / Presse-étoupe: 5.1: Metr. & PG

3.2 EPIC® D A - V I N C I H - B

Sockelgehäuse / Surface mount base / Embase en saillie

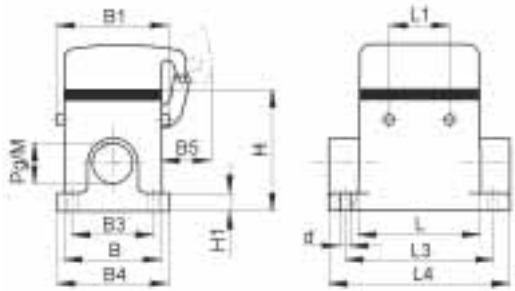

PG / M

EPIC® H-B Gehäuse: Sockelgehäuse (Schutzdeckel, 1 Kabeleingang, Bolzen für Querbügel)

EPIC® H-B housings: surface mount base (cover, 1 cable entry, bolts for double locking lever)

Boîtiers EPIC® H-B: embase en saillie (couvercle, 1 entrée de câble, ergots pour double levier)

H-B 10

| Artikel part article | Art.Nr. part No. N° art. | PG | M | L | L1 | L2 | L3 | L4 | B | B1 | B2 | B3 | B4 | B5 | H | H1 | H2 | S | d |
|----------------------------|--------------------------------|----|----|----|----|----|----|----|----|------|----|----|----|----|----|-----|----|---|-----|
| H-B 10 SDR-BO 16 | 10036000 | 16 | | 73 | 27 | | 82 | 94 | 43 | 57,8 | | 40 | 52 | 25 | 57 | 4,5 | | | 5,5 |
| H-B 10 SDR-BO M20 | 19036000 | | 20 | 73 | 27 | | 82 | 94 | 43 | 57,8 | | 40 | 52 | 25 | 57 | 4,5 | | | 5,5 |
| H-B 10 SDR-BO M25 | 19036100 | | 25 | | | | | | | | | | | | | | | | |

Einsätze / Inserts / Inserts: 1.4: H-BE 10 / 1.5: H-EE 18 / 1.7: H-BVE 3 / 1.9: H-DD 42 / 1.10: MC 10

Kabelverschraubung / Cable gland / Presse-étoupe: 5.1: Metr. & PG

H-B 16

| Artikel part article | Art.Nr. part No. N° art. | PG | M | L | L1 | L2 | L3 | L4 | B | B1 | B2 | B3 | B4 | B5 | H | H1 | H2 | S | d |
|----------------------------|--------------------------------|----|----|----|------|----|-----|-----|----|------|----|----|----|----|----|-----|----|---|-----|
| H-B 16 SDR-BO 21 | 10076000 | 21 | | 93 | 47,5 | | 105 | 117 | 43 | 57,8 | | 45 | 57 | 25 | 64 | 4,5 | | | 5,5 |
| H-B 16 SDR-BO M25 | 19076000 | | 25 | 93 | 47,5 | | 105 | 117 | 43 | 57,8 | | 45 | 57 | 25 | 64 | 4,5 | | | 5,5 |

Einsätze / Inserts / Inserts: 1.4: H-BE 16 / 1.5: H-EE 32 / 1.6: H-BS 6 / 1.7: H-BVE 6 / 1.8: H-D 40 / 1.9: H-DD 72 / 1.10: MC 16

Kabelverschraubung / Cable gland / Presse-étoupe: 5.1: Metr. & PG

H-B 24

| Artikel part article | Art.Nr. part No. N° art. | PG | M | L | L1 | L2 | L3 | L4 | B | B1 | B2 | B3 | B4 | B5 | H | H1 | H2 | S | d |
|----------------------------|--------------------------------|----|----|-----|----|----|-----|-----|----|------|----|----|----|----|----|-----|----|---|-----|
| H-B 24 SDR-BO 21 | 10107000 | 21 | | 120 | 74 | | 132 | 144 | 43 | 57,8 | | 45 | 57 | 25 | 64 | 4,5 | | | 5,5 |
| H-B 24 SDR-BO M25 | 19107000 | | 25 | 120 | 74 | | 132 | 144 | 43 | 57,8 | | 45 | 57 | 25 | 64 | 4,5 | | | 5,5 |

Einsätze / Inserts / Inserts: 1.4: H-BE 24 / 1.5: H-EE 46 / 1.7: H-BVE 10 / 1.8: H-D 64 / 1.9: H-DD 108 / 1.10: MC 24

Kabelverschraubung / Cable gland / Presse-étoupe: 5.1: Metr. & PG

3.2 EPIC® D A - V I N C I H - B

Sockelgehäuse / Surface mount base / Embase en saillie

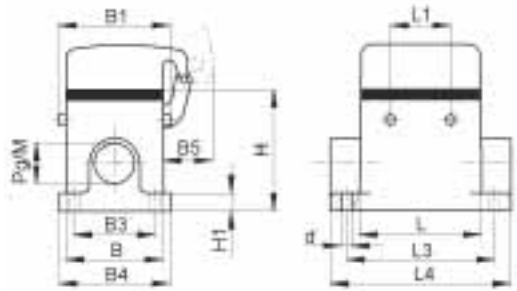

PG / M

EPIC® H-B Gehäuse: Sockelgehäuse (Schutzdeckel, 1 Kabeleingang, Bolzen für Querbügel, hohe Bauform)

EPIC® H-B housings: surface mount base (cover, 1 cable entry, bolts for double locking lever, high version)

Boîtiers EPIC® H-B: embase en saillie (covercle, 1 entrée de câble, ergots pour double levier, version haute)

H-B 10

| Artikel part article | Art.Nr. part No. N° art. | PG | M | L | L1 | L2 | L3 | L4 | B | B1 | B2 | B3 | B4 | B5 | H | H1 | H2 | S | d |
|----------------------------|--------------------------------|----|----|----|----|----|----|----|----|------|----|----|----|----|----|----|----|---|-----|
| H-B 10 SDRH-BO 21 | 70045200 | 21 | | 73 | 27 | | 82 | 97 | 43 | 57,8 | | 45 | 58 | 25 | 74 | 6 | | | 5,5 |
| H-B 10 SDRH-BO 29 | 70045400 | 29 | | | | | | | | | | | | | | | | | |
| H-B 10 SDRH-BO M25 | 79045200 | | 25 | 73 | 27 | | 82 | 97 | 43 | 57,8 | | 45 | 58 | 25 | 74 | 6 | | | 5,5 |
| H-B 10 SDRH-BO M32 | 79045400 | | 32 | | | | | | | | | | | | | | | | |

Einsätze / Inserts / Inserts: 1.4: H-BE 10 / 1.5: H-EE 18 / 1.7: H-BVE 3 / 1.9: H-DD 42 / 1.10: MC 10

Kabelverschraubung / Cable gland / Presse-étoupe: 5.1: Metr. & PG

H-B 16

| Artikel part article | Art.Nr. part No. N° art. | PG | M | L | L1 | L2 | L3 | L4 | B | B1 | B2 | B3 | B4 | B5 | H | H1 | H2 | S | d |
|----------------------------|--------------------------------|----|----|------|------|----|-----|-----|----|------|----|----|----|----|----|----|----|---|-----|
| H-B 16 SDRH-BO 21 | 70095200 | 21 | | 93,3 | 47,5 | | 105 | 117 | 43 | 57,8 | | 45 | 58 | 25 | 84 | 6 | | | 5,5 |
| H-B 16 SDRH-BO 29 | 70095400 | 29 | | | | | | | | | | | | | | | | | |
| H-B 16 SDRH-BO M25 | 79095200 | | 25 | 93,3 | 47,5 | | 105 | 117 | 43 | 57,8 | | 45 | 58 | 25 | 84 | 6 | | | 5,5 |
| H-B 16 SDRH-BO M32 | 79095400 | | 32 | | | | | | | | | | | | | | | | |

Einsätze / Inserts / Inserts: 1.4: H-BE 16 / 1.5: H-EE 32 / 1.6: H-BS 6 / 1.7: H-BVE 6 / 1.8: H-D 40 / 1.9: H-DD 72 / 1.10: MC 16

Kabelverschraubung / Cable gland / Presse-étoupe: 5.1: Metr. & PG

H-B 24

| Artikel part article | Art.Nr. part No. N° art. | PG | M | L | L1 | L2 | L3 | L4 | B | B1 | B2 | B3 | B4 | B5 | H | H1 | H2 | S | d |
|----------------------------|--------------------------------|----|----|-----|----|----|-----|-----|----|------|----|----|----|----|----|----|----|---|-----|
| H-B 24 SDRH-BO 21 | 70145200 | 21 | | 120 | 74 | | 132 | 144 | 43 | 57,8 | | 45 | 58 | 25 | 84 | 6 | | | 5,5 |
| H-B 24 SDRH-BO 29 | 70145400 | 29 | | | | | | | | | | | | | | | | | |
| H-B 24 SDRH-BO M25 | 79145200 | | 25 | 120 | 74 | | 132 | 144 | 43 | 57,8 | | 45 | 58 | 25 | 84 | 6 | | | 5,5 |
| H-B 24 SDRH-BO M32 | 79145400 | | 32 | | | | | | | | | | | | | | | | |

Einsätze / Inserts / Inserts: 1.4: H-BE 24 / 1.5: H-EE 46 / 1.7: H-BVE 10 / 1.8: H-D 64 / 1.9: H-DD 108 / 1.10: MC 24

Kabelverschraubung / Cable gland / Presse-étoupe: 5.1: Metr. & PG

3.2 EPIC® D A - V I N C I H - B

Kupplungsgehäuse / Cable coupler hood / Capot prolongateur



PG



M

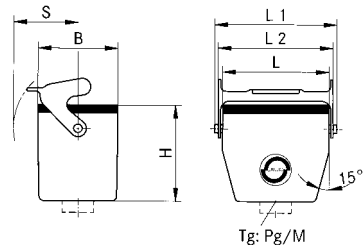

EPIC® H-B Gehäuse: Kupplungsgehäuse (Kabeleingang gerade, Längsbügel)

EPIC® H-B housings: cable coupler hood (top entry, single locking lever)

Boîtiers EPIC® H-B: capot prolongateur (sortie verticale, simple levier)

H-B 6

| Artikel part article | Art.Nr. part No. N° art. | PG | M | ZW | L | L1 | L2 | L3 | L4 | B | B1 | B2 | B3 | B4 | B5 | H | H1 | H2 | S | d |
|----------------------------|--------------------------------|------|----|----|----|------|----|----|----|----|----|----|----|----|----|------|----|----|----|---|
| H-B 6 TBF 13,5 | 10014000 | 13,5 | | ● | 60 | 74,8 | 70 | | | 43 | | | | | | 54,8 | | | 44 | |
| H-B 6 TBF 16 | 10024000 | 16 | | ● | | | | | | | | | | | | | | | | |
| H-B 6 TBF M20 | 19014000 | | 20 | | 60 | 74,8 | 70 | | | 43 | | | | | | 54,8 | | | 44 | |
| H-B 6 TBF M25 | 19024000 | | 25 | | | | | | | | | | | | | | | | | |

Einsätze / Inserts / Inserts: 1.4: H-BE 6 / 1.5: H-EE 10 / 1.9: H-DD 24 / 1.10: MC 6

Deckel / Cover / Couvercle: 6.1: H-B 6

Kabelverschraubung / Cable gland / Presse-étoupe: 5.1: Metr. & PG

H-B 10

| Artikel part article | Art.Nr. part No. N° art. | PG | M | ZW | L | L1 | L2 | L3 | L4 | B | B1 | B2 | B3 | B4 | B5 | H | H1 | H2 | S | d |
|----------------------------|--------------------------------|----|----|----|----|----|------|----|----|----|----|----|----|----|----|------|----|----|----|---|
| H-B 10 TBF-LB 16 | 10046900 | 16 | | ● | 73 | 91 | 88,5 | | | 43 | | | | | | 54,8 | | | 50 | |
| H-B 10 TBF-LB 21 | 70042200 | 21 | | ● | | | | | | | | | | | | | | | | |
| H-B 10 TBF-LB M20 | 19046900 | | 20 | | 73 | 91 | 88,5 | | | 43 | | | | | | 54,8 | | | 50 | |
| H-B 10 TBF-LB M25 | 79042200 | | 25 | | | | | | | | | | | | | | | | | |

Einsätze / Inserts / Inserts: 1.4: H-BE 10 / 1.5: H-EE 18 / 1.7: H-BVE 3 / 1.9: H-DD 42 / 1.10: MC 10

Kabelverschraubung / Cable gland / Presse-étoupe: 5.1: Metr. & PG

3.2 EPIC® D A - V I N C I H - B

Kupplungsgehäuse / Cable coupler hood / Capot prolongateur



PG



M

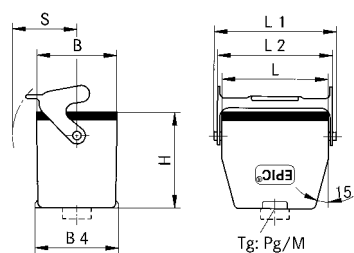

EPIC® H-B Gehäuse: Kupplungsgehäuse (Kabeleingang gerade, Längsbügel)

EPIC® H-B housings: cable coupler hood (top entry, single locking lever)

Boîtiers EPIC® H-B: capot prolongateur (sortie verticale, simple levier)

H-B 16

| Artikel part article | Art.Nr. part No. N° art. | PG | M | ZW | L | L1 | L2 | L3 | L4 | B | B1 | B2 | B3 | B4 | B5 | H | H1 | H2 | S | d |
|----------------------------|--------------------------------|----|----|----|------|-----|-------|----|----|----|----|----|----|----|----|------|----|----|----|---|
| H-B 16 TBF-LB 21 | 10086900 | 21 | | ● | 93,3 | 111 | 109,5 | | | 43 | | | | | | 63,5 | | | 50 | |
| H-B 16 TBF-LB M25 | 19086900 | | 25 | | 93,3 | 111 | 109,5 | | | 43 | | | | | | 63,5 | | | 50 | |

Einsätze / Inserts / Inserts: 1.4: H-BE 16 / 1.5: H-EE 32 / 1.6: H-BS 6 / 1.7: H-BVE 6 / 1.8: H-D 40 / 1.9: H-DD 72 / 1.10: MC 16
Kabelverschraubung / Cable gland / Presse-étoupe: 5.1: Metr. & PG

H-B 24

| Artikel part article | Art.Nr. part No. N° art. | PG | M | ZW | L | L1 | L2 | L3 | L4 | B | B1 | B2 | B3 | B4 | B5 | H | H1 | H2 | S | d |
|----------------------------|--------------------------------|----|----|----|-----|-----|-------|----|----|----|----|----|----|----|----|------|----|----|----|---|
| H-B 24 TBF-LB 21 | 10127900 | 21 | | ● | 120 | 138 | 136,5 | | | 43 | | | | | | 63,8 | | | 50 | |
| H-B 24 TBF-LB 29 | 10117900 | | 29 | ● | 120 | 138 | 136,5 | | | 43 | | | | | | 63,8 | | | 50 | |
| H-B 24 TBF-LB M25 | 19127900 | | 25 | | 120 | 138 | 136,5 | | | 43 | | | | | | 63,8 | | | 50 | |
| H-B 24 TBF-LB M32 | 19117900 | | 32 | | 120 | 138 | 136,5 | | | 43 | | | | | | 63,8 | | | 50 | |

Einsätze / Inserts / Inserts: 1.4: H-BE 24 / 1.5: H-EE 46 / 1.7: H-BVE 10 / 1.8: H-D 64 / 1.9: H-DD 108 / 1.10: MC 24
Kabelverschraubung / Cable gland / Presse-étoupe: 5.1: Metr. & PG

3.2 EPIC® D A - V I N C I H - B

Kupplungsgehäuse / Cable coupler hood / Capot prolongateur



PG



M

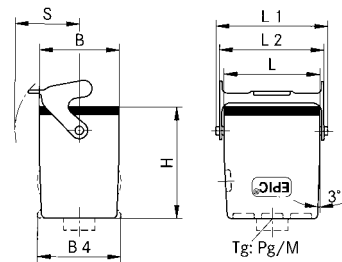

EPIC® H-B Gehäuse: Kupplungsgehäuse (Kabeleingang gerade, Längsbügel, hohe Bauform)

EPIC® H-B housings: cable coupler hood (top entry, single locking lever, high version)

Boîtiers EPIC® H-B: capot prolongateur (sortie verticale, simple levier, version haute)

H-B 6

| Artikel part article | Art.Nr. part No. N° art. | PG | M | ZW | L | L1 | L2 | L3 | L4 | B | B1 | B2 | B3 | B4 | B5 | H | H1 | H2 | S | d |
|----------------------------|--------------------------------|----|----|----|----|------|----|----|----|----|----|----|----|----|----|------|----|----|----|---|
| H-B 6 TBFH 21 | 70010200 | 21 | | ● | 60 | 74,8 | 70 | | | 43 | | | | | | 74,8 | | | 44 | |
| H-B 6 TBFH 29 | 70010400 | 29 | | ● | | | | | | | | | | | | | | | | |
| H-B 6 TBFH M25 | 79010200 | | 25 | | 60 | 74,8 | 70 | | | 43 | | | | | | 74,8 | | | 44 | |
| H-B 6 TBFH M32 | 79010400 | | 32 | | | | | | | | | | | | | | | | | |

Einsätze / Inserts / Inserts: 1.4: H-BE 6 / 1.5: H-EE 10 / 1.9: H-DD 24 / 1.10: MC 6

Deckel / Cover / Couvercle: 6.1: H-B 6

Kabelverschraubung / Cable gland / Presse-étoupe: 5.1: Metr. & PG

H-B 10

| Artikel part article | Art.Nr. part No. N° art. | PG | M | ZW | L | L1 | L2 | L3 | L4 | B | B1 | B2 | B3 | B4 | B5 | H | H1 | H2 | S | d |
|----------------------------|--------------------------------|----|----|----|----|----|------|----|----|----|----|----|----|----|----|------|----|----|----|---|
| H-B 10 TBFH-LB 21 | 70042400 | 21 | | ● | 73 | 91 | 88,5 | | | 43 | | | | | | 74,8 | | | 50 | |
| H-B 10 TBFH-LB 29 | 70042600 | 29 | | ● | | | | | | | | | | | | | | | | |
| H-B 10 TBFH-LB M25 | 79042400 | | 25 | | 73 | 91 | 88,5 | | | 43 | | | | | | 74,8 | | | 50 | |
| H-B 10 TBFH-LB M32 | 79042600 | | 32 | | | | | | | | | | | | | | | | | |

Einsätze / Inserts / Inserts: 1.4: H-BE 10 / 1.5: H-EE 18 / 1.7: H-BVE 3 / 1.9: H-DD 42 / 1.10: MC 10

Kabelverschraubung / Cable gland / Presse-étoupe: 5.1: Metr. & PG

3.2 EPIC® D A - V I N C I H - B

Kupplungsgehäuse / Cable coupler hood / Capot prolongateur



PG



M

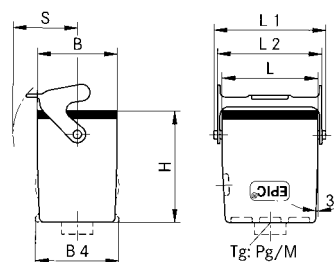

EPIC® H-B Gehäuse: Kupplungsgehäuse (Kabeleingang gerade, Längsbügel, hohe Bauform)

EPIC® H-B housings: cable coupler hood (top entry, single locking lever, high version)

Boîtiers EPIC® H-B: capot prolongateur (sortie verticale, simple levier, version haute)

H-B 16

| Artikel part article | Art.Nr. part No. N° art. | PG | M | ZW | L | L1 | L2 | L3 | L4 | B | B1 | B2 | B3 | B4 | B5 | H | H1 | H2 | S | d |
|----------------------------|--------------------------------|----|----|----|------|-----|-------|----|----|----|----|----|----|----|----|------|----|----|----|---|
| H-B 16 TBFH-LB 21 | 70092200 | 21 | | ● | 93,3 | 111 | 109,5 | | | 43 | | | | | | 78,8 | | | 50 | |
| H-B 16 TBFH-LB 29 | 70092400 | 29 | | ● | | | | | | | | | | | | | | | | |
| H-B 16 TBFH-LB M25 | 79092200 | | 25 | | 93,3 | 111 | 109,5 | | | 43 | | | | | | 78,8 | | | 50 | |
| H-B 16 TBFH-LB M32 | 79092400 | | 32 | | | | | | | | | | | | | | | | | |

Einsätze / Inserts / Inserts: 1.4: H-BE 16 / 1.5: H-EE 32 / 1.6: H-BS 6 / 1.7: H-BVE 6 / 1.8: H-D 40 / 1.9: H-DD 72 / 1.10: MC 16
Kabelverschraubung / Cable gland / Presse-étoupe: 5.1: Metr. & PG

H-B 24

| Artikel part article | Art.Nr. part No. N° art. | PG | M | ZW | L | L1 | L2 | L3 | L4 | B | B1 | B2 | B3 | B4 | B5 | H | H1 | H2 | S | d |
|----------------------------|--------------------------------|----|----|----|-----|-----|-------|----|----|----|----|----|----|----|----|------|----|----|----|---|
| H-B 24 TBFH-LB 21 | 70142400 | 21 | | ● | 120 | 138 | 136,5 | | | 43 | | | | | | 78,8 | | | 50 | |
| H-B 24 TBFH-LB 29 | 70142600 | 29 | | ● | | | | | | | | | | | | | | | | |
| H-B 24 TBFH-LB M25 | 79142400 | | 25 | | 120 | 138 | 136,5 | | | 43 | | | | | | 78,8 | | | 50 | |
| H-B 24 TBFH-LB M32 | 79142600 | | 32 | | | | | | | | | | | | | | | | | |

Einsätze / Inserts / Inserts: 1.4: H-BE 24 / 1.5: H-EE 46 / 1.7: H-BVE 10 / 1.8: H-D 64 / 1.9: H-DD 108 / 1.10: MC 24
Kabelverschraubung / Cable gland / Presse-étoupe: 5.1: Metr. & PG

3.2 EPIC® D A - V I N C I H - B

Kupplungsgehäuse / Cable coupler hood / Capot prolongateur

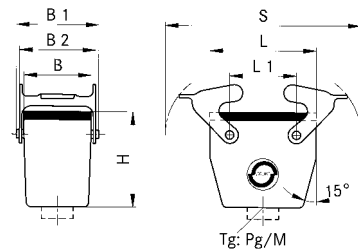

EPIC® H-B Gehäuse: Kupplungsgehäuse (Kabeleingang gerade, Querbügel)
EPIC® H-B housings: cable coupler hood (top entry, double locking lever)
Boîtiers EPIC® H-B: capot prolongateur (sortie verticale, double levier)

H-B 10

| Artikel part article | Art.Nr. part No. N° art. | PG | M | ZW | L | L1 | L2 | L3 | L4 | B | B1 | B2 | B3 | B4 | B5 | H | H1 | H2 | S | d |
|----------------------------|--------------------------------|----|---|----|----|----|----|----|----|----|------|----|----|----|----|------|----|----|---|-----|
| H-B 10 TBF 16 | 10046000 | 16 | ● | | 73 | 27 | | | | 43 | 57,8 | 53 | | | | 54,8 | | | | 116 |
| H-B 10 TBF 21 | 70040200 | 21 | ● | | | | | | | | | | | | | | | | | |
| H-B 10 TBF M20 | 19046000 | | | 20 | 73 | 27 | | | | 43 | 57,8 | 53 | | | | 54,8 | | | | 116 |
| H-B 10 TBF M25 | 79040200 | | | 25 | | | | | | | | | | | | | | | | |

Einsätze / Inserts / Inserts: 1.4: H-BE 10 / 1.5: H-EE 18 / 1.7: H-BVE 3 / 1.9: H-DD 42 / 1.10: MC 10

Deckel / Cover / Couvercle: 6.1: H-B 10

Kabelverschraubung / Cable gland / Presse-étoupe: 5.1: Metr. & PG

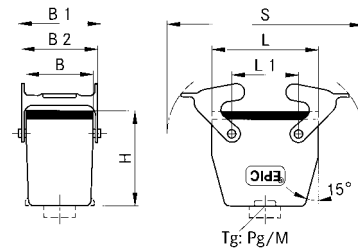

H-B 16

| Artikel part article | Art.Nr. part No. N° art. | PG | M | ZW | L | L1 | L2 | L3 | L4 | B | B1 | B2 | B3 | B4 | B5 | H | H1 | H2 | S | d |
|----------------------------|--------------------------------|----|---|----|------|------|----|----|----|----|------|----|----|----|----|------|----|----|---|-------|
| H-B 16 TBF 21 | 10086000 | 21 | ● | | 93,3 | 47,5 | | | | 43 | 57,8 | 53 | | | | 63,6 | | | | 136,5 |
| H-B 16 TBF M25 | 19086000 | | | 25 | 93,3 | 47,5 | | | | 43 | 57,8 | 53 | | | | 63,6 | | | | 136,5 |

Einsätze / Inserts / Inserts: 1.4: H-BE 16 / 1.5: H-EE 32 / 1.6: H-BS 6 / 1.7: H-BVE 6 / 1.8: H-D 40 / 1.9: H-DD 72 / 1.10: MC 16

Deckel / Cover / Couvercle: 6.1: H-B 16

Kabelverschraubung / Cable gland / Presse-étoupe: 5.1: Metr. & PG

H-B 24

| Artikel part article | Art.Nr. part No. N° art. | PG | M | ZW | L | L1 | L2 | L3 | L4 | B | B1 | B2 | B3 | B4 | B5 | H | H1 | H2 | S | d |
|----------------------------|--------------------------------|----|---|----|-----|----|----|----|----|----|------|----|----|----|----|------|----|----|---|-----|
| H-B 24 TBF 21 | 10127000 | 21 | ● | | 120 | 74 | | | | 43 | 57,8 | 53 | | | | 63,8 | | | | 163 |
| H-B 24 TBF 29 | 10117000 | 29 | ● | | | | | | | | | | | | | | | | | |
| H-B 24 TBF M25 | 19127000 | | | 25 | 120 | 74 | | | | 43 | 57,8 | 53 | | | | 63,8 | | | | 163 |
| H-B 24 TBF M32 | 19117000 | | | 32 | | | | | | | | | | | | | | | | |

Einsätze / Inserts / Inserts: 1.4: H-BE 24 / 1.5: H-EE 46 / 1.7: H-BVE 10 / 1.8: H-D 64 / 1.9: H-DD 108 / 1.10: MC 24

Deckel / Cover / Couvercle: 6.1: H-B 24

Kabelverschraubung / Cable gland / Presse-étoupe: 5.1: Metr. & PG

3.2 EPIC® D A - V I N C I H - B

Kupplungsgehäuse / Cable coupler hood / Capot prolongateur



EPIC® H-B Gehäuse: Kupplungsgehäuse (Kabeleingang gerade, Querbügel, hohe Bauform)
EPIC® H-B housings: cable coupler hood (top entry, double locking lever, high version)
Boîtiers EPIC® H-B: capot prolongateur (sortie verticale, double levier, version haute)

H-B 10

| Artikel part article | Art.Nr. part No. N° art. | PG | M | ZW | L | L1 | L2 | L3 | L4 | B | B1 | B2 | B3 | B4 | B5 | H | H1 | H2 | S | d |
|----------------------------|--------------------------------|----|---|----|----|----|----|----|----|----|------|----|----|----|----|------|----|----|---|-----|
| H-B 10 TBFH 21 | 70040400 | 21 | ● | | 73 | 27 | | | | 43 | 57,8 | 53 | | | | 74,8 | | | | 116 |
| H-B 10 TBFH 29 | 70040600 | 29 | ● | | | | | | | | | | | | | | | | | |
| H-B 10 TBFH M25 | 79040400 | | | 25 | 73 | 27 | | | | 43 | 57,8 | 53 | | | | 74,8 | | | | 116 |
| H-B 10 TBFH M32 | 79040600 | | | 32 | | | | | | | | | | | | | | | | |

Einsätze / Inserts / Inserts: 1.4: H-BE 10 / 1.5: H-EE 18 / 1.7: H-BVE 3 / 1.9: H-DD 42 / 1.10: MC 10

Deckel / Cover / Couvercle: 6.1: H-B 10

Kabelverschraubung / Cable gland / Presse-étoupe: 5.1: Metr. & PG



H-B 16

| Artikel part article | Art.Nr. part No. N° art. | PG | M | ZW | L | L1 | L2 | L3 | L4 | B | B1 | B2 | B3 | B4 | B5 | H | H1 | H2 | S | d |
|----------------------------|--------------------------------|----|---|----|------|------|----|----|----|----|------|----|----|----|----|------|----|----|---|-------|
| H-B 16 TBFH 21 | 70090200 | 21 | ● | | 93,3 | 47,5 | | | | 43 | 57,8 | 53 | | | | 78,8 | | | | 136,5 |
| H-B 16 TBFH 29 | 70090400 | 29 | ● | | | | | | | | | | | | | | | | | |
| H-B 16 TBFH M25 | 79090200 | | | 25 | 93,3 | 47,5 | | | | 43 | 57,8 | 53 | | | | 78,8 | | | | 136,5 |
| H-B 16 TBFH M32 | 79090400 | | | 32 | | | | | | | | | | | | | | | | |

Einsätze / Inserts / Inserts: 1.4: H-BE 16 / 1.5: H-EE 32 / 1.6: H-BS 6 / 1.7: H-BVE 6 / 1.8: H-D 40 / 1.9: H-DD 72 / 1.10: MC 16

Deckel / Cover / Couvercle: 6.1: H-B 16

Kabelverschraubung / Cable gland / Presse-étoupe: 5.1: Metr. & PG

3.2 EPIC® D A - V I N C I H - B

Kupplungsgehäuse / Cable coupler hood / Capot prolongateur



PG



M

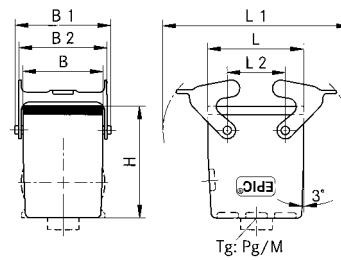

EPIC® H-B Gehäuse: Kupplungsgehäuse (Kabeleingang gerade, Querbügel, hohe Bauform)

EPIC® H-B housings: cable coupler hood (top entry, double locking lever, high version)

Boîtiers EPIC® H-B: capot prolongateur (sortie verticale, double levier, version haute)

H-B 24

| Artikel part article | Art.Nr. part No. N° art. | PG | M | ZW | L | L1 | L2 | L3 | L4 | B | B1 | B2 | B3 | B4 | B5 | H | H1 | H2 | S | d |
|----------------------------|--------------------------------|----|---|----|-----|----|----|----|----|----|------|----|----|----|----|------|----|----|---|-----|
| H-B 24 TBFH 21 | 70140400 | 21 | ● | | 120 | 74 | | | | 43 | 57,8 | 53 | | | | 78,8 | | | | 163 |
| H-B 24 TBFH 29 | 70140600 | 29 | ● | | | | | | | | | | | | | | | | | |
| H-B 24 TBFH M25 | 79140400 | | | 25 | 120 | 74 | | | | 43 | 57,8 | 53 | | | | 78,8 | | | | 163 |
| H-B 24 TBFH M32 | 79140600 | | | 32 | | | | | | | | | | | | | | | | |

Einsätze / Inserts / Inserts: 1.4: H-BE 24 / 1.5: H-EE 46 / 1.7: H-BVE 10 / 1.8: H-D 64 / 1.9: H-DD 108 / 1.10: MC 24

Deckel / Cover / Couvercle: 6.1: H-B 24

Kabelverschraubung / Cable gland / Presse-étoupe: 5.1: Metr. & PG



PG



M

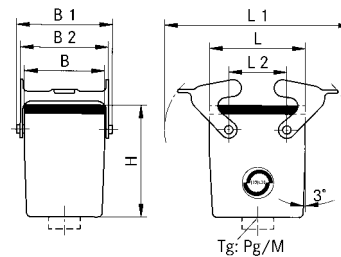

H-B 32

| Artikel part article | Art.Nr. part No. N° art. | PG | M | ZW | L | L1 | L2 | L3 | L4 | B | B1 | B2 | B3 | B4 | B5 | H | H1 | H2 | S | d |
|----------------------------|--------------------------------|----|---|----|------|------|----|----|----|----|------|------|----|----|----|----|----|----|---|-------|
| H-B 32 TBFH 29 | 10139500 | 29 | ● | | 93,5 | 64,5 | | | | 79 | 93,8 | 87,8 | | | | 97 | 5 | | | 136,5 |
| H-B 32 TBFH M32 | 19139500 | | | 32 | 93,5 | 64,5 | | | | 79 | 93,8 | 87,8 | | | | 97 | 5 | | | 136,5 |

Einsätze / Inserts / Inserts: 1.4: H-BE 32 / 1.5: H-EE 64 / 1.6: H-BS 12 / 1.8: H-D 80 / 1.9: H-DD 144 / 1.10: 2 x MC 16

Kabelverschraubung / Cable gland / Presse-étoupe: 5.1: Metr. & PG

3.2 EPIC® D A - V I N C I H - B

Tüllengehäuse / Hood / Capot

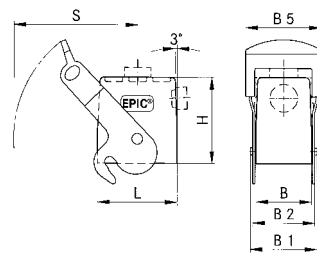

EPIC® H-B Gehäuse: Tüllengehäuse mit Zentralbügel

EPIC® H-B housings: hood with central lever

Boîtiers EPIC® H-B: capot avec levier central

H-B 16

| Artikel part article | Art.Nr. part No. N° art. | PG | M | ZW | L | L1 | L2 | L3 | L4 | B | B1 | B2 | B3 | B4 | B5 | H | H1 | H2 | S | d |
|----------------------------|--------------------------------|----|----|----|------|----|----|----|----|----|----|----|----|----|----|----|----|----|---|---|
| H-B 16 TSH-ZB | 70124200 | | 21 | | 93,3 | | | | | 43 | | | | | | 76 | | | | |

Einsätze / Inserts / Inserts: 1.4: H-BE 16 / 1.5: H-EE 32 / 1.6: H-BS 6 / 1.7: H-BVE 6 / 1.8: H-D 40 / 1.9: H-DD 72 / 1.10: MC 16

Deckel / Cover / Couvercle: 6.1: H-B 16

Kabelverschraubung / Cable gland / Presse-étoupe: 5.1: Metr. & PG

H-B 24

| Artikel part article | Art.Nr. part No. N° art. | PG | M | ZW | L | L1 | L2 | L3 | L4 | B | B1 | B2 | B3 | B4 | B5 | H | H1 | H2 | S | d |
|----------------------------|--------------------------------|----|----|----|-----|----|----|----|----|----|----|----|----|----|----|----|----|----|---|---|
| H-B 24 TSH-ZB | 70174400 | | 21 | | | | | | | 43 | | | | | | 76 | | | | |
| H-B 24 TSH-ZB | 70174200 | | 29 | | 120 | | | | | | | | | | | | | | | |

Einsätze / Inserts / Inserts: 1.4: H-BE 24 / 1.5: H-EE 46 / 1.7: H-BVE 10 / 1.8: H-D 64 / 1.9: H-DD 108 / 1.10: MC 24

Deckel / Cover / Couvercle: 6.1: H-B 24

Kabelverschraubung / Cable gland / Presse-étoupe: 5.1: Metr. & PG

3.2 EPIC® D A - V I N C I H - B

Anbaugehäuse / Panel mount base / Embase encastrée

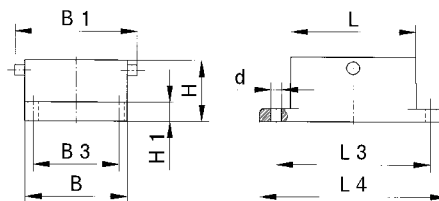

EPIC® H-B Gehäuse: Anbaugehäuse für Zentralbügel
EPIC® H-B housings: panel mount base for central lever
Boîtiers EPIC® H-B: embase encastrée pour levier centralement

H-B 16

| Artikel part article | Art.Nr. part No. N° art. | PG | M | ZW | L | L1 | L2 | L3 | L4 | B | B1 | B2 | B3 | B4 | B5 | H | H1 | H2 | S | d |
|----------------------------|--------------------------------|----|---|----|------|----|----|-----|-----|----|------|----|----|----|----|------|----|----|---|---|
| H-B 16 AG-ZR | 70084000 | | | | 93,3 | | | 103 | 113 | 43 | 57,8 | 53 | 32 | | | 27,8 | 4 | | | |

Einsätze / Inserts / Inserts: 1.4: H-BE 16 / 1.5: H-EE 32 / 1.6: H-BS 6 / 1.7: H-BVE 6 / 1.8: H-D 40 / 1.9: H-DD 72 / 1.10: MC 16
 Deckel / Cover / Couvercle: 6.1: H-B 16
 Kabelverschraubung / Cable gland / Presse-étoupe: 5.1: Metr. & PG

H-B 24

| Artikel part article | Art.Nr. part No. N° art. | PG | M | ZW | L | L1 | L2 | L3 | L4 | B | B1 | B2 | B3 | B4 | B5 | H | H1 | H2 | S | d |
|----------------------------|--------------------------------|----|---|----|-----|----|----|-----|-----|----|------|----|----|----|----|------|----|----|---|---|
| H-B 24 AG-ZR | 70134000 | | | | 120 | | | 130 | 140 | 43 | 57,8 | 53 | 32 | | | 27,8 | 4 | | | |

Einsätze / Inserts / Inserts: 1.4: H-BE 24 / 1.5: H-EE 46 / 1.7: H-BVE 10 / 1.8: H-D 64 / 1.9: H-DD 108 / 1.10: MC 24
 Deckel / Cover / Couvercle: 6.1: H-B 24
 Kabelverschraubung / Cable gland / Presse-étoupe: 5.1: Metr. & PG