

italian
quality



Made in Italy

Industria
Leader

SIRENA S.p.A.

**Linea
fari di
illuminazione**

**Light beam
signals**



Linea fari di illuminazione
Light beam signals

317-324



Linea fari di illuminazione. Light beam signals

Fari orientabili manualmente con luce alogena

Halogen swivel light beams - manual orientation

V 12-24 (±10%)



IP 65

°C -30 +50

On ∞



FO 195 H1 MV
FO195H1MVD
FO195H1MVP

55 56

FO195H1MVD12D 30003
FO195H1MVD24D 29988

	V ---	12	24
	A	4.6	2.9
	Cd (p)	195.000	
H1 12V 55W LR H 55W 12 H1 24V 70W LR H 70W 24			

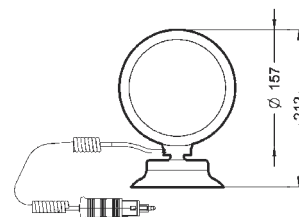
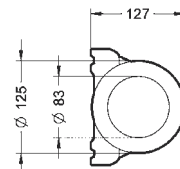

FO195H1MVP12D 30004
FO195H1MVP24D 30005



Kg. 1,24



FO 195 H1 B
FO195H1BD
FO195H1BP

55 57

FO195H1BD12D 29976
FO195H1BD24D 29978

	V ---	12	24
	A	4.6	2.9
	Cd (p)	195.000	
H1 12V 55W LR H 55W 12 H1 24V 70W LR H 70W 24			

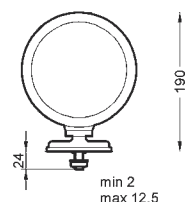
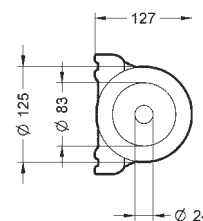

FO195H1BP12D 29977
FO195H1BP24D 29989



Kg. 0,97

Linea fari di illuminazione. Light beam signals

Fari orientabili manualmente con luce allo xeno

Swivel light beams with xenon light - manual orientation

V 12÷24 (±10%)	≡	IP 65	°C -30 +50	On ∞
----------------	---	-------	------------	------



FO230HIDMVD12/24D 29985

FO 230 HID MV
FO230HIDMVD
FO230HIDMVP

55 56

 HID 35W LR HID 35W	V ≡	12÷24	
	A	3.3	1.65
	Cd (p)	230.000	

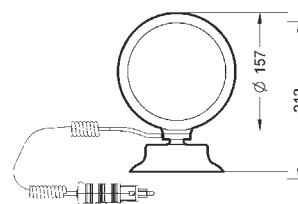
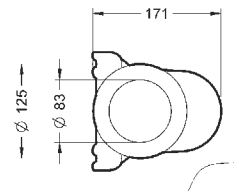

FO230HIDMVP12/24D 30006



Kg. 1,77

Linea fari di illuminazione. Light beam signals



FO230HIDBD12/24D 29970

FO 230 HID B
FO230HIDBD
FO230HIDBP

55 57

 HID 35W LR HID 35W	V ≡	12÷24	
	A	3.3	1.65
	Cd (p)	230.000	

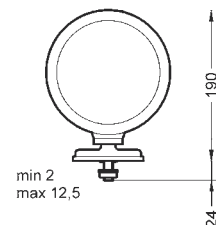
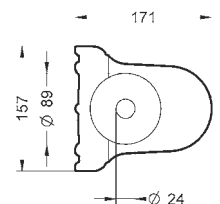

FO230HIDBP12/24D 29987

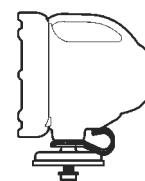

Kg. 1,49

Fari di lavoro

Work beams



FARO DI LAVORO A
WORK BEAM A
FDLA/DH
FDLA/PH

13 18 25 27

V 12-24 (±10%)	≡	IP 44	°C -30 +50	On ∞
----------------	---	-------	------------	------

	V ≡	12	24	FDL M/D FDL A/D FDL P/D
	A	4.6	2.9	
	Cd (p)	4000	4000	
	∠	26°		
H3 12V 55W H3 24V 70W				

	V ≡	12	24	FDL M/P FDL A/P FDL P/P
	A	4.6	2.9	
	Cd (p)	4000	4000	
	∠	5°		
H3 12V 55W H3 24V 70W				

FDLADH12D	28019	FDLADH24D	28031
FDLAPH12D	28018	FDLAPH24D	28030

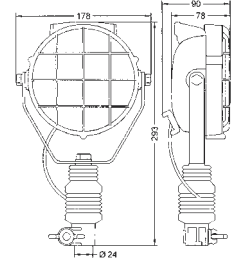



Kg. 0,9



FARO DI LAVORO M
WORK BEAM M
FDLM/DH
FDLM/PH

13 18 25 26

	V ≡	12	24	FDL M/D FDL A/D FDL P/D
	A	4.6	2.9	
	Cd (p)	4000	4000	
	∠	26°		
H3 12V 55W H3 24V 70W				

	V ≡	12	24	FDL M/P FDL A/P FDL P/P
	A	4.6	2.9	
	Cd (p)	4000	4000	
	∠	5°		
H3 12V 55W H3 24V 70W				

FDLMDH12D	28028	FDLMDH24D	28029
FDLMPH12D	28027	FDLMPH24D	28026

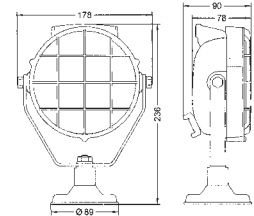



Kg. 1,2



FARO DI LAVORO P
WORK BEAM P
FDLP/DH
FDLP/PH

13 18 25 40

	V ≡	12	24	FDL M/D FDL A/D FDL P/D
	A	4.6	2.9	
	Cd (p)	4000	4000	
	∠	26°		
H3 12V 55W H3 24V 70W				

	V ≡	12	24	FDL M/P FDL A/P FDL P/P
	A	4.6	2.9	
	Cd (p)	4000	4000	
	∠	5°		
H3 12V 55W H3 24V 70W				

FDLPDH12D	29982	FDLPDH24D	29983
FDLPPH12D	28048	FDLPPH24D	28044

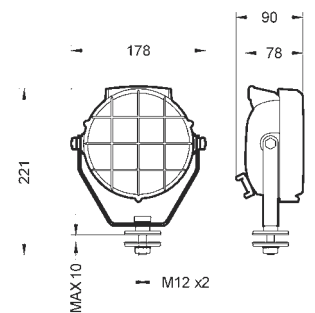

Kg. 0,76

Fari di lavoro con sensore crepuscolare

Work beams with twilight sensor

V 20÷100	☐☐☐	IP 44	°C -30 +50	On ∞
----------	-----	-------	------------	------

Faro di lavoro con sensore automatico crepuscolare + CSW 20÷100V

Work beam with twilight automatic sensor + CSW 20÷100V



KIT FMA N
KITFMAN
⑬ ⑱ ⑲ ⑳ ㉑

 H3 12V 55W LR H3 55W 12	V ☐☐☐	20÷100
	A	3.2÷0.6
	V out	12V dc
	P out	max 60 W
	Cd (p)	4000

KITFMAND20100	28035
KITFMANP20100	28046

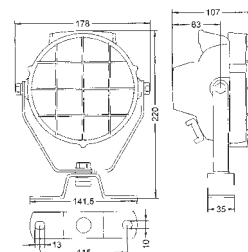

Kg. 1,4

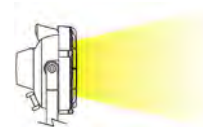
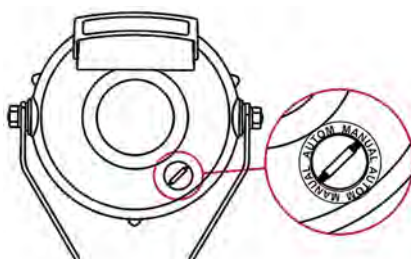

FDL D = LUCE DIFFUSA
DIFFUSED LIGHT

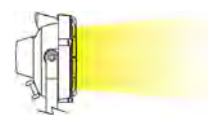

FDL P = LUCE DI PROFONDITÀ
DEPTH LIGHT

Faro di lavoro con sensore automatico crepuscolare + CSW 20÷100V + base DIN A + spinotto R

Work beam with twilight automatic sensor + CSW 20÷100V + DIN A base + adapter socket R



KIT FMA A
KITFMAA
⑬ ⑱ ⑲ ⑳ ㉑

 H3 12V 55W LR H3 55W 12	V ☐☐☐	20÷100
	A	3.2÷0.6
	V out	12V dc
	P out	max 60 W
	Cd (p)	4000

KITFMAAD20100	28036
KITFMAAP20100	28047

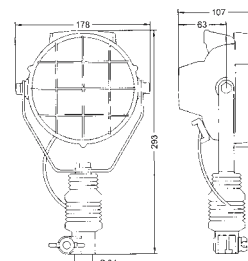

Kg. 1,5

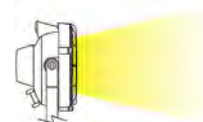
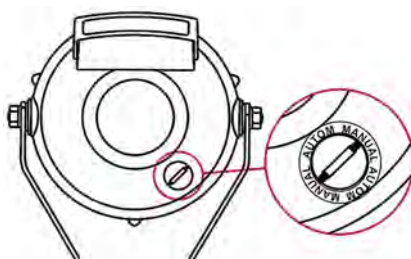

FDL D = LUCE DIFFUSA
DIFFUSED LIGHT

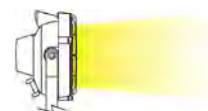

FDL P = LUCE DI PROFONDITÀ
DEPTH LIGHT

Fari di lavoro con sensore crepuscolare

Work beams with twilight sensor

V 20÷100



IP 44

°C -30 +50

On ∞

Faro di lavoro con sensore automatico crepuscolare + CSW 20÷100V + 1 magnete + CSP SAC + CKM

Work beam with twilight automatic sensor + CSW 20÷100V + 1 magnet + CSP SAC + plug-in socket with cap (CKM)



	V	20÷100
	A	3.2÷0.6
	V out	12V dc
	P out	max 60 W
	Cd (p)	4000

H3 12V 55W
LR H3 55W 12

KITFMAMD20100	28037
KITFMAMP20100	28045

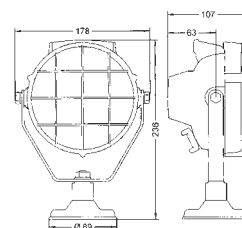

Kg. 1,7

KIT FMA M
KITFMAM

13 18 25 26

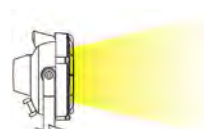
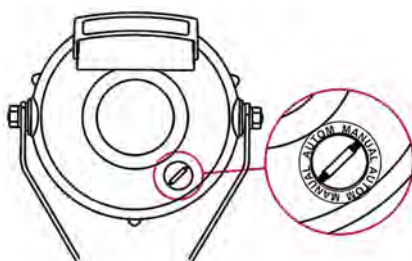

FDL D = LUCE DIFFUSA
DIFFUSED LIGHT

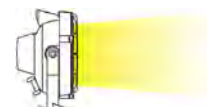

FDL P = LUCE DI PROFONDITÀ
DEPTH LIGHT

V 20÷100



On ∞

IP 55

°C -30 +50

Convertitore di tensione DC-DC
Voltage converter DC-DC



CONVERTITORE SWITCHING
CONVERTER SWITCHING
CSW20/100V

16

V	20÷100
A	3.2÷0.6
V out	12V dc
P out	max 60 W

CSW20100	84596
----------	-------

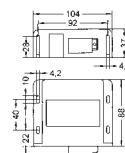

Kg. 0,45

Linea fari di illuminazione. Light beam signals

Fari orientabili elettricamente

Swivel light beams - electrically powered

V 12-24 (±10%)	☐☐☐	IP 55	°C -30 +50	On ∞	6	PC HT
----------------	-----	-------	------------	------	---	-------

Faro orientabile con comando a distanza via radio (FORC S) o via cavo (FOTC S)
Swivel light beam operated at a distance by a radio (FORC S) or by a cable (FOTC S)



FORC S B
FOTC S B
⑬ ⑥⑤

	V ☐☐☐	12	24
	A	4.6	2.9
	Cd (p)	120.000	

FORCSBDH55W12D	45000	FOTCSBDH55W12D	45008
FORCSBPH55W12D	45001	FOTCSBPH55W12D	45009
FORCSBDH70W24D	45002	FOTCSBDH70W24D	45010
FORCSBPH70W24D	45003	FOTCSBPH70W24D	45011

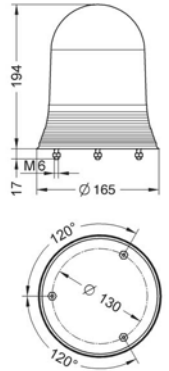

Kg. 1,10



FORC S A
FOTC S A
⑬

	V ☐☐☐	12	24
	A	4.6	2.9
	Cd (p)	120.000	

FORCSADH55W12D	45012	FOTCSADH55W12D	45020
FORCSAPH55W12D	45013	FOTCSAPH55W12D	45021
FORCSADH70W24D	45014	FOTCSADH70W24D	45022
FORCSAPH70W24D	45015	FOTCSAPH70W24D	45023

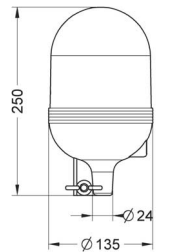

Kg. 0,95

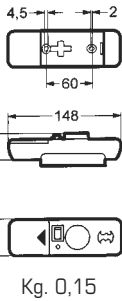
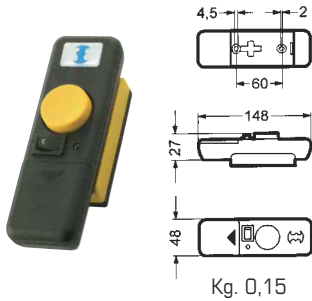

Kg. 0,15

Radiocomando (FORC)
Remote control by radio (FORC)

Telecomando (FOTC)
Remote control by wire (FOTC)

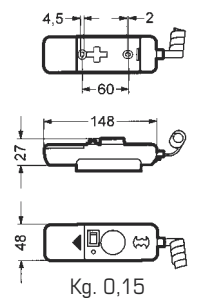

Kg. 0,15

FORC S con griglia
FORC S with grid



BDFORCSM
⑬ ⑥⑤ ⑰

	V ☐☐☐	12	24
	A	4.6	2.9
	Cd (p)	120.000	

BDFORCSMDH55W12D	45032
BDFORCSMPH55W12D	45033
BDFORCSMDH70W24D	45034
BDFORCSMPH70W24D	45035

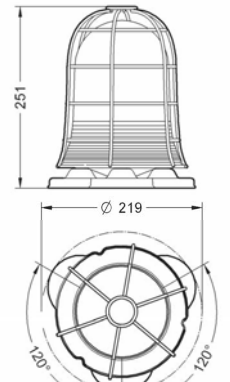

Kg. 2,90

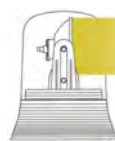

P = LUCE DI PROFONDITÀ
DEPTH LIGHT

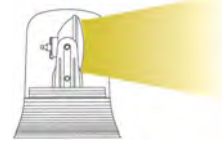

D = LUCE DIFFUSA
DIFFUSED LIGHT



B3M

B3M	83152
-----	-------

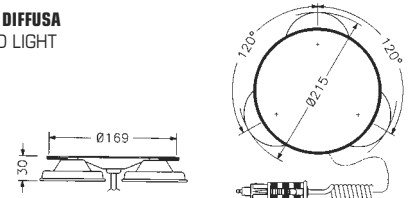

Kg. 1,15

Linea fari di illuminazione. Light beam signals

Fari orientabili elettricamente

Swivel light beams - electrically powered

V 12-24 (±10%)		IP 67	°C -30 +50	On ∞	6	PC HT
----------------	--	-------	------------	------	---	-------

Faro radiocomandato per impiego marino

Radio controlled waterproof light beam for marine application



FORC INOX S
STFORCS
(10)

	V	12	24
	A	4.6	2.9
	Cd (p)	120.000	

- STFORCSDH55W12D 45040
- STFORCSPH55W12D 45041
- STFORCSDH70W24D 45042
- STFORCSPH70W24D 45043

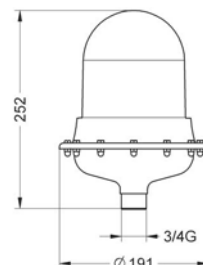

Kg. 2,26

V 12-24 (±10%)		IP 55	°C -30 +50	On ∞	6	PC HT
----------------	--	-------	------------	------	---	-------



B2 FORC S B H1 100W
B2FORCSBH100W

(65) (66)

B2 FOTC S B H1 100W
B2FOTCSBH100W

(65) (66)

	V	12	24
	A	6.6	3.3
	Cd (p)	195.000	

- B2FORCSBDH100W12D 45048
- B2FORCSBPH100W12D 45049
- B2FORCSBDH100W24D 45050
- B2FORCSBPH100W24D 45051
- B2FOTCSBDH100W12D 45056
- B2FOTCSBPH100W12D 45057
- B2FOTCSBDH100W24D 45058
- B2FOTCSBPH100W24D 45059

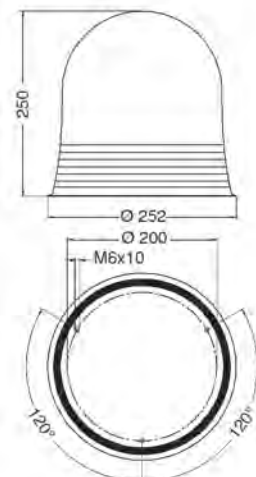

Kg. 2,30



B2 FORC S B HID
B2FORCSBHID

(65) (66)

B2 FOTC S B HID
B2FOTCSBHID

(65) (66)

	V	12÷24	
	A	3.3	1.65
	Cd (p)	230.000	

- B2FORCSBDHID12D 45060
- B2FORCSBPHID12D 45061
- B2FORCSBDHID24D 45062
- B2FORCSBPHID24D 45063
- B2FOTCSBDHID12D 45068
- B2FOTCSBPHID12D 45069
- B2FOTCSBDHID24D 45070
- B2FOTCSBPHID24D 45071

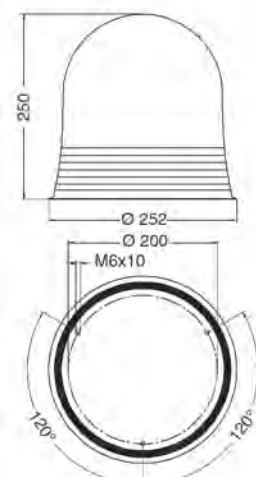

Kg. 2,77

Linea fari di illuminazione. Light beam signals

Fari di ricerca portatili

Portable search beams

V 12 Tensione di ricarica Recharge voltage	IP 65	°C -30 +50
(Batt. Pb 12V 4500 mAh)	Tempo max. di ricarica Max. recharge time	240 min.

Faro di ricerca autoalimentato portatile con luce alogena e segnalatore posteriore a led Battery operated portable search beam with halogen light and rear led signalling indicator



BILIGHT
BILIGHT
52 53 54

	V 12
	Cd (p) 195.000
H1 12V 55W LR H 55W 12	On 30 min.
	V 12
LED	Cd (p) 65
	On 600 min.

BILIGHTDNERO12D 76144
BILIGHTPNERO12D 76145

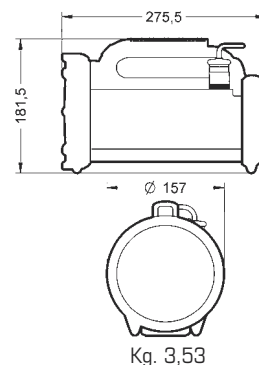

Faro di ricerca autoalimentato portatile con luce alogena Battery operated portable search beam with halogen light



FPHH1
FPHH1
52 53 54

	V 12
	Cd (p) 195.000
H1 12V 55W LR H 55W 12	On 30 min.

FPHH1DNERO12D 76165
FPHH1PNERO12D 76166

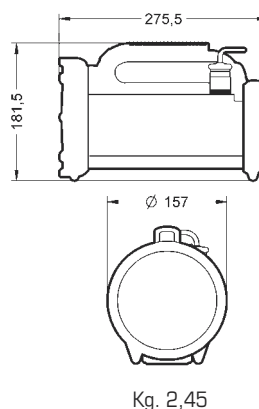

V 12 Tensione di ricarica Recharge voltage	IP 65	°C -30 +50
(Batt. Pb 12V 4500 mAh)	Tempo max. di ricarica Max. recharge time	240 min.

Faro di ricerca autoalimentato portatile con luce alogena e sirena Battery operated portable search beam with halogen light and siren

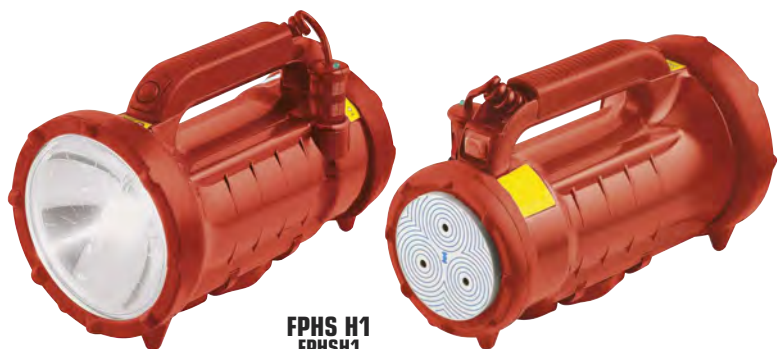

FPSSH1
FPSSH1
52 53 54

	V 12
	Cd (p) 195.000
H1 12V 55W LR H 55W 12	On 30 min.
	V 12
	dB(A)1m 107/110
	Hz 2650/2950

FPSSH1DROSSO12D 76152
FPSSH1PROSSO12D 76153

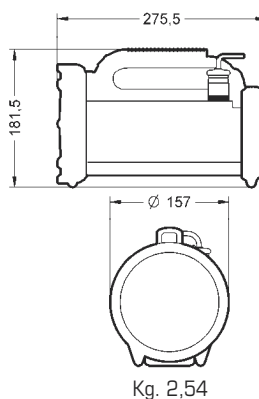

Cinghia per tracolla ad aggancio rapido con chiusura a strozzo in dotazione Quick clip on shoulder strap with blocking closure supplied



BM3ND

BM3ND 72473

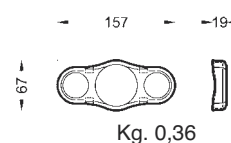

Altri colori disponibili a richiesta. Other colours available on request.