

## UniOP ePAD03 and ePAD04

Compact low-cost HMI with graphic display. The ePAD03 and ePAD04 panels are defining a new standard for entry-level HMI products. They are the ideal replacement for the successful MD00 Series.

### Highlights

- **Monochrome graphic display 120x32 pixels**
- **Downloadable fonts**
- **Scalable text**
- **4 user programmable function keys with slide-in legends**
- **5 user programmable LED indicators**
- **Dual-driver communication**
- **Connection to industrial bus systems and Ethernet with optional modules**
- **IP65 front panel protection**

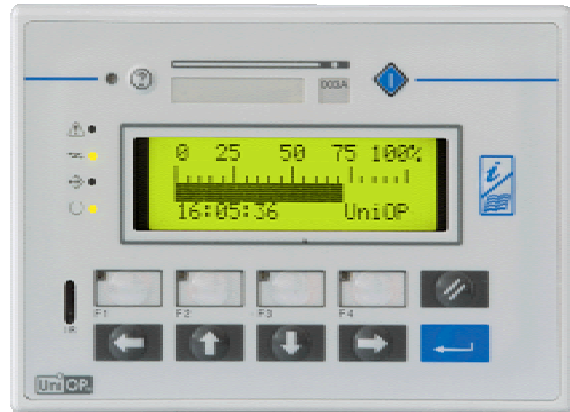

The ePAD03 and ePAD04 HMI panels are compact low cost products yet extremely rich in functionality. The products support the rich common functionality of the UniOP operator panels:

- Powerful and intuitive programming with the UniOP Designer software
- Dual-driver communication capability,
- Scalable fonts for effective presentation of information.
- Support of more than 130 communication drivers for industrial devices
- Optional modules for fieldbus systems (Profibus DP, DeviceNet, CANopen, Interbus) and Ethernet
- Display data in numerical, text and bargraph format
- Dynamic graphic objects
- Recipe data storage
- Keyboard macro editor
- Alarms and historical alarm list
- Eight level password protection

The ePAD03 and ePAD04 are the ideal replacement for panels of the MD00 Series. They generally outperform the equivalent products and can be used in all cases except when the 20 mA current loop interface is needed.

**Technical Data**

|   | ePAD03   | ePAD04   |
|---|--|----------|
| <b>Display</b>                              | Monochrome LCD   |          |
| Backlight                                   | LCD  |          |
| Graphic resolution                          | 120x32   |          |
| Active display area                         | 70x21 mm   |          |
| Rows/columns                                | 4x20   |          |
| Scalable fonts                              | Yes  |          |
| User definable characters                   | 256  |          |
| Contrast regulation                         | Software   |          |
| <b>Memory</b>                               | 512 KB   |          |
| User memory                                 | 512 KB   |          |
| User memory expansion                       | -  |          |
| <b>Front panel</b>                          | 4, with slide-in legend  |          |
| Function keys                               | 4, with slide-in legend  |          |
| System keys                                 | 7  |          |
| Touch screen                                | -  |          |
| User LED's                                  | 5  |          |
| System LED's                                | 4  |          |
| <b>Connections</b>                          | No   |          |
| PC/Printer port                             | No   |          |
| PLC port                                    | RS-232, RS-422, RS-485   |          |
| Aux port (fieldbus and Ethernet connection) | Yes, requires optional module  |          |
| Programming speed                           | 9600 ÷ 38400 bps   | 9600 bps |
| <b>Functionality</b>                        | Unlimited  |          |
| Number of variables per page                | Unlimited  |          |
| Dual-driver capability                      | Yes  | -        |
| Recipe memory                               | 16 KB  | -        |
| UniNet network                              | Server/Client  | Client   |
| Alarms                                      | 1024   | 1024     |
| Event list                                  | 256  | -        |
| Alarm info page                             | Yes  |          |
| Password                                    | Yes, 8 levels  |          |
| Battery                                     | CR2430 (3V 270mA Lithium), non rechargeable, user replaceable. Replace with same type or equivalent compatible with the operating temperature of the product | -        |
| Hardware RTC                                | Yes  | -        |
| Screen saver                                | -  | -        |
| Buzzer                                      | -  | -        |
| Power supply voltage                        | 18 ÷ 30 VDC  |          |
| Max power consumption                       | Overcurrent protection device  |          |
| Fuse  | Overcurrent protection device  |          |

|                                | ePAD03                     | ePAD04 |
|--------------------------------|----------------------------|--------|
| Weight                         |                            |        |
| Operating temperature          | 0 ÷ +50 °C                 |        |
| Storage temperature            | -20 ÷ +70 °C               |        |
| Operating and storage humidity | 5 ÷ 85 % RH non-condensing |        |
| Protection class               | IP65 (front panel)         |        |

The product is designed for installation in industrial environments in compliance with the regulations:

Emitted interference EN 50081-2, 1993  
Noise immunity EN 61000-6-2, 2000

### Front Dimensions and Cutout

|                     |            |             |
|---------------------|------------|-------------|
| Faceplate LxH       | 149x109 mm | 5.86"x4.29" |
| Cutout AxB          | 136x96 mm  | 5.35"x3.78" |
| Cutout depth C      | 53 mm      | 2.08"       |
| Max panel thickness | 5 mm       | 0.19"       |

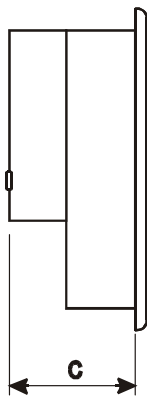
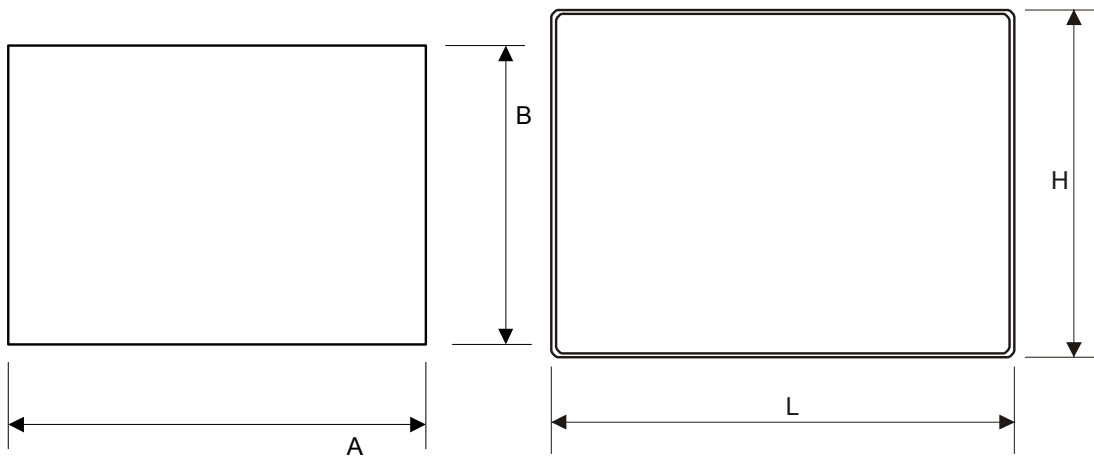

## Connections

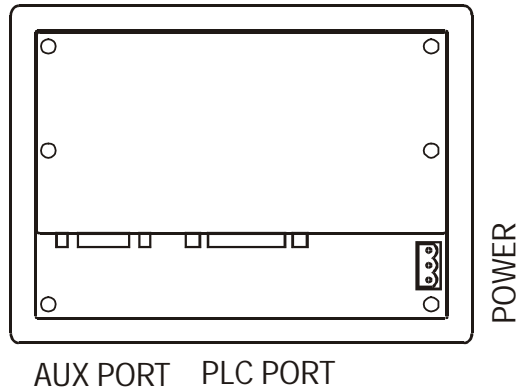

The product is compatible with standard TCM and SCM modules.  
To access the slot for the modules you will have to remove the rear cover of the product

The standard programming cable CA114 can be used with this product if a 15-pin female-female gender changer is used on the PLC Port.

The backup battery in the ePAD03 is accessible for replacement after removing the rear cover.

## Indicators and keypad

There are several dedicated LED indicators on the front panel of the unit. Functionality is described in the table below.

Elements not listed in the table are reserved for future use.

| LED | Color | Status | Meaning   |
|-----|-------|--------|---|
| ⊗   | red   | OFF    | No hardware problem detected  |
|     |       | BLINK  | Battery low   |
|     |       | ON     | Hardware fault  |
|     | green | OFF    | No key pressed and no touch cell active   |
|     |       | ON     | Key pressed or touch cell active (visual feedback)  |
| ○   | green | OFF    | Hardware fault  |
|     |       | ON     | Unit in operation   |
| ↔   | green | BLINK  | Communication error   |
|     |       | ON     | Communication OK  |
| ⚠   | red   | OFF    | No alarms   |
|     |       | BLINK  | Alarm requires acknowledgment   |
|     |       | ON     | Alarm active  |
| ↔   | green |        | May be user controlled as LED number 65 using the Macro Editor. Turns ON when recipe/event backup is being performed. |

The layout of the front panel is shown in the figure below.

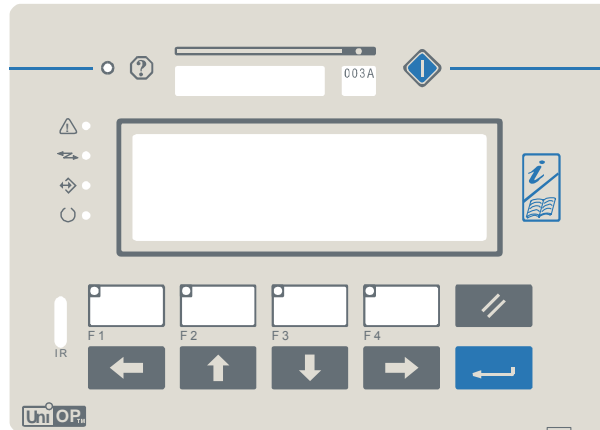



The RDA mapping of LED indicators is shown in the table below.

| RDA Bit | LED on Key |
|---------|------------|
| L1      | F1         |
| L2      | F2         |
| L3      | F3         |
| L4      | F4         |

The RDA mapping of all keys is standard.

The service area at the top of the product includes also two buttons.

| Button  | Description  |
|---|--|
|  | User programmable with the Keyboard Macro Editor. Not available in RDA. Designer 6.01 or higher is required. |
|  | Reserved for future use  |

Function keys F1 to F4 have a slide-in legend. Legend strips in laser printable form are available as accessories.

## Ordering Information

ePAD03-0046  
ePAD04-0046  
R-PRINT2298

Compact low-cost HMI with graphic display and Real Time Clock  
Compact low-cost HMI with graphic display  
Printable legends (5 A4 foils, 8 sets of legend per foil)

---

Tn187

Copyright © 2003 Sitek S.p.A. Italy

Subject to change without notice.

The information contained in this document is provided for informational purposes only. While efforts were made to verify the accuracy of the information contained in this documentation, it is provided “as is” without warranty of any kind.

[www.exor-rd.com](http://www.exor-rd.com)

AUDIN - 8, avenue de la malle - 51370 Saint Brice Courcelles  
Tel : 03.26.04.20.21 - Fax : 03.26.04.28.20 - Web : <http://www.audin.fr> - Email : [info@audin.fr](mailto:info@audin.fr)