

DLC6000

Contact Readers

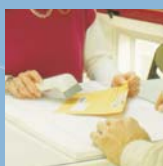

General Description

Datalogic, the main European manufacturer of CCD and laser technology barcode readers, offers a wide range of Hand Held products particularly suitable for Retail applications. In particular, the **DLC6165/90-M** and the **DLC6065/90-M** CCD contact readers fulfill the most common retail and office automation needs, by offering excellent reading performance and reliability with a low price. In fact, these products guarantee the most powerful characteristics on the market for readers in their class, and represent an ideal entry-level solution for Point Of Sale applications.

The **DLC6165/90-M** is based on Enhanced Multi-standard Architecture, which guarantees built-in Data Formatting and Data Editing, features that allow user to shape the collected data according to whatever format is required by the application software. Puzzle Solver™, a decoding technique introduced by Datalogic a few years ago, does not approach the decoding process as a "one scan" confined operation, but is capable of collecting partial data from successive scans and combines it to obtain complete information. Datalogic's offer has been extended with integration of Electronic Article Surveillance (EAS) technology. EAS is a system that helps reduce shoplifting losses, used to identify items as they pass through a gated area by using tags and labels. The **DLC6165-M0-EAS** is provided with an integrated EAS antenna and a dedicated EAS cable for ease of connection and compatibility with EAS Systems, allowing cashiers to scan barcode labels and deactivate EAS tags with one smooth motion.

The **DLC6065/90-M** reading performance, thanks to excellent optics and the Software Focus Level System, is outstanding in terms of reliability on high and low density codes even of poor quality and applied on curved or uneven surfaces. Furthermore, the **DLC6065/90-I** 1 model is specifically dedicated to the IBM 46xx POS cash registers.

Features

- > 65 and 90 mm reading window
- > Advanced decoding Libraries with
- > SFLS (SW Focus Level System)

DLC6065/90-M

- > MULTISTANDARD ARCHITECTURE

DLC6165/90-M

- > ENHANCED MULTISTANDARD ARCHITECTURE
- > **PUZZLE SOLVER™** decoding system
- > Complete data formatting and data editing

Applications

- > Data collection in commercial and office automation environments
- > Data collection in light industrial environments

Specifications

ELECTRICAL CHARACTERISTICS

POWER SUPPLY +5 VDC \pm 5%
Directly from the terminal or PC in wedge and pen mode, or via an external PG5 power supply in RS232 mode

CONSUMPTION 150 mA max.

MECHANICAL CHARACTERISTICS

DIMENSIONS 164 x 77.5 x 63 mm (DLC6165-M)
175 x 100 x 80 mm (DLC6190-M)

WEIGHT (approx.) 160 g (DLC6165-M)
195 g (DLC6190-M)

CASE MATERIAL ABS

CABLE LENGTH 2 m (6.6 ft) linear

PERFORMANCE

LIGHT SOURCE Visible red LED

MAX. RESOLUTION 0.1 mm (DLC6X65)
0.13 mm (DLC6X90)

SCAN RATE 100 scans/sec

PRINT CONTRAST RATIO 15% (min)

READING FIELD 65 mm (DLC6X65)
88 mm (DLC6X90)

READING DISTANCE 0 to 50 mm on EAN 13 code MAG1

READABLE BAR CODES 2/5 family, Code 39, Code 32, Code CIP 39, Code 128, EAN128, EAN/UPC, ISBN/ISSN, CODABAR, Code 93 ISBT128, MSI, Plessey, Telepen, Delta IBM, Code 11, CODABLOCK, Code 49, Code 16K

DLC6165/90 only

READING INDICATORS LED and adjustable tone "beeper"
READING MODE Single or autodiscrimination code

PROGRAMMING METHOD

Manual

Automatic (with RS232)

Sm@rtSet

INTERFACES

DLC6165/90 model only

DLC6065/90 I1

ENVIRONMENT

AMBIENT LIGHT CONDITIONS 30,000 lux max. (contact with code surface)

OPERATING TEMPERATURE 0 to 55 °C

STORAGE TEMPERATURE -20 to 70 °C

HUMIDITY 90% non condensing

DROP RESISTANCE IEC 68-2-32 Test ED

ENVIRONMENTAL PROTECTION IP30

Connections

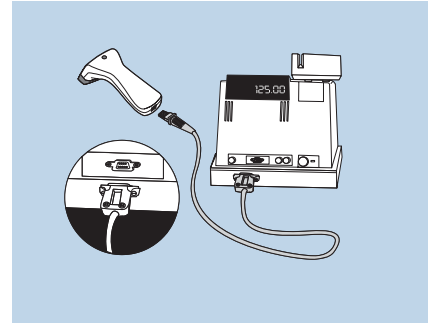

Pen Emulation

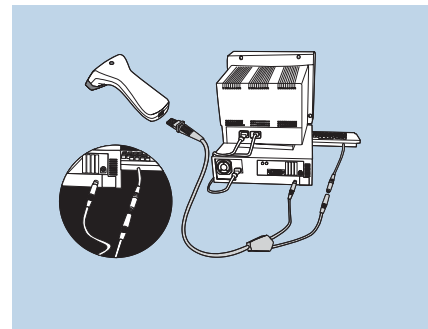

Wedge Emulation

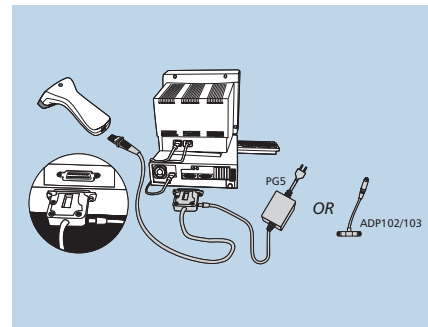

RS232

AUDIN Composants & systèmes d'automatisme

7 bis rue de Tinquieux 51100 REIMS - France

Tel. 03 26 04 20 21 • Fax 03 26 04 28 20 • <http://www.audin.fr> • E-mail info@audin.fr



Product and Company names and logos referenced may be either trademarks or registered trademarks of their respective companies.
We reserve the right to make modifications and improvements.

